

Ferrari

250 GTO



Pack 05

BUILD INSTRUCTIONS

STAGE 31: THE RIGHT FRONT WHEEL (1)

STAGE 32: THE RIGHT FRONT WHEEL (2)

STAGE 33: THE RIGHT FRONT WHEEL (3)

STAGE 34: THE RIGHT FRONT WHEEL (4)

STAGE 35: OIL RESERVOIR, FILTERS AND PUMP

STAGE 36: SPARK PLUG LEADS

STAGE 37: THE TIMING CHEST (1)

STAGE 38: THE TIMING CHEST (2)

STAGE 39: THE TIMING CHEST (3)

STAGE 40: THE DYNAMO

Advice from the experts

To help you get the best out of building the Ferrari 250 GTO, we've prepared a modellers checklist with hints, tips and advice from our experts. The information below is aimed at making your build as enjoyable and professional as possible right from the start.

Have a soft cloth ready to place on your work surface to prevent scratching the paintwork.

Spare screws are included with each part. Occasionally, you may be instructed to keep spare or unused screws for a later stage. Keep these spares in a safe place and label them correctly.

Please make sure you don't mix up the screws. They look quite similar, but the threads do vary slightly. Using the wrong screws may damage the parts.

When securing parts together using multiple screws, fit each screw loosely to ensure all the parts are correctly aligned before gently tightening them firmly, but not overtight, in the order in which you placed them.

The screwdriver can be magnetized by stroking it with a magnet (fridge magnet, etc.) enabling it to hold the screws and make assembly easier.

If a screw is tight going into a metal part, do not force it as you may shear the head off. Remove it and put a tiny smear of Vaseline, soap or light oil on the thread. That will lubricate it and make it easier to drive home.

Only use the correct size screwdriver that fits the screw head firmly.

Use a magnet to help find screws that have fallen on the floor.

Use masking tape to hold parts temporarily in place.

Cut parts from a sprue (framework) with side cutters or a craft knife. Side cutters tend to be easiest.

During the course of this build, you will receive many pieces that you will assemble immediately – following the instructions in the corresponding stage – and other pieces that you should store safely to one side, for use in future assembly stages.

Left and Right! When building your *Ferrari 250 GTO*, the left- or right-hand side refers to that side as if you are sitting in the car.



WARNING: Some parts are assembled using magnets. These magnets can cause serious injury if they are swallowed. Keep away from children. If you suspect a magnet has been swallowed, seek medical help straight away.

All parts belong to a kit. Collectors item for adults.

Not suitable for children under 14.

Produced under license of Ferrari S.p.A. The name FERRARI, the PRANCING HORSE device, all associated logos and distinctive designs are property of FERRARI S.p.A. The body designs of the Ferrari cars are protected as Ferrari S.p.A. property under design, trademark and trade dress regulations.

Stage 31: The Right Front Wheel (1)

In this stage you'll start assembling your model's right front wheel. You'll continue assembling it over the coming stages.



STAGE 31 PARTS LIST

Name	Name
1 Inner wheel rim	5 Type A hub
2 Spoke retainer ring 1	6 Type A spokes
3 Type B hub	7 Type B spokes
4 Type C hub	

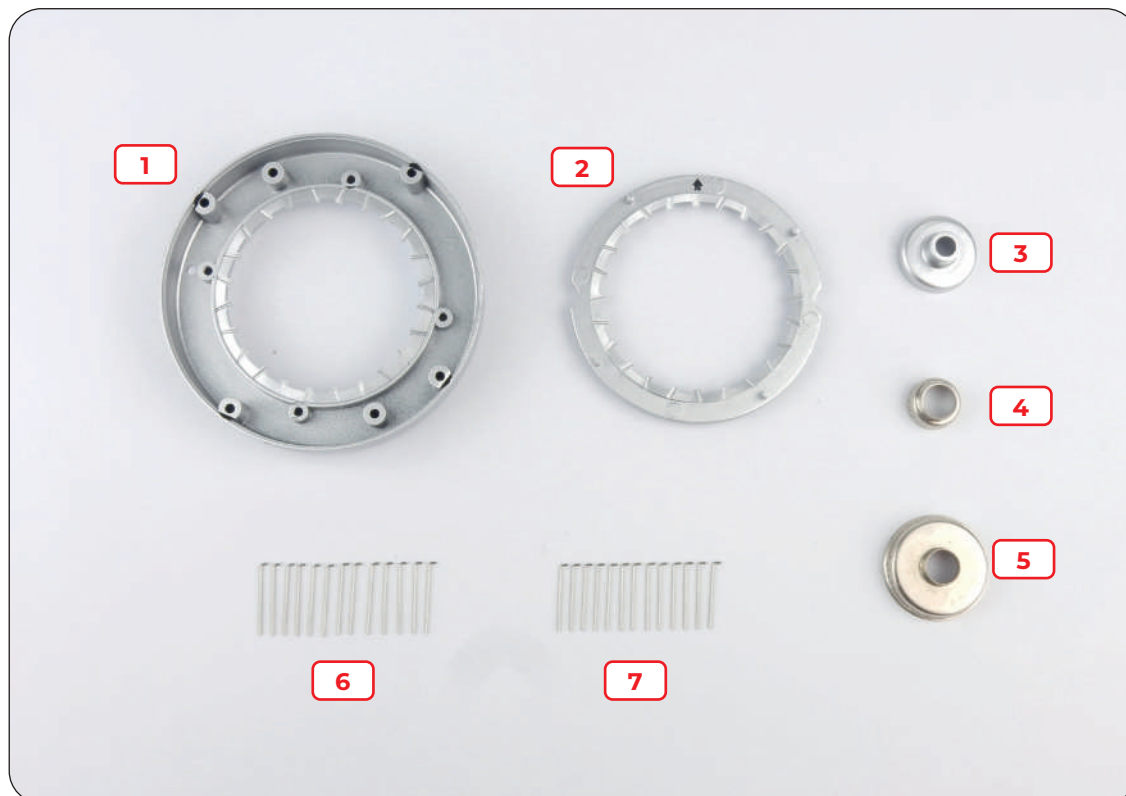

Stage 31: The Right Front Wheel (1)

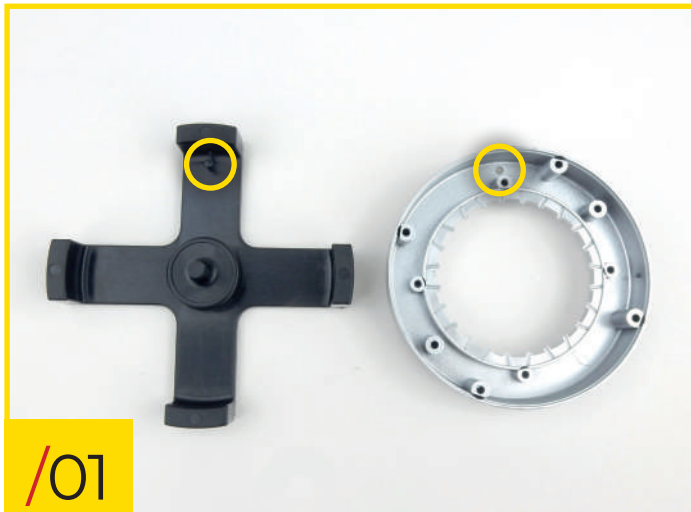

31/01 Place the jig you received in stage 21 on your work surface, along with the wheel rim supplied with this stage. The jig has a small fixing stud on it, which should be inserted into the corresponding hole in the rim.

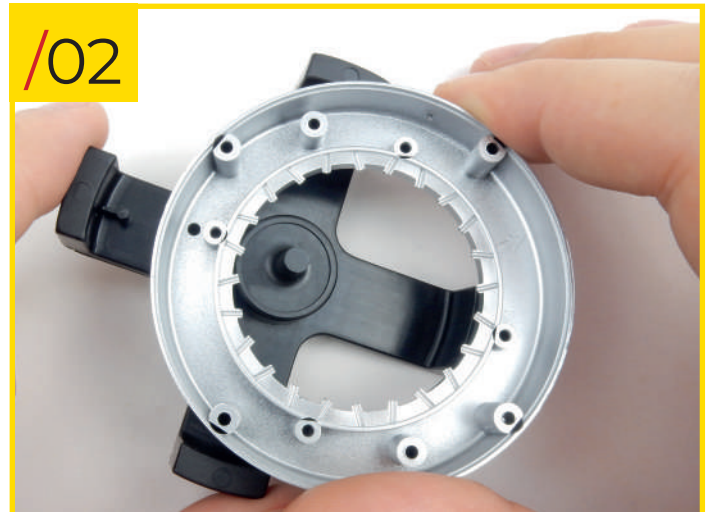

31/02 Insert the stud into the hole to fix the rim onto the jig. Before proceeding with the assembly, we recommend that you stick a small piece of double-sided sticky tape to the template's central stud - this will help to hold the hubs in place. Alternatively, you can lay all the spokes in position and then dab a bead of glue on each one after stage 31/08.

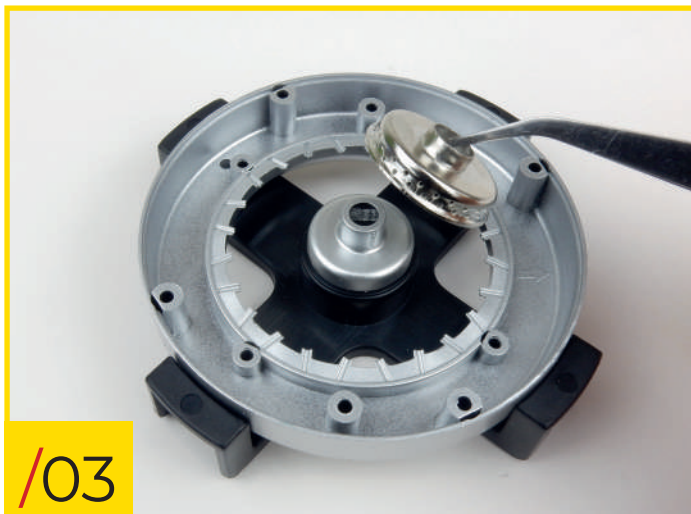

31/03 Place the type B hub onto the jig's central stud; once in place, place the type A hub on top of it, as shown in the photo.



31/04 Before adding the spokes, we recommend that you stick some small strips of double-sided sticky tape to the internal edge of the rim. This will help to hold the spokes in place during the assembly. Alternatively, you can dab a bead of glue onto each spoke once they are in position.

Stage 31: The Right Front Wheel (1)

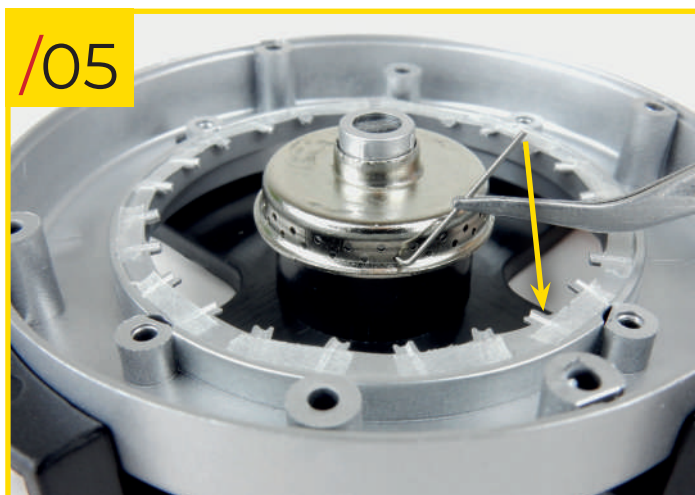

/05

31/05 Install the type B spokes (they are shorter than the type A ones) by inserting their hooked end into the lower row of holes in the type A hub. Place the straight end of the spokes onto the corresponding notch on the edge of the rim (on the double-sided sticky tape). Always leave an empty hole between each spoke.

31/06 Look at the photo to check that you've correctly installed the type B spokes.

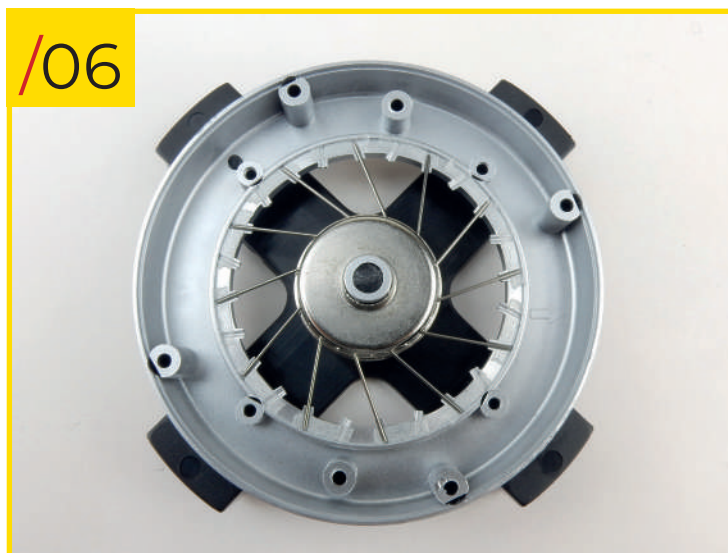

/06



/07

31/07 Now install the type A spokes (they are longer than the type B ones) by inserting their hooked end into the upper row of holes immediately to the left of the type B spokes, making sure they pass over the spokes inserted into the lower row of holes. Use the photo to help identify which notch you should position the other end of the spoke on. Always leave an empty hole between each spoke.

Stage 31: The Right Front Wheel (1)



31/08 Look at the photo to check that you've installed all the spokes correctly.

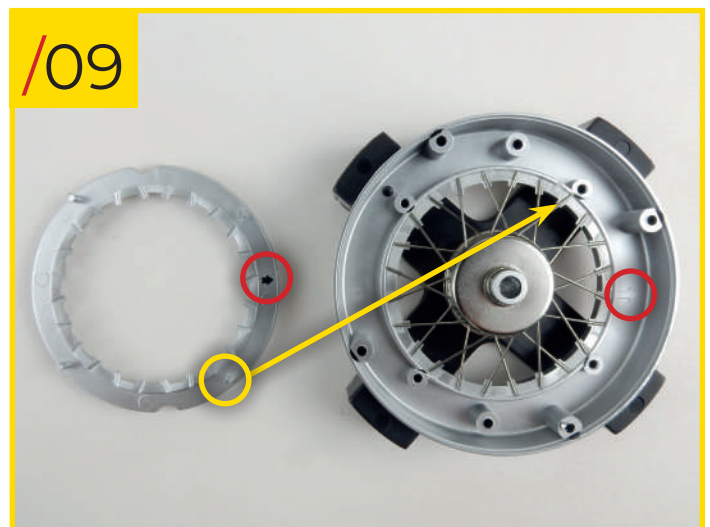

31/09 Finally, fit the spoke retainer ring 1 onto the internal edge of the rim. Use the photo and the arrows printed on the pieces to fit them together correctly.

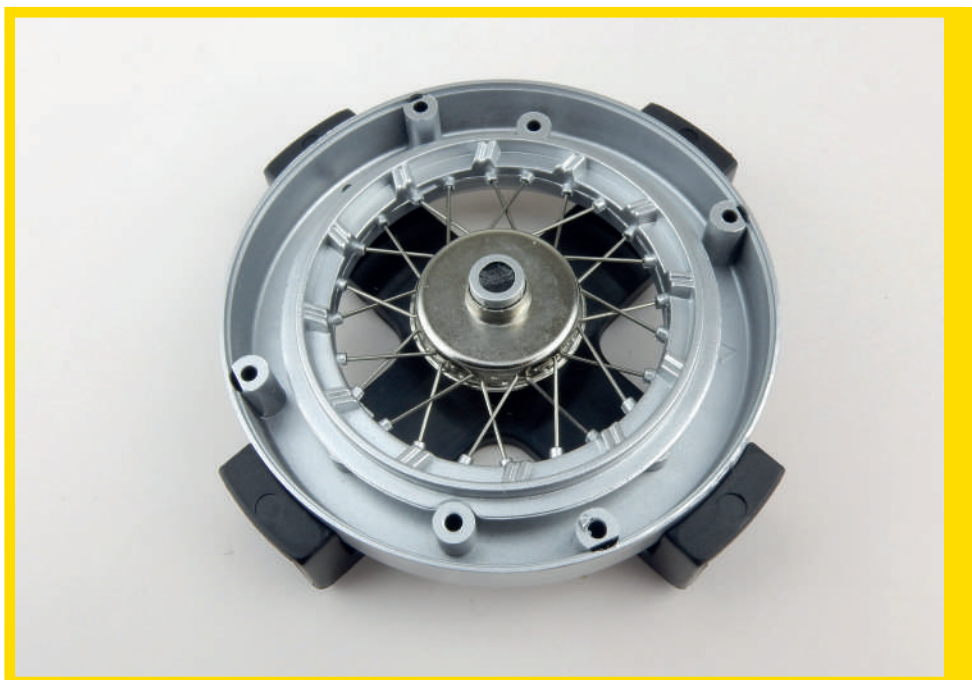

STAGE 31 IS COMPLETE
Here's how the right front wheel looks at the end of this assembly phase. Keep it in a safe place.

Stage 32: The Right Front Wheel (2)

In this stage you'll continue assembling your model's right front wheel.



STAGE 32 PARTS LIST

Name	Name
1 Spoke retainer ring 2	3 type B screws
2 Type A spokes	

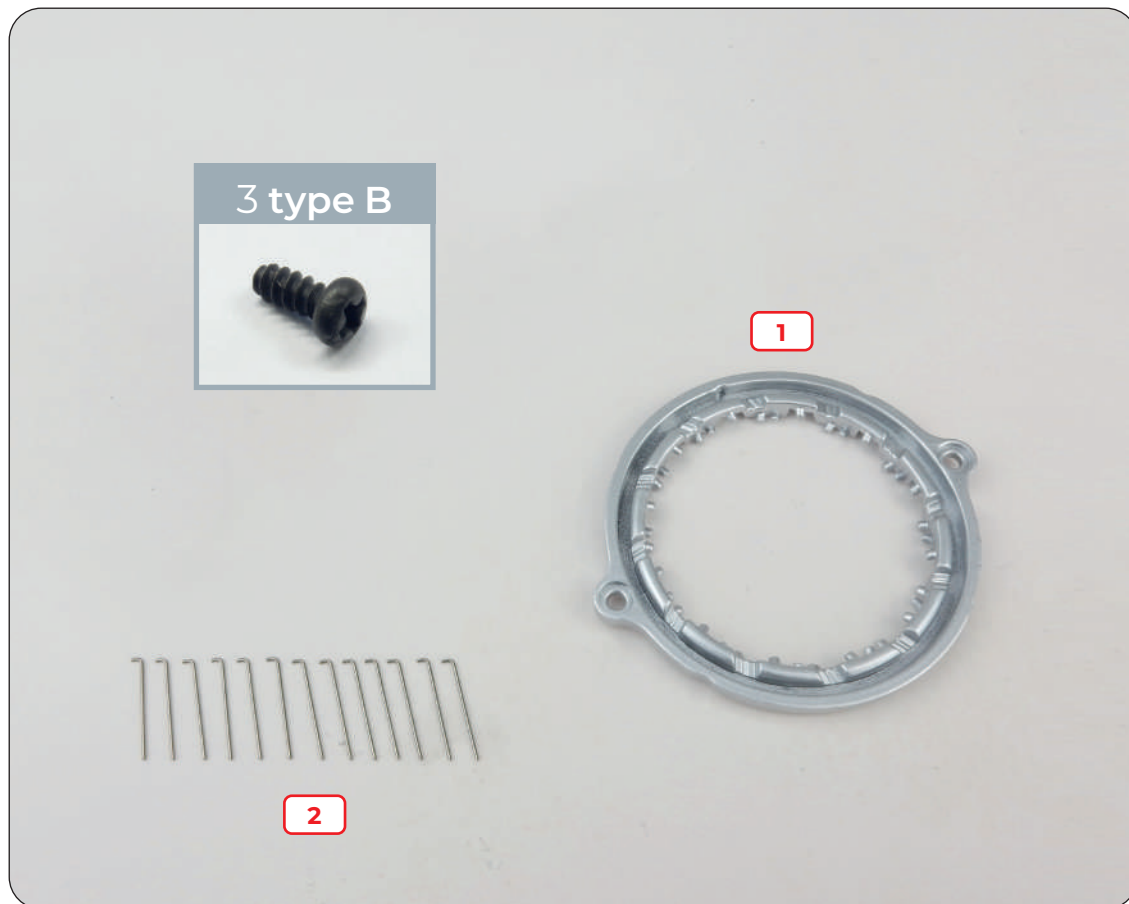

Stage 32: The Right Front Wheel (2)



/01

32/01 Place the right front wheel that you assembled in stage 31 on your work surface. Before proceeding, we recommend that you stick small strips of double-sided sticky tape to the side edge of the spoke retainer ring 1. Alternatively, you can lay all the spokes in position and then dab a bead of glue on each one after stage 32/03.

32/02 Insert the hooked end of the type A spokes you received with this stage into the holes remaining in the lower row on the hub. Place the straight end of the spokes onto the corresponding notch (on the double-sided sticky tape) on the edge of the spoke retainer ring 1. Use the photo to help orientate the spokes correctly.



/02



/03

32/03 Look at the photo to check that you've correctly installed the type A spokes.

Stage 32: The Right Front Wheel (2)

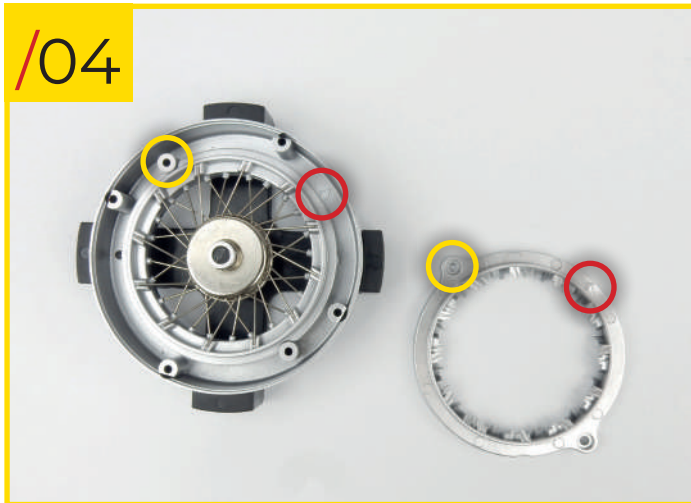

32/04 Add the spoke retainer ring 2 to the rest of the assembly. Use the photo to help fit it correctly.

32/05 Secure the pieces together using two type B screws.

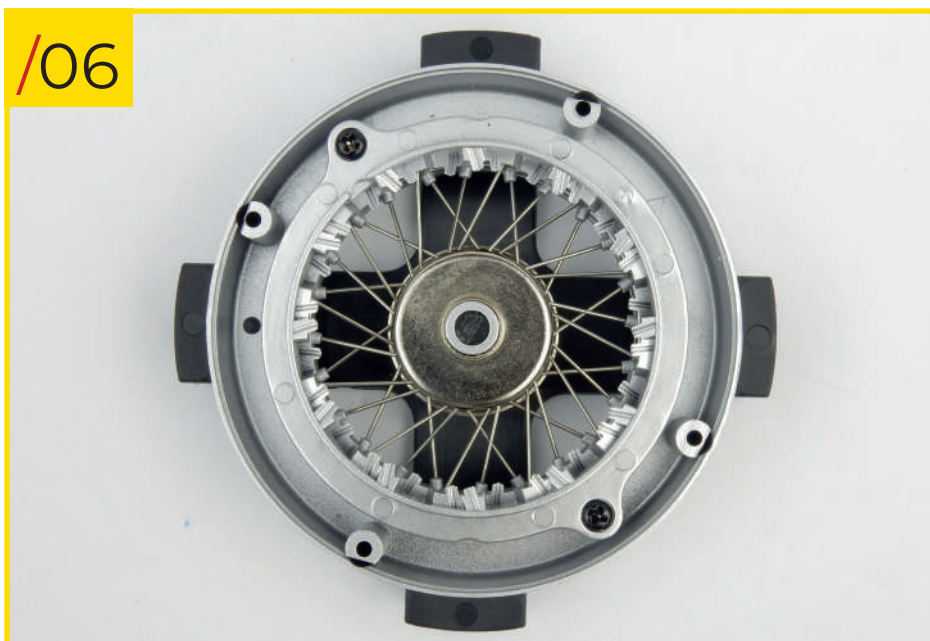

32/06 Look at the photo to check that you've installed all the components correctly.

Stage 32: The Right Front Wheel (2)



STAGE 32 IS COMPLETE
The right front wheel is almost complete. Keep it somewhere safe together with the other pieces.

Stage 33: The Right Front Wheel (3)

In this stage you'll continue assembling your model's right front wheel. You will then complete it in the following stage.



STAGE 33 PARTS LIST

Name	Name
1 Outer wheel rim	7 type B screws
2 Sealing ring	
3 Washer	
4 Type A spokes	
5 Type C spokes	

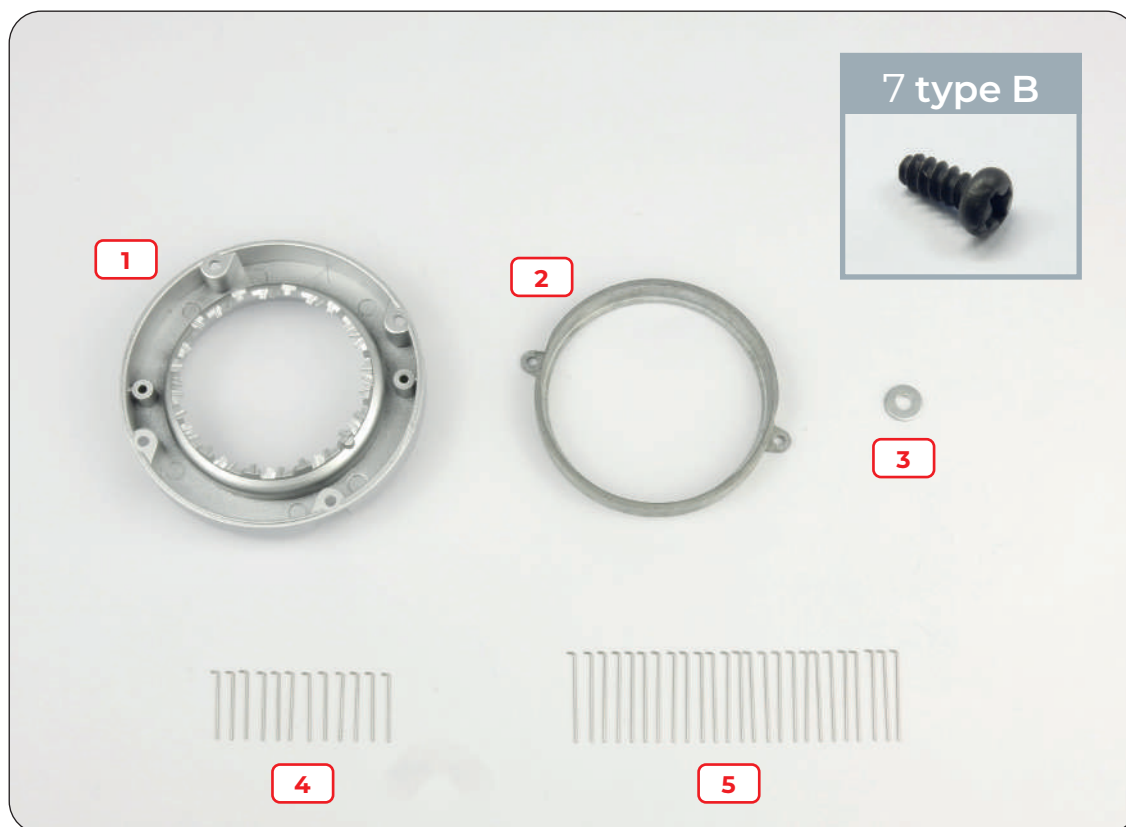

Stage 33: The Right Front Wheel (3)

/01

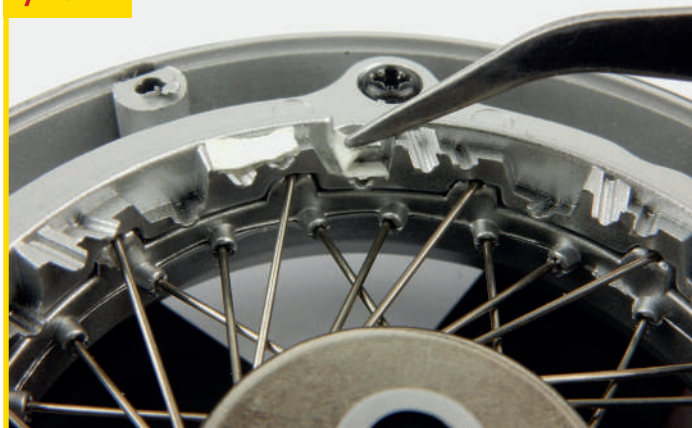

33/01 Place the right front wheel that you assembled in the previous stages on your work surface. Before proceeding with the assembly, we recommend that you stick small strips of double-sided sticky tape to the side edge of the spoke housing 2.

/02



33/02 Insert the hooked end of the type A spokes you received with this stage into the remaining holes in the type A hub. Use the photo to help orientate the spokes correctly. Put their straight end on the corresponding notch on the top level of the housing.



33/03 Once all the type A spokes have been added, position the type C hub that you received with stage 31 as shown in the photo.

/03

/04



33/04 Insert the hooked end of one type C spoke into one of the holes in the lower row on the type C hub.

Stage 33: The Right Front Wheel (3)



33/05 Use the photo to help put the straight end of the spoke on the notch on the lower level of the housing. Repeat these steps for the other eleven type C spokes, until all the holes in the lower row on the hub have been filled.



33/06 Now insert the hooked end of one type C spoke into one of the holes in the top row on the type C hub.



33/07 Place the straight end of the spoke onto the corresponding notch on the top level of the housing. Repeat these steps for the other eleven type C spokes, until all the holes in the top row on the hub have been filled.

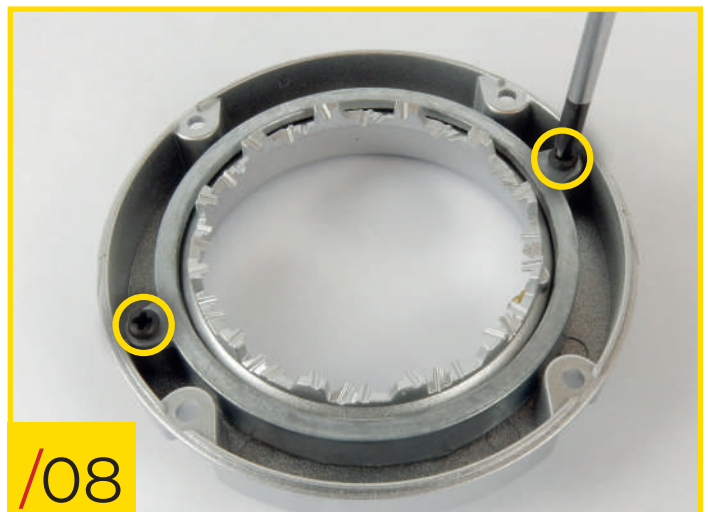

33/08 Fix the sealing ring to the inner edge of the outer wheel rim. Orientate the pieces as shown and secure them together using two type B screws.

Stage 33: The Right Front Wheel (3)

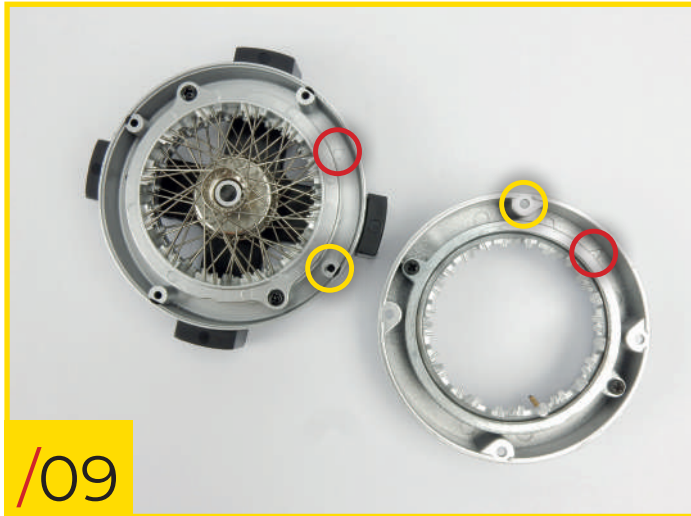

33/09 Fit the outer wheel rim to the rest of the wheel. To line up the fixing holes, look at the photo and match up the circled fittings.

33/10 Secure the rim to the rest of the wheel using four type B screws.



STAGE 33 IS COMPLETE
Here's how the right front wheel of your model looks at the end of this assembly phase.

Stage 34: The Right Front Wheel (4)

In this stage you'll finish assembling the right front wheel by adding the tyre.



STAGE 34 PARTS LIST

Name
1 Tyre



Stage 34: The Right Front Wheel (4)

/01

34/01 Place the right front wheel and the washer you received with stage 33 on your work surface. Remove the protective film from one of the sides of the washer, as shown in the round photo.

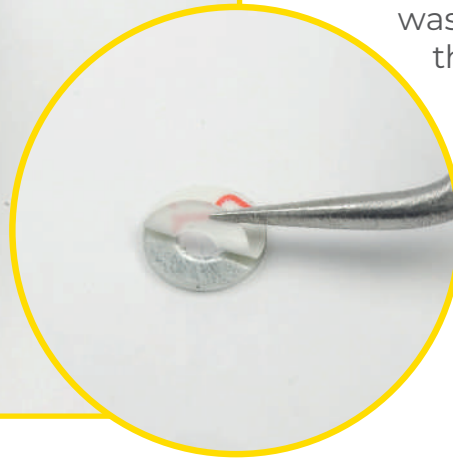

34/02 With the side of the washer that had the film removed facing downwards, insert it into the type C hub, as shown in the photo.

/02



/03



34/03 Look at the photo to check that you've positioned the washer correctly.

Stage 34: The Right Front Wheel (4)



34/04 Before adding the tyre to the rest of the wheel, we recommend that you warm it up slightly (using a hair dryer, for example) to make it more malleable.



34/05 Check to make sure that the tyre is malleable enough.



34/06 Slip the tyre onto the rim of the right front wheel.

Stage 34: The Right Front Wheel (4)



STAGE 34 IS COMPLETE
You have now finished
assembling your model's
right front wheel. Keep it
somewhere safe together
with the other pieces.

Stage 35: Oil Reservoir, Filters and Pump

In this stage you'll assemble the oil reservoir and oil pump then fit them to your model with the related filters.



STAGE 35 PARTS LIST

Name	Name
1 Reservoir	6 Oil pump base
2 Reservoir cover	7 Hoses
3 Pump	8 Filters
4 Support	4 type B screws
5 Fittings	2 type D screws



Stage 35: Oil Reservoir, Filters and Pump

/01

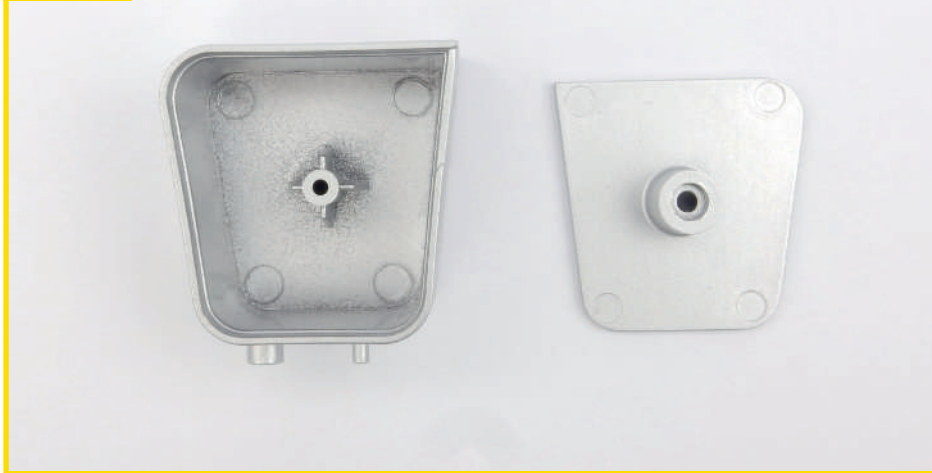

35/01 Place the reservoir and its cover on your work surface.

35/02 Place the cover on the reservoir.



/02

/03



35/03 Screw a type B screw into the hole indicated to secure the pieces together.

Stage 35: Oil Reservoir, Filters and Pump

/04

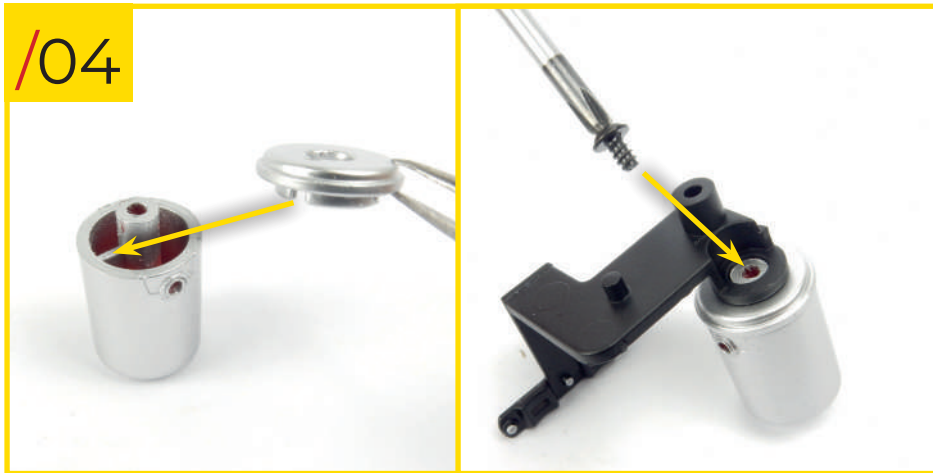

35/04 Fit the oil pump base to the pump. Then secure the pump to the support with a type D screw.

35/05 From the sprue, detach one fitting with two studs and two fittings with one stud (the remaining fitting is a spare). Attach the two pipes to the fitting studs to connect them together. Fit the components together exactly as shown in the photo.

/05



/06



35/06 Fit the two filters to the pump support and insert the fittings into the holes in the components, as shown in the photo.

Stage 35: Oil Reservoir, Filters and Pump

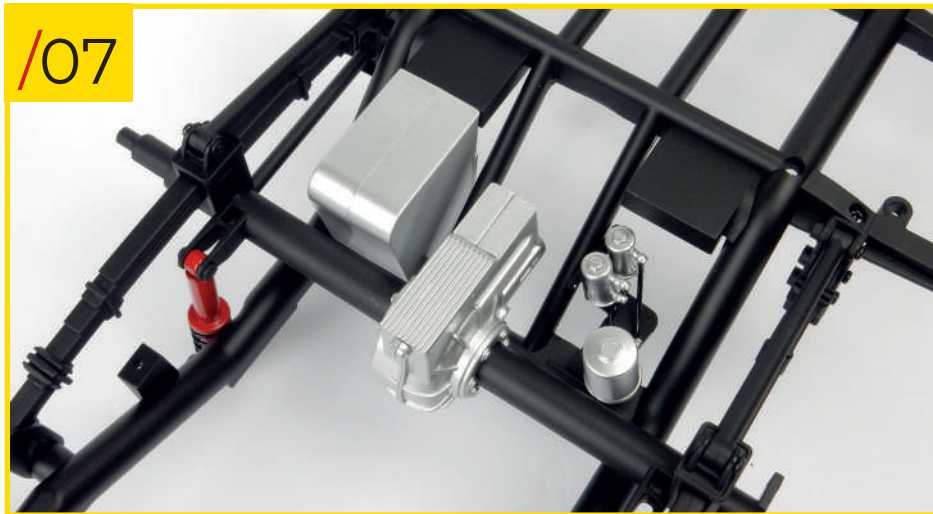

35/07 Fit the reservoir and pump assembly onto the model's chassis, into the positions shown in the photo.

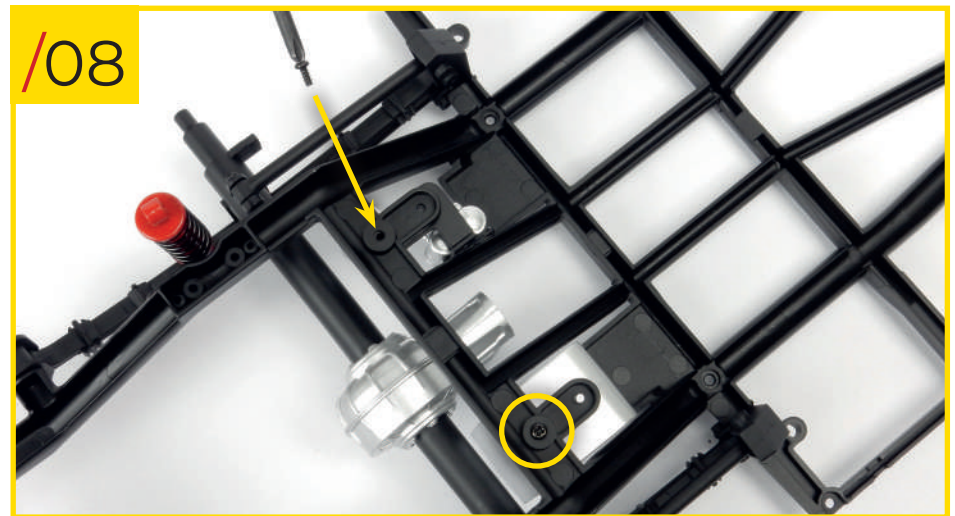

35/08 Secure the components to the chassis with two type B screws.

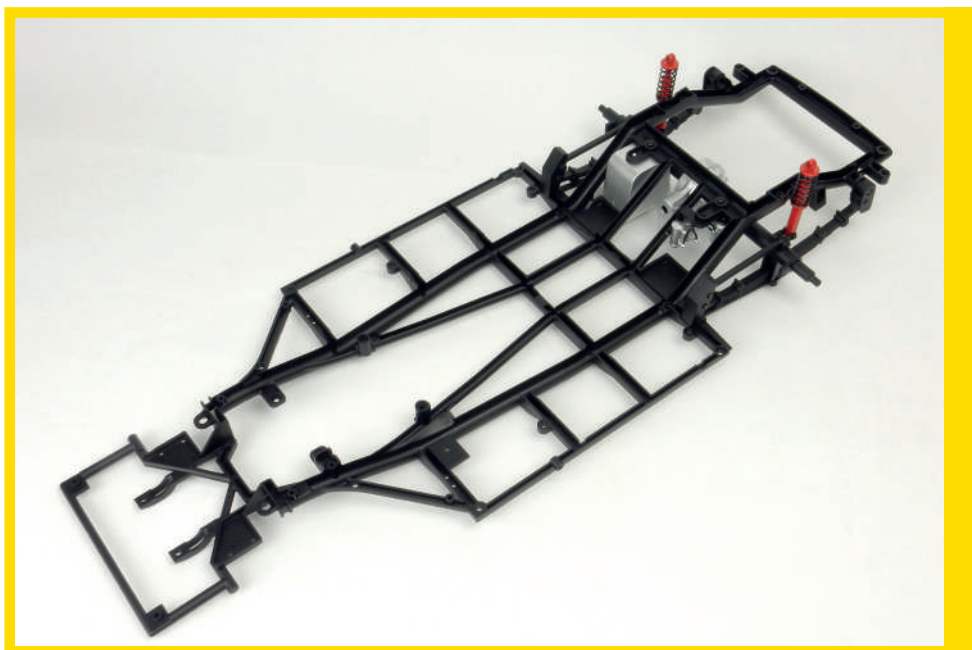

STAGE 35 IS COMPLETE
Here's how your model's chassis looks at the end of this assembly phase.

Stage 36: Spark Plug Leads

In this stage you'll start fitting the spark plug leads to your model's left cylinder head. You'll fit the components to the right side during the next assembly session.



STAGE 36 PARTS LIST

Name
1 Lead connector - left cylinder head
2 Lead connector - right cylinder head
3 Short leads
4 Long leads

Check the photo carefully and place the lead connectors on your work surface as shown to help tell the left from the right.

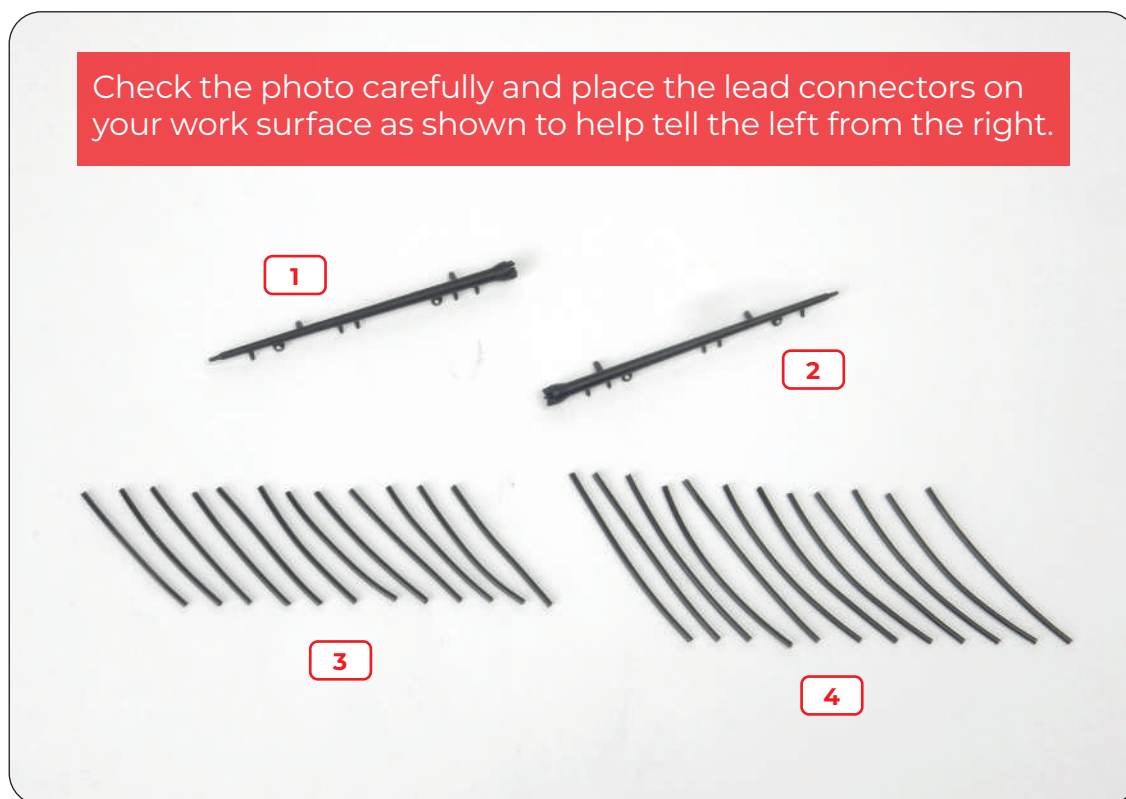

Stage 36: Spark Plug Leads

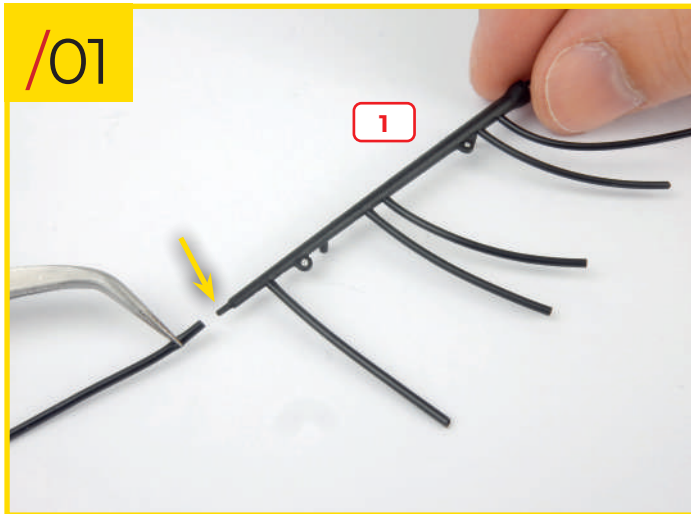

36/01 Place the lead connector for the left cylinder head (part 1) and six short leads on your work surface. Using a pair of tweezers, slide one end of each lead onto the small studs on the lead connector (five running along the side and one on the end). You can use a cocktail stick to widen the holes in the leads if needed.

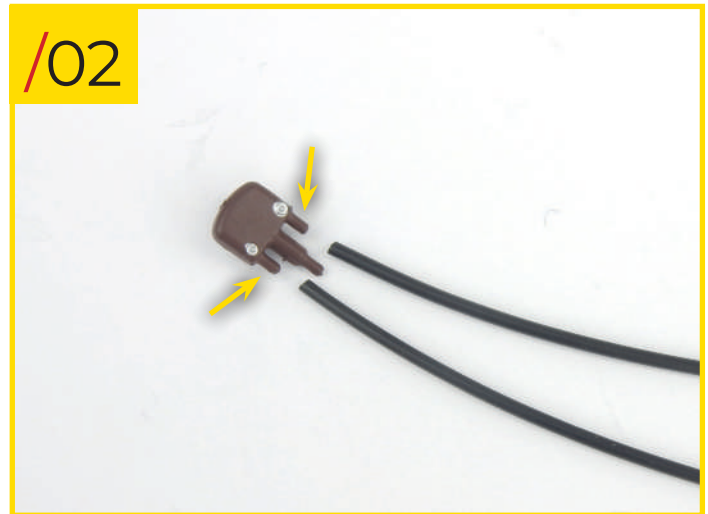

36/02 Retrieve one of the distributor cap connectors you received with stage 19. Slide two long leads onto the two side studs on the connector.

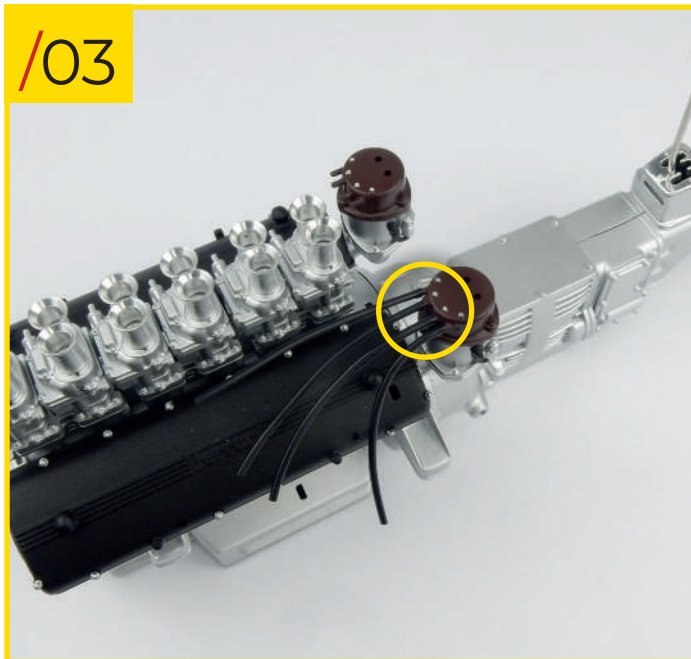

36/03 Retrieve the engine assembly and slide four long leads onto the studs on the left distributor cap.

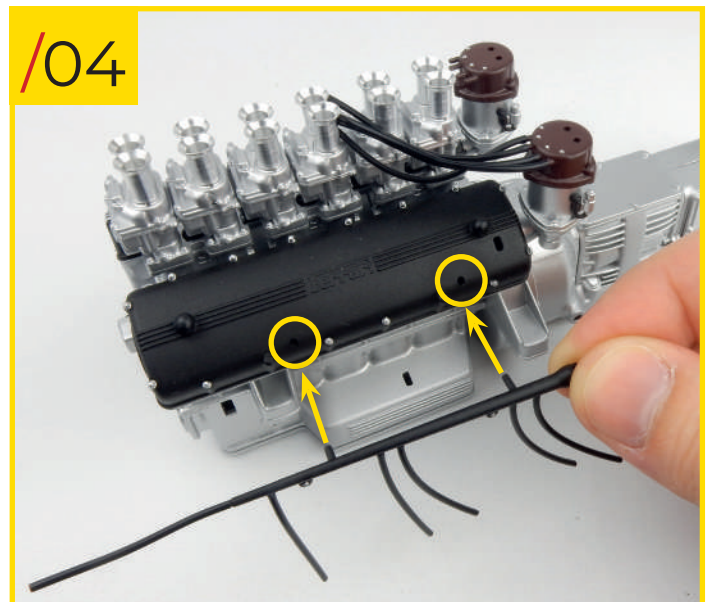

36/04 Fit the lead connector onto the left cylinder head by inserting the two unused studs into the available holes.

Stage 36: Spark Plug Leads

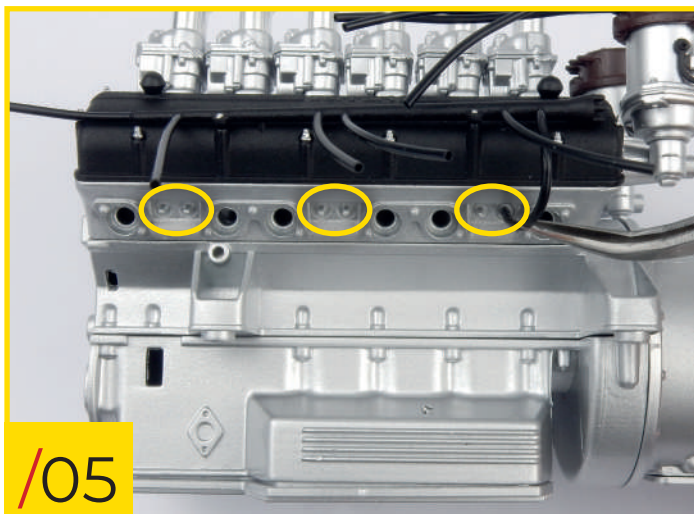

36/05 Using a pair of tweezers, slide the other ends of the short leads onto the studs on the engine block, as indicated in the photo. You can use a cocktail stick to widen the holes in the leads if needed.

36/06 Slide the four long leads coming from the distributor cap onto the studs on the end of the lead connector, as indicated in the photo. So as not to encounter any difficulties, we recommend that you follow the order shown in the two circled images.

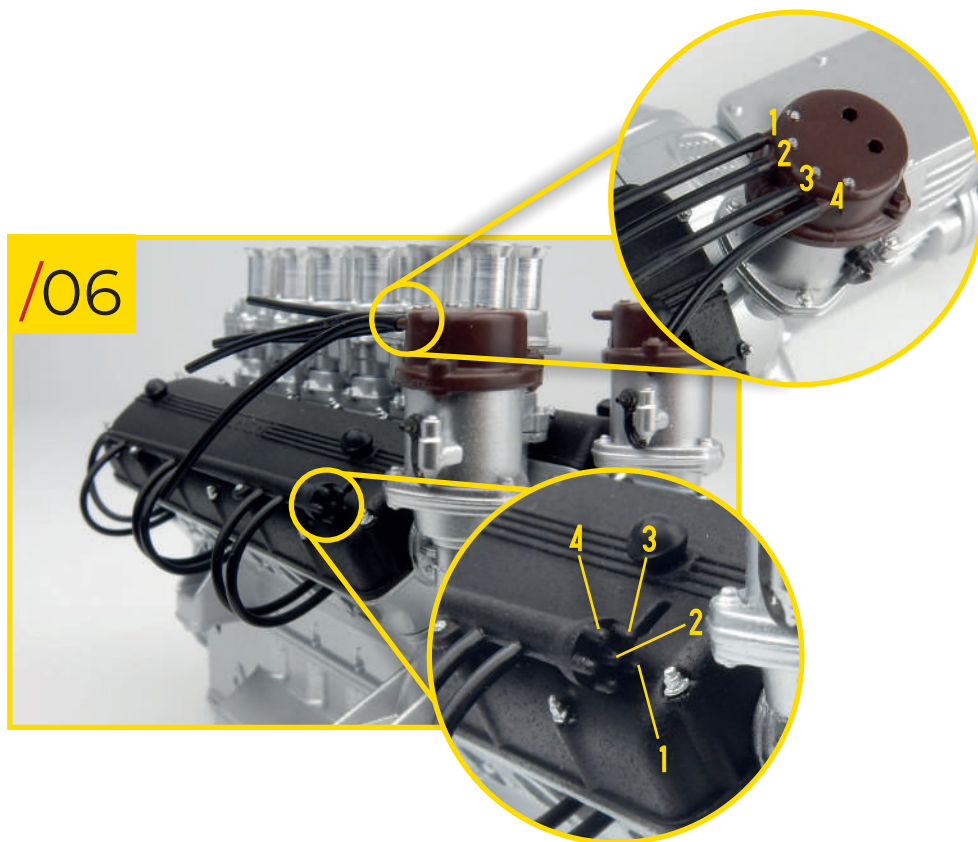

Stage 36: Spark Plug Leads

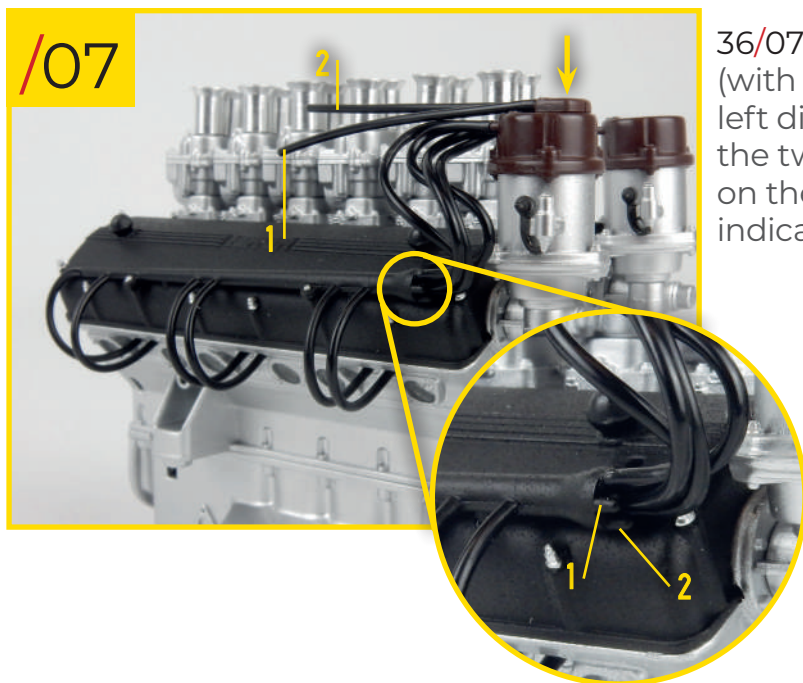

36/07 Connect the distributor cap connector (with its two leads added in step 2) to the left distributor cap. Slide the other ends of the two leads onto the remaining two studs on the lead connector, following the order indicated in the photo.

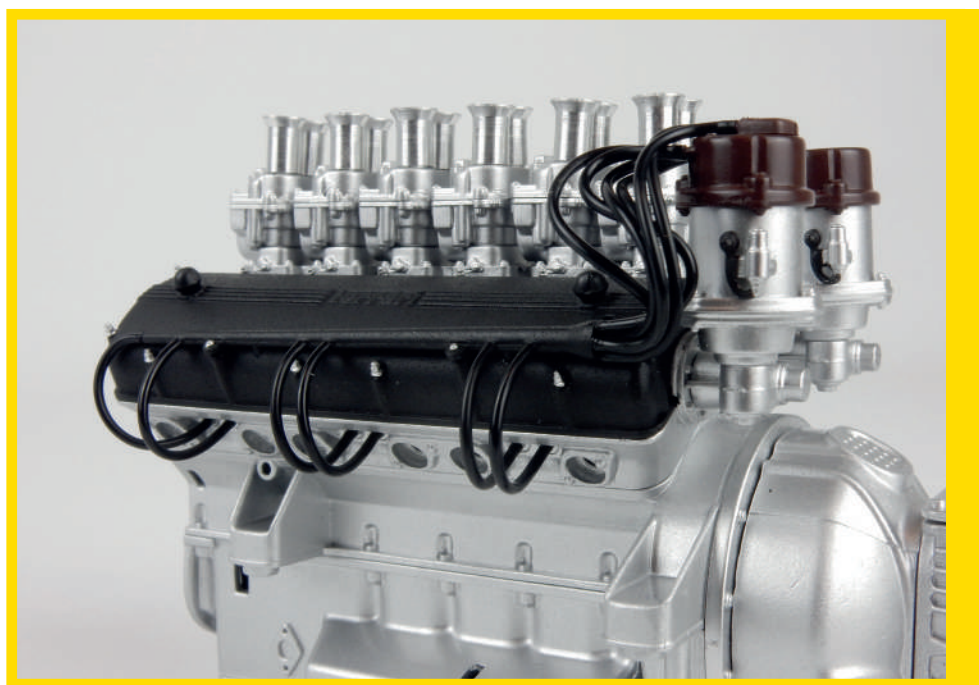

STAGE 36 IS COMPLETE
Here's how your model's engine looks after the left spark plug leads have been fitted. Keep the components you've not used during this session in a safe place, you'll need these for a later stage.

Stage 37: The Timing Chest (1)

In this stage you'll fit the spark plug leads for the right cylinder head and start assembling the timing chest.



STAGE 37 PARTS LIST

Name
1 Timing chest
2 Triangular protective plate
3 Gasket
4 Mount

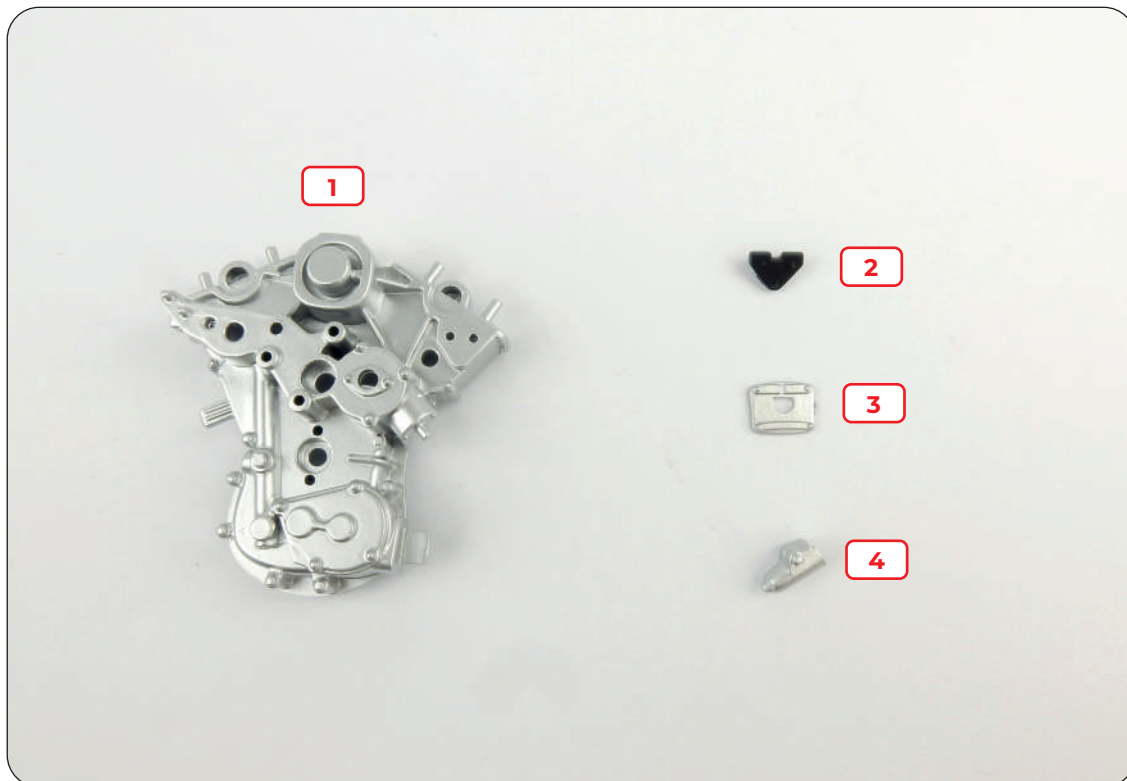

Stage 37: The Timing Chest (1)



37/01 Place the lead connector for the right cylinder head (part 2) and six short leads, all of which you received with stage 36, on your work surface. Slide one end of each lead onto the small studs on the lead connector in the same way as before.



37/02 Retrieve the second distributor cap connector you received with stage 19. Slide two long leads (stage 36) onto the two side studs on the connector.

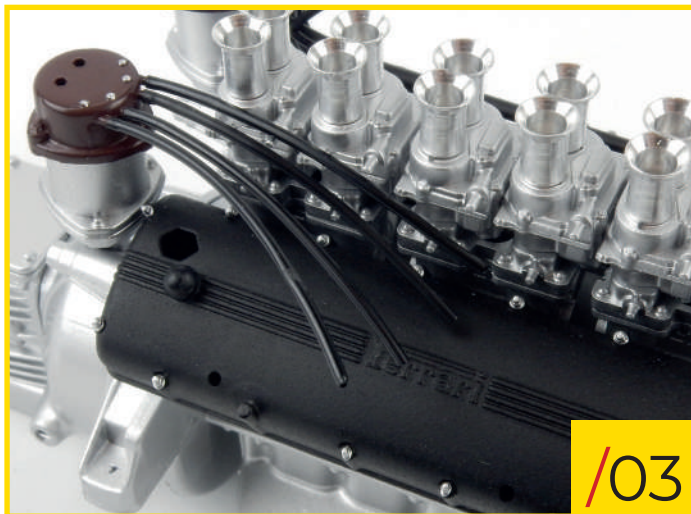

37/03 Retrieve the engine assembly and slide the other four long leads (stage 36) onto the studs on the right distributor cap.

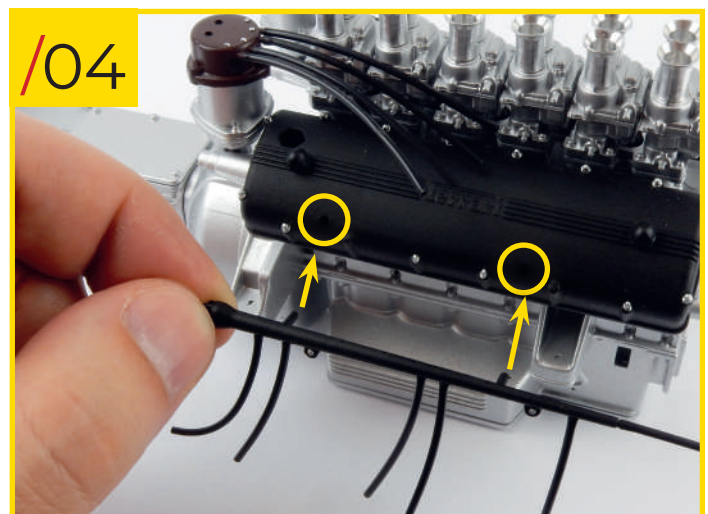

37/04 Fit the lead connector onto the right cylinder head by inserting the two unused studs into the indicated holes.

Stage 37: The Timing Chest (1)

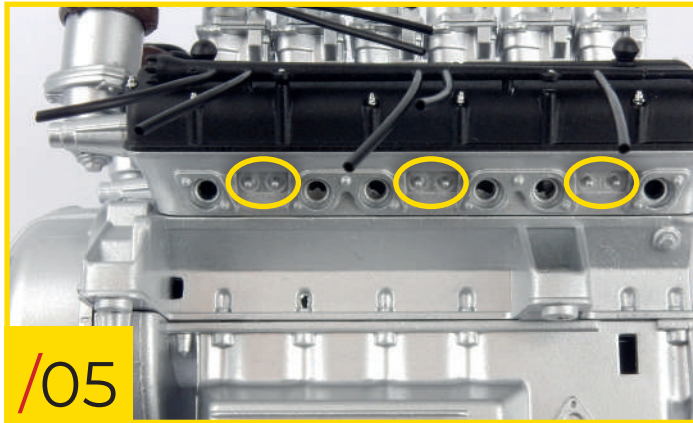

37/05 Using a pair of tweezers, slide the other ends of the short leads onto the studs on the engine block, as indicated in the photo.

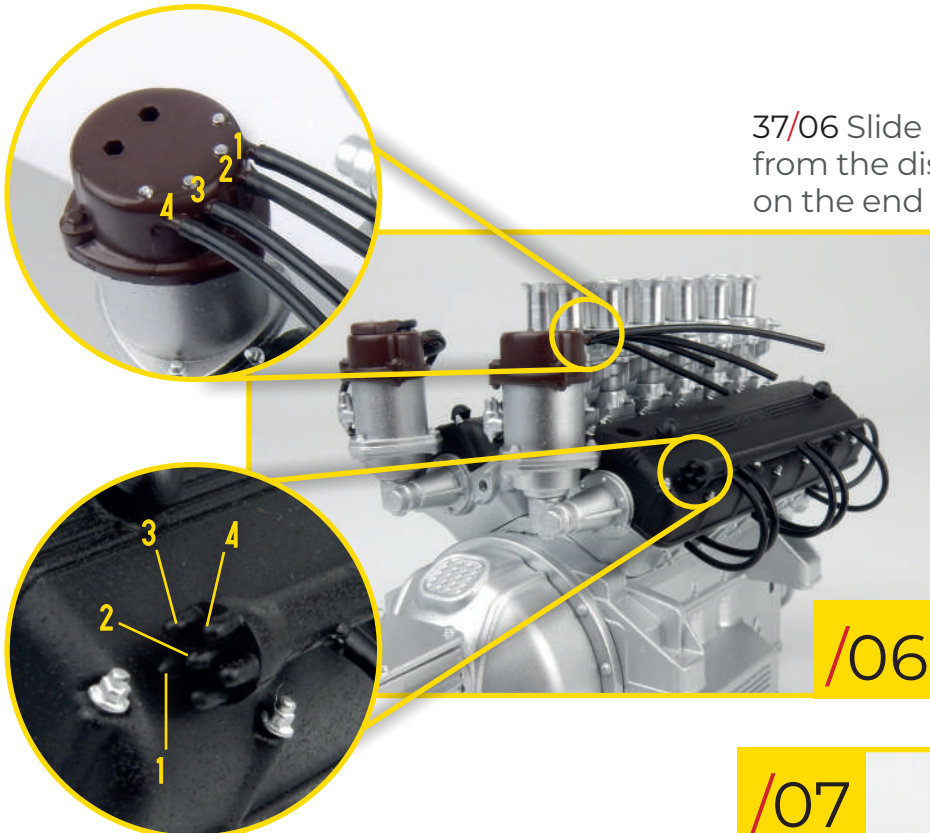

37/06 Slide the four long leads coming from the distributor cap onto the studs on the end of the lead connector, as indicated in the photo. To avoid any difficulties, we recommend that you follow the order shown in the two circled images.

37/07 Connect the distributor cap connector (with its two leads added in step 2) to the left distributor cap. Slide the other ends of the two leads onto the remaining two studs on the lead connector, following the order indicated in the photo. You may wish to wrap some black tape around the leads to keep them tidy, but it is not necessary.

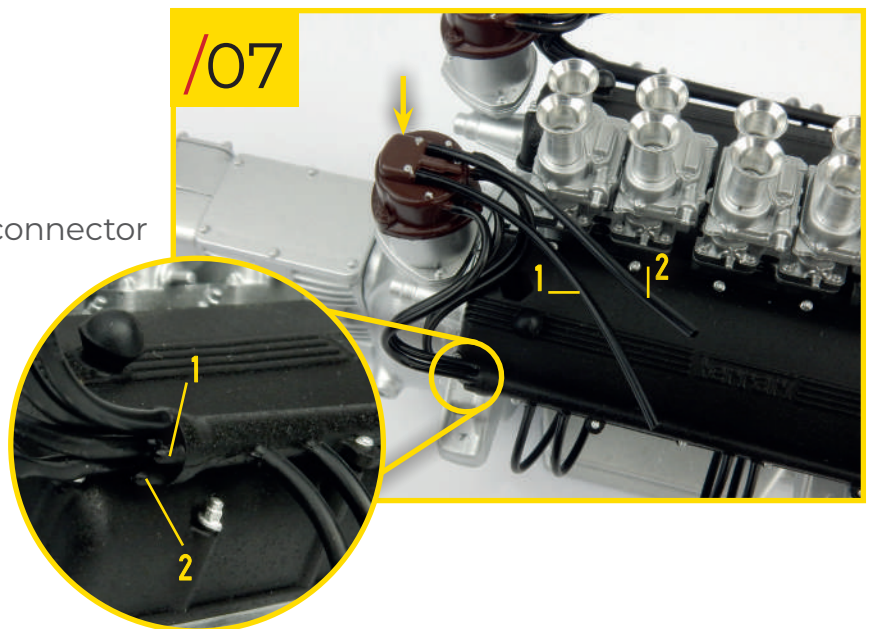

Stage 37: The Timing Chest (1)

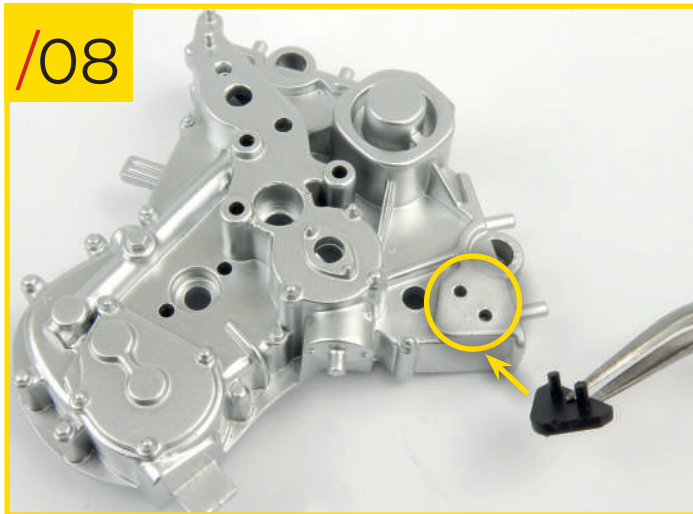

37/08 Fit the triangular protective plate into the dedicated holes in the timing chest.

37/09 Fit the gasket and mount onto the side stud on the timing chest, using the shaped fitting as a guide.

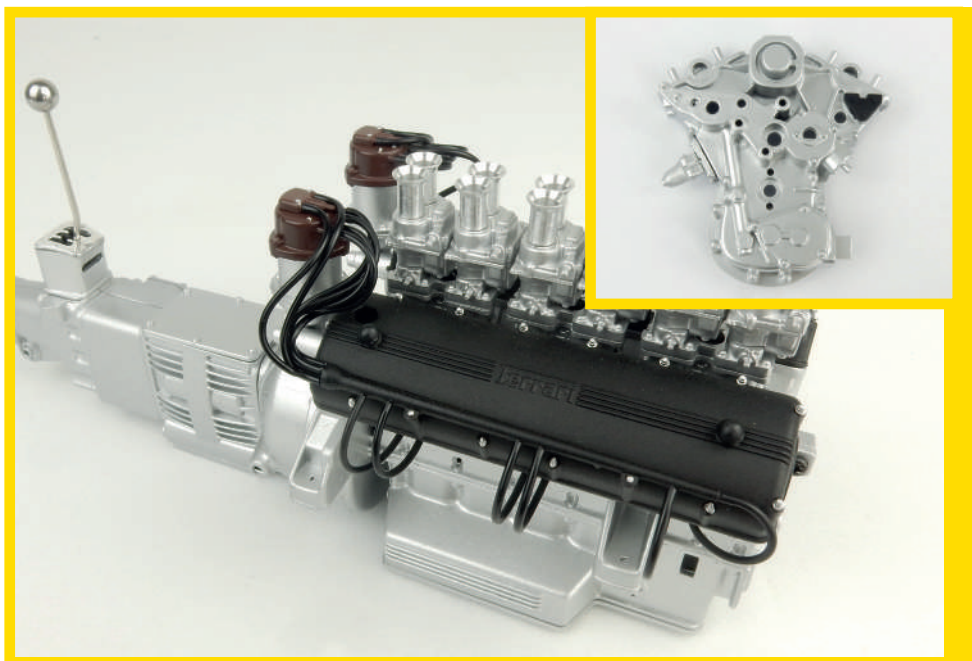
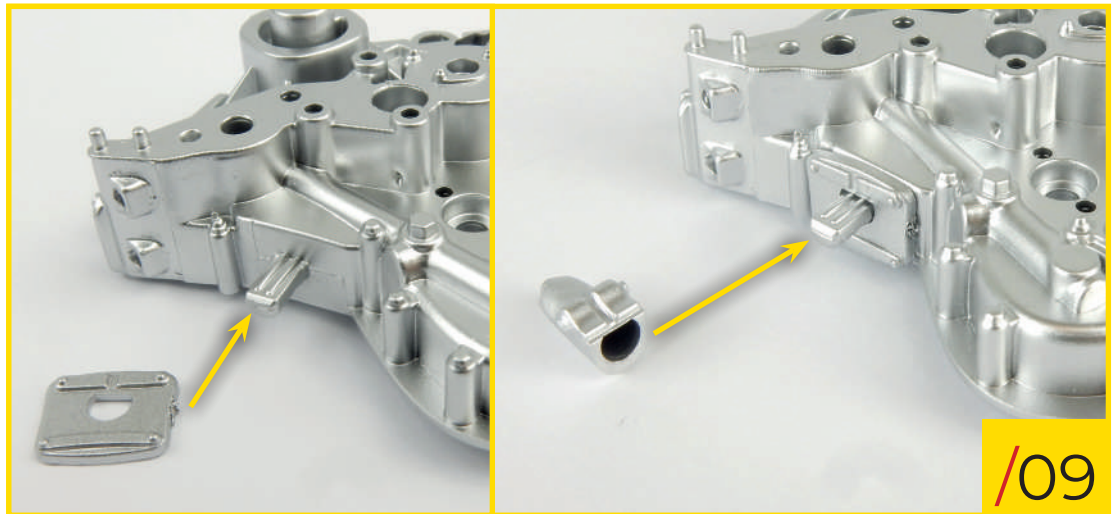

STAGE 37 IS COMPLETE
Here's how your model's engine and the timing chest look at the end of this assembly phase.

Stage 38: The Timing Chest (2)

In this stage you'll fit some additional components for the timing chest.



STAGE 38 PARTS LIST

Name
1 Timing chest caps
2 Fan mount
3 Right covering disk
4 Left covering disk
2 type B screws



Stage 38: The Timing Chest (2)

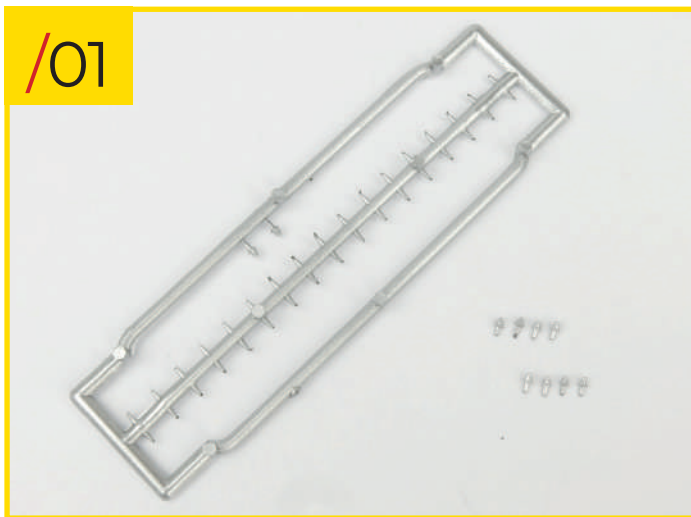

38/01 Retrieve the sprue you received with stage 8, which should have the unused bolts from stage 15. Using a small hobby knife, detach eight bolts from the sprue and be careful not to lose them.

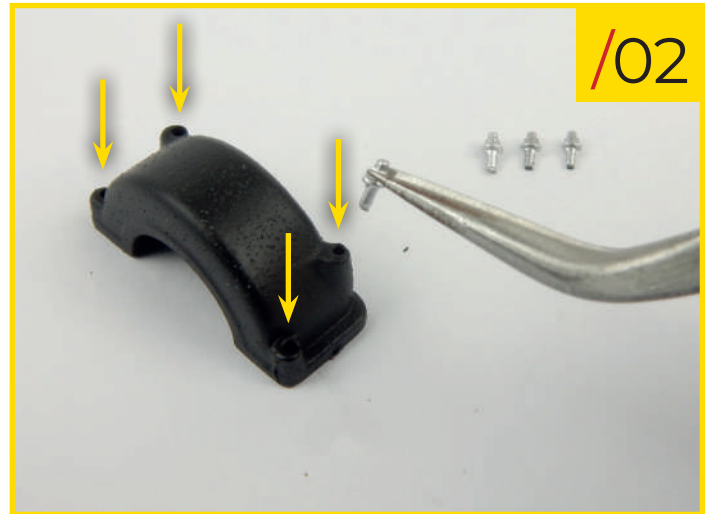

38/02 Carefully place the bolts in the indicated holes in the timing chest caps. You may need to trim the bolts to make them easier to fit.



38/03 Look at the photo carefully so that the pieces are oriented correctly for step 4: the front bolts (indicated by the yellow circles) are higher than the rear bolts (indicated by the red circles).

38/04 Retrieve the timing chest you worked on in stage 37 and fit the two timing chest caps to it. Orientate the pieces as shown in the photo, with the front bolts aligned with the upper part of the timing chest.

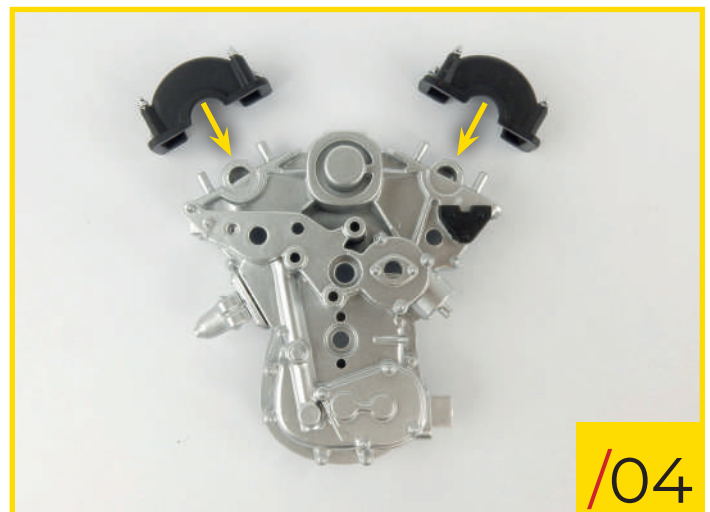

Stage 38: The Timing Chest (2)

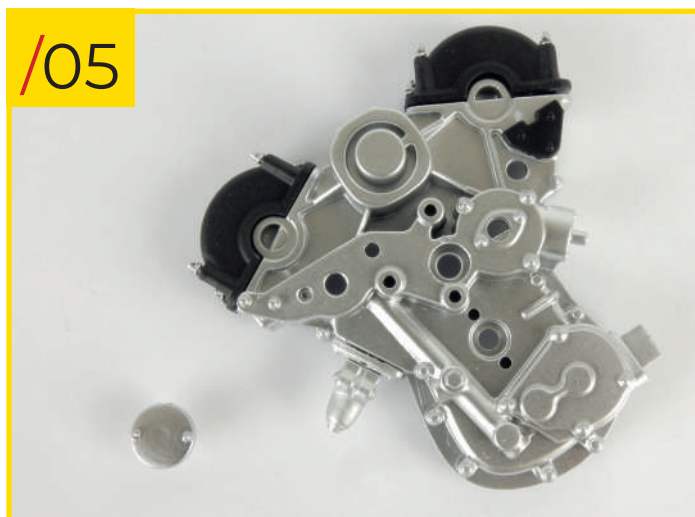

38/05 Place the right covering disk on your worksurface. Make sure you don't confuse it with the left disk: the surfaces of the two disks are different.

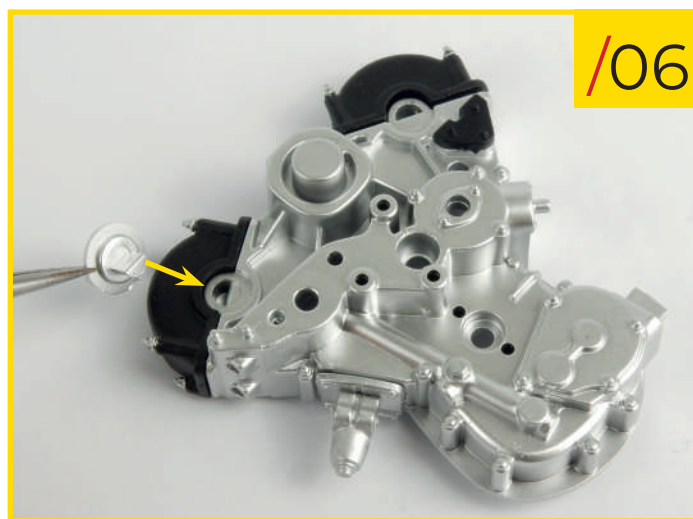

38/06 Place the right covering disk into its hole in the timing chest, as shown.

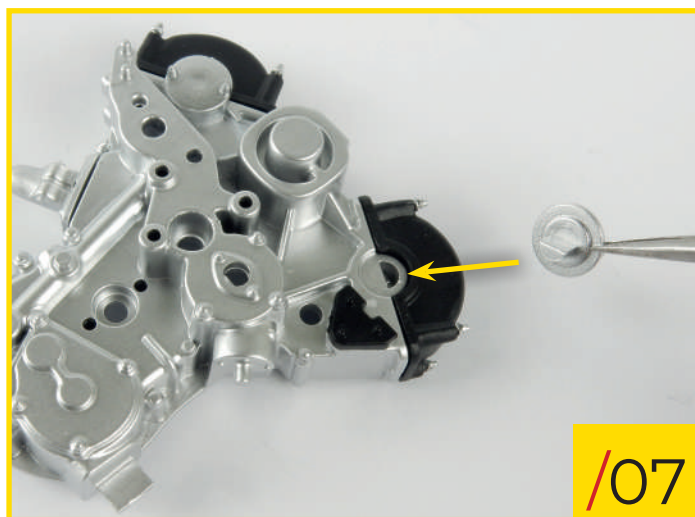

38/07 Fit the left covering disk into its hole.

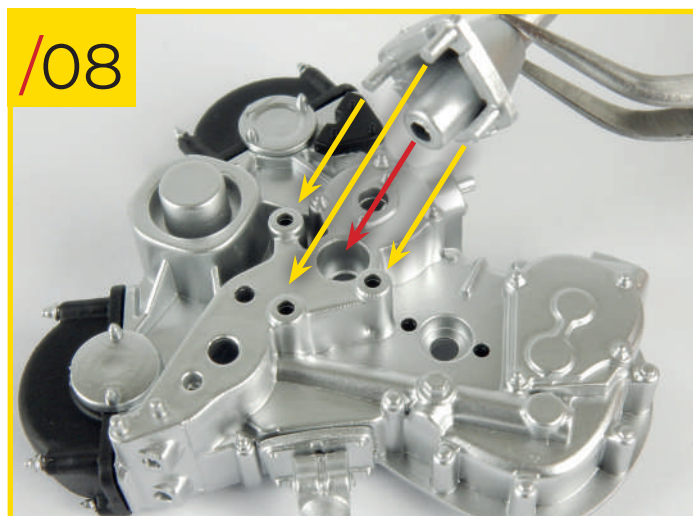

38/08 Using the arrows in the photo and the shape of the pieces as a guide, fit the fan mount into the indicated holes in the centre of the timing chest.

Stage 38: The Timing Chest (2)

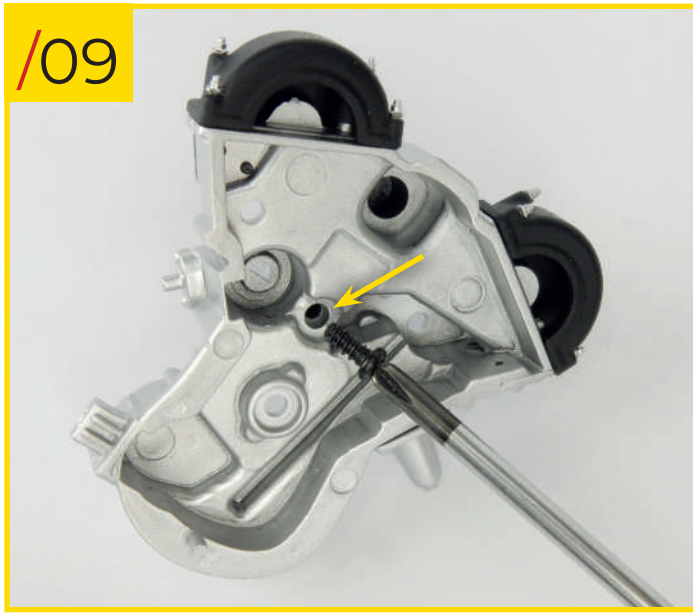

38/09 Turn the timing chest over and secure the fan mount to the rest of the assembly with a type B screw.

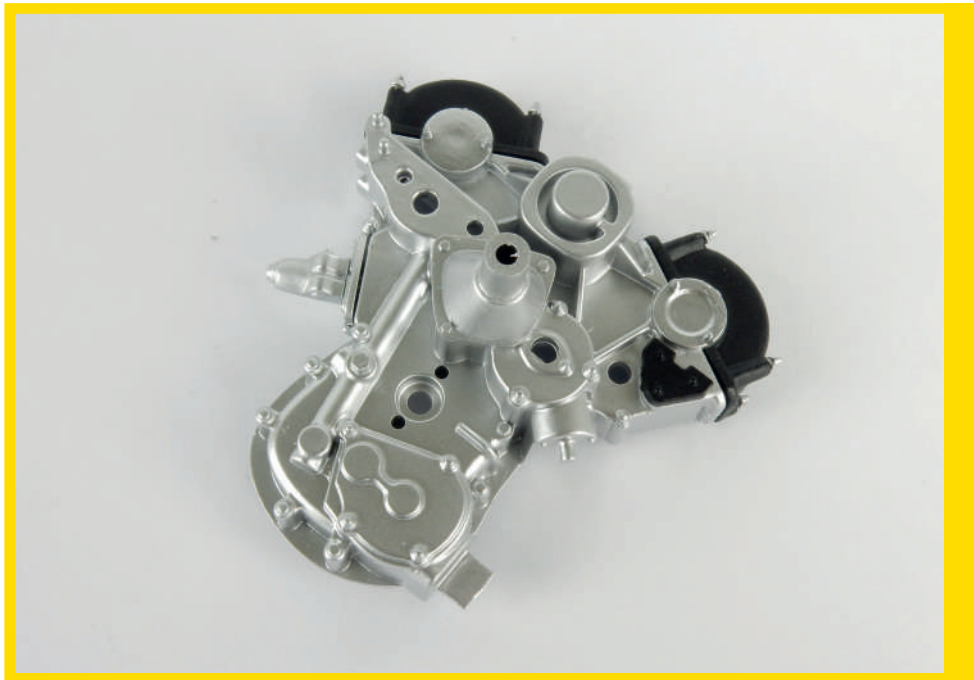

STAGE 38 IS COMPLETE
Here's how the timing chest looks at the end of this assembly phase.

Stage 39: The Timing Chest (3)

In this stage you'll add further components to the timing chest.



STAGE 39 PARTS LIST

Name	Name
1 Pulley - part A	6 Fuel pump - upper section
2 Pulley - part B	7 Water pump pipe
3 Pulley mount	
4 Fuel pump - lower section	
5 Fuel pump - central section	2 type D screws



Stage 39: The Timing Chest (3)

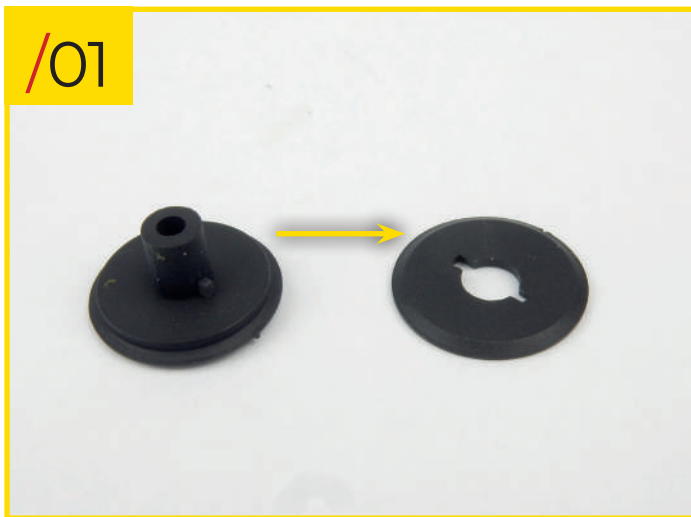

39/01 Fit the two parts of the pulley together, using the photo and the shape of the pieces as a guide.



39/02 Look at the photo to check that you've fitted the pieces together correctly.



39/03 Fit the pulley to the pulley mount, as shown in the photo.



39/04 Turn the assembly over and secure the components together using a type D screw.

Stage 39: The Timing Chest (3)

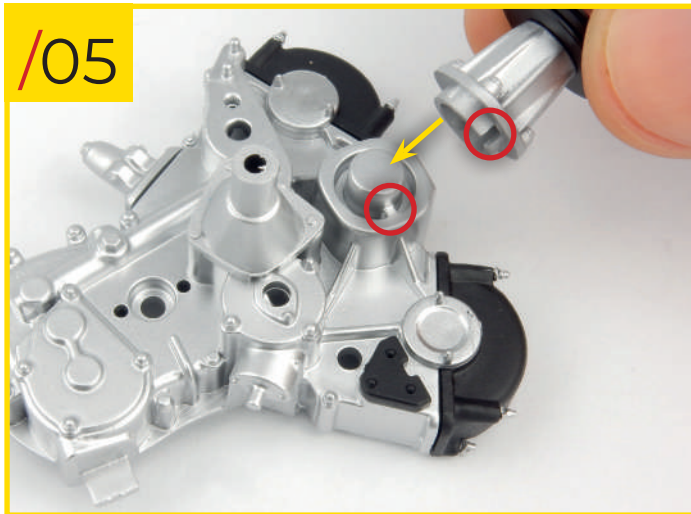

39/05 Retrieve the timing chest that you assembled in the previous stages and fit the pulley mount to it, using the photo and the shape of the pieces to ensure they line up and interlock correctly.

39/06 Fit the water pump pipe to the timing chest, as shown in the photo.

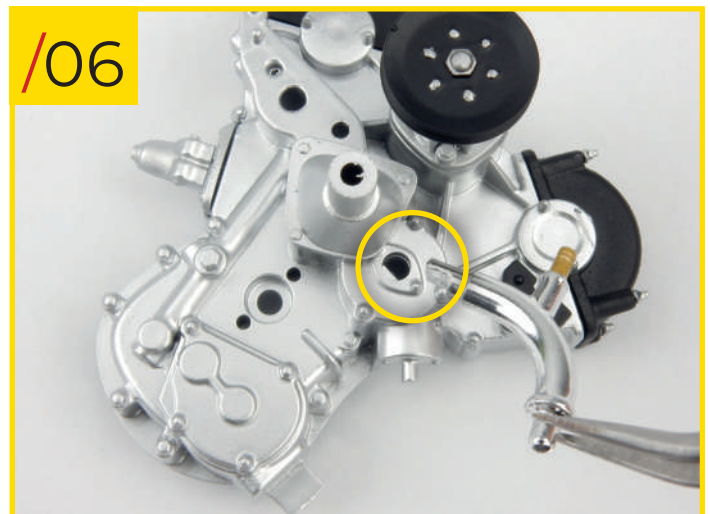

39/07 Fit the central section of the fuel pump to the lower section, orientating the pieces as shown.

Stage 39: The Timing Chest (3)

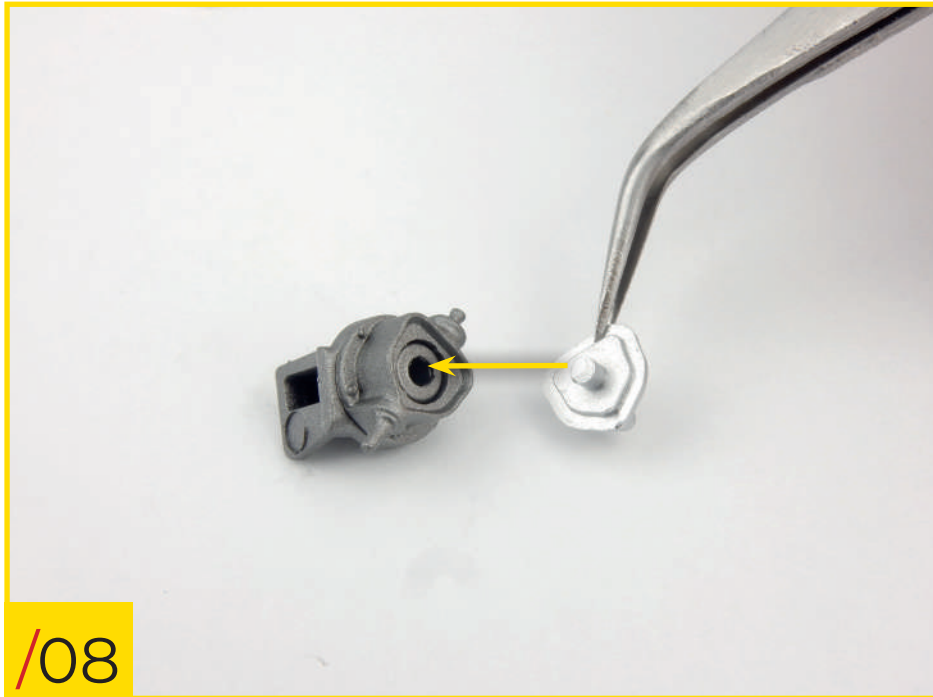

/08

39/08 Fit the upper section to the rest of the fuel pump.

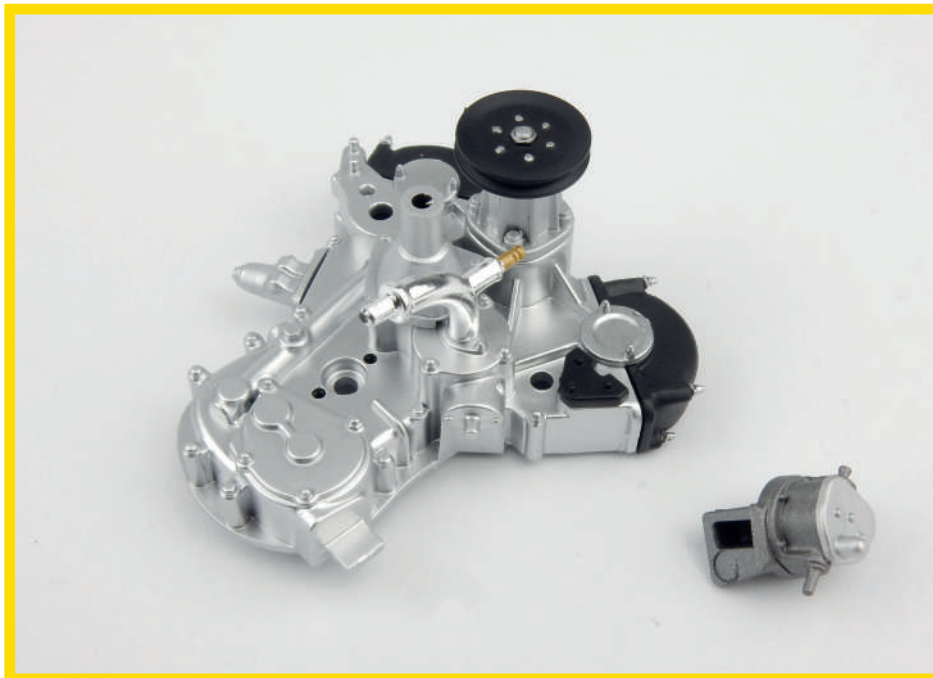

STAGE 39 IS COMPLETE
Here's how your model's timing chest looks with its new components correctly fitted. The fuel pump will be fitted to the engine in a future stage.

Stage 40: The Dynamo

In this stage you'll assemble your model's dynamo. Once assembled, keep it somewhere safe together with the other components.



STAGE 40 PARTS LIST

Name	Name
1 Pulley - part A	6 Dynamo body base
2 Pulley - part B	7 Dynamo arm
3 Pulley support	8 Dynamo bracket
4 Dynamo cooling fan	
5 Dynamo body	2 type E screws

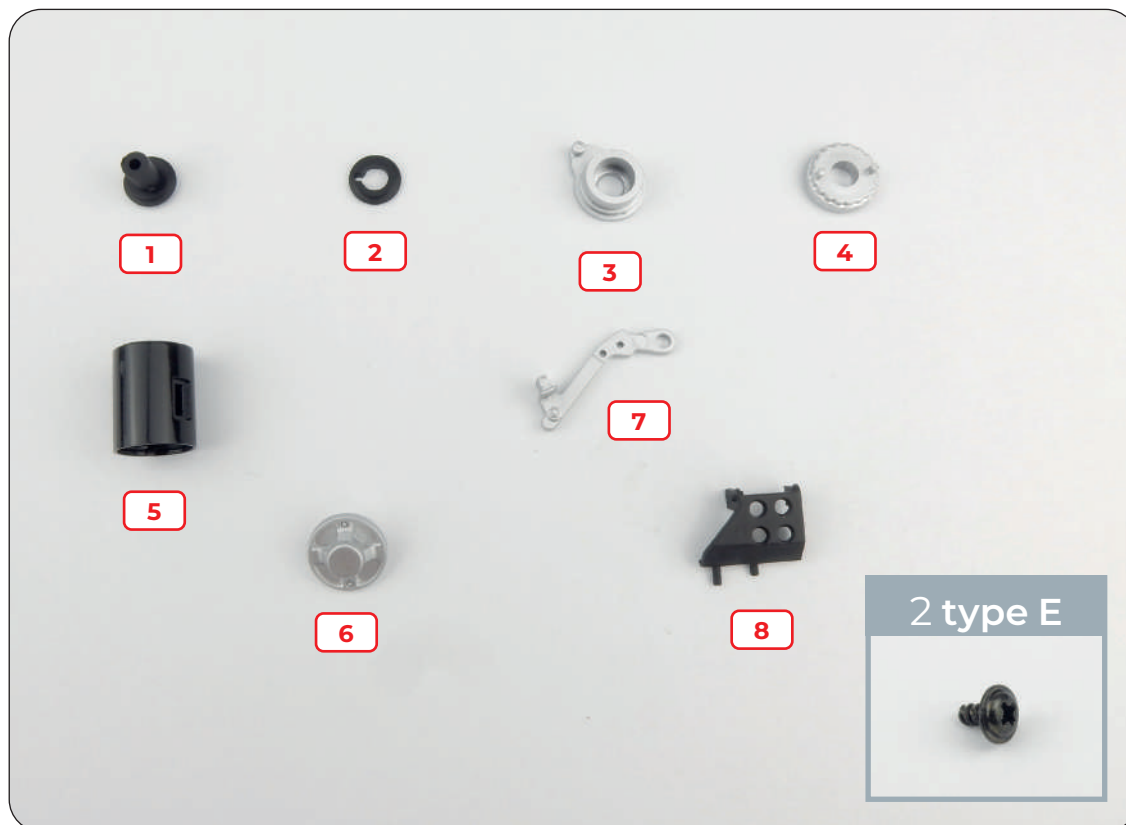

Stage 40: The Dynamo



40/02 Now fit the dynamo cooling fan to the pulley support by inserting the studs into the holes, as indicated in the photo.

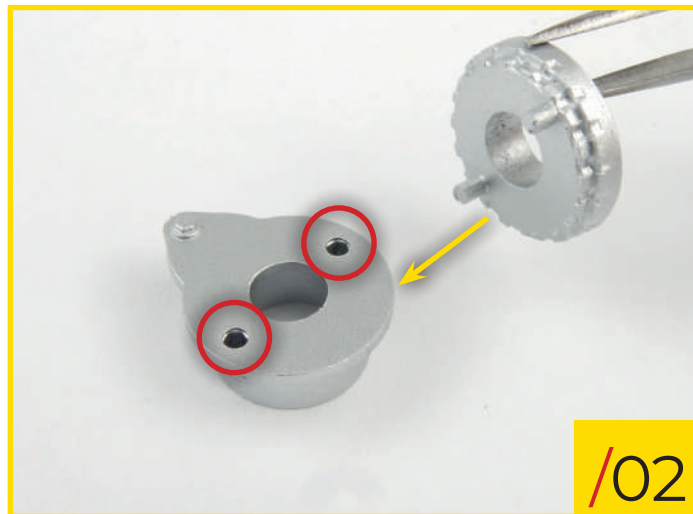

40/04 Secure the pieces together using a type E screw.

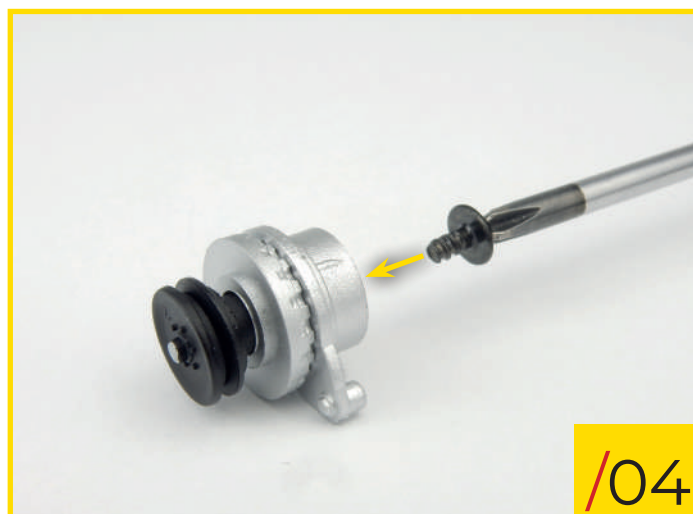

Stage 40: The Dynamo



40/05 Add the base to the body of the dynamo.

40/06 Turn the dynamo body upside down and fit the pulley assembly to it. There's only one way that the pieces will fit together.



40/07 Now fit the arm to the dynamo body by inserting the end of the arm, indicated by the red circle in the photo, into the corresponding hole in the dynamo body, indicated by the yellow circle.

40/08 Here's how the arm looks after it's been correctly fitted to the dynamo body.



Stage 40: The Dynamo

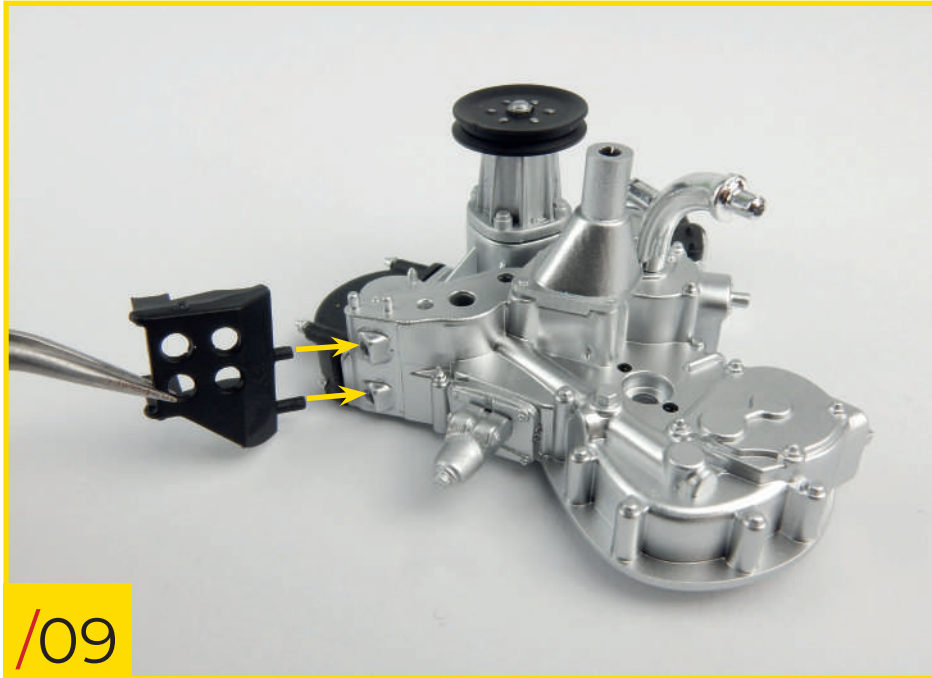

40/09 Fit the dynamo bracket to the timing chest that you assembled in the previous stages. Check the photo to make sure they are fitted together correctly.

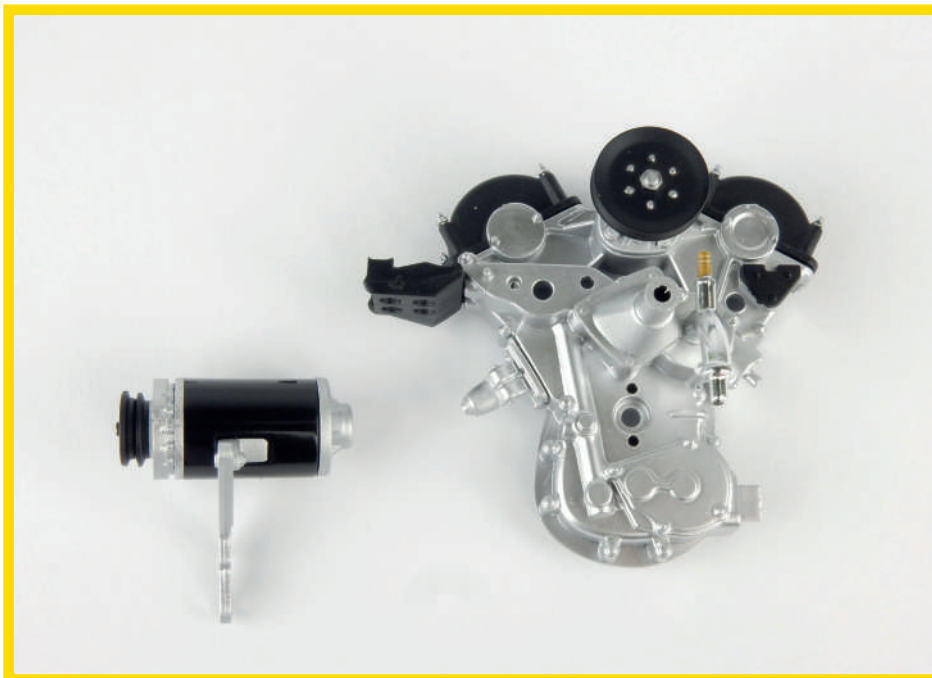

STAGE 40 IS COMPLETE
Here's how the dynamo and timing chest look at the end of this assembly phase. Keep them in a safe place until needed.