

# TITANIC

THE SHIP • THE LEGEND

**Pack 22**



# STERN CROSS SUPPORT



## PARTS IN THIS ISSUE

**123A** Stern cross support

**123B** Brackets (x 2)

**123C** Plate

**AM** Eleven PM screws  
(1 spare)

**1** Take the cross support **123A** and check how it fits on the plate **123C**. When you are happy with the fit, fix in place with two **AM** screws.

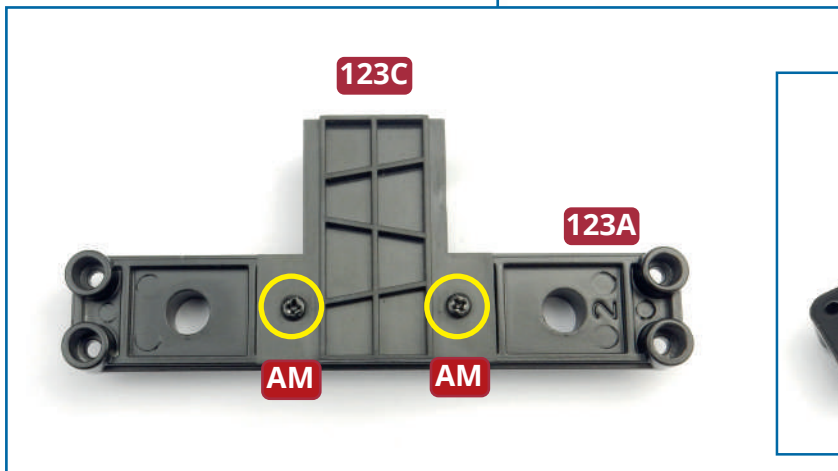
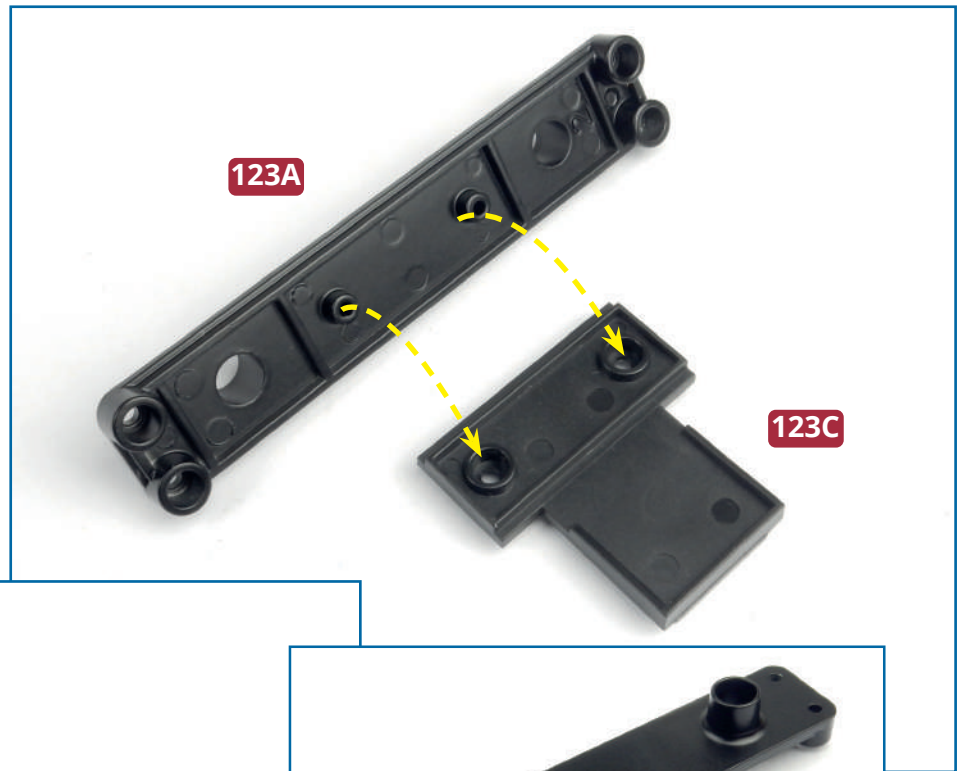



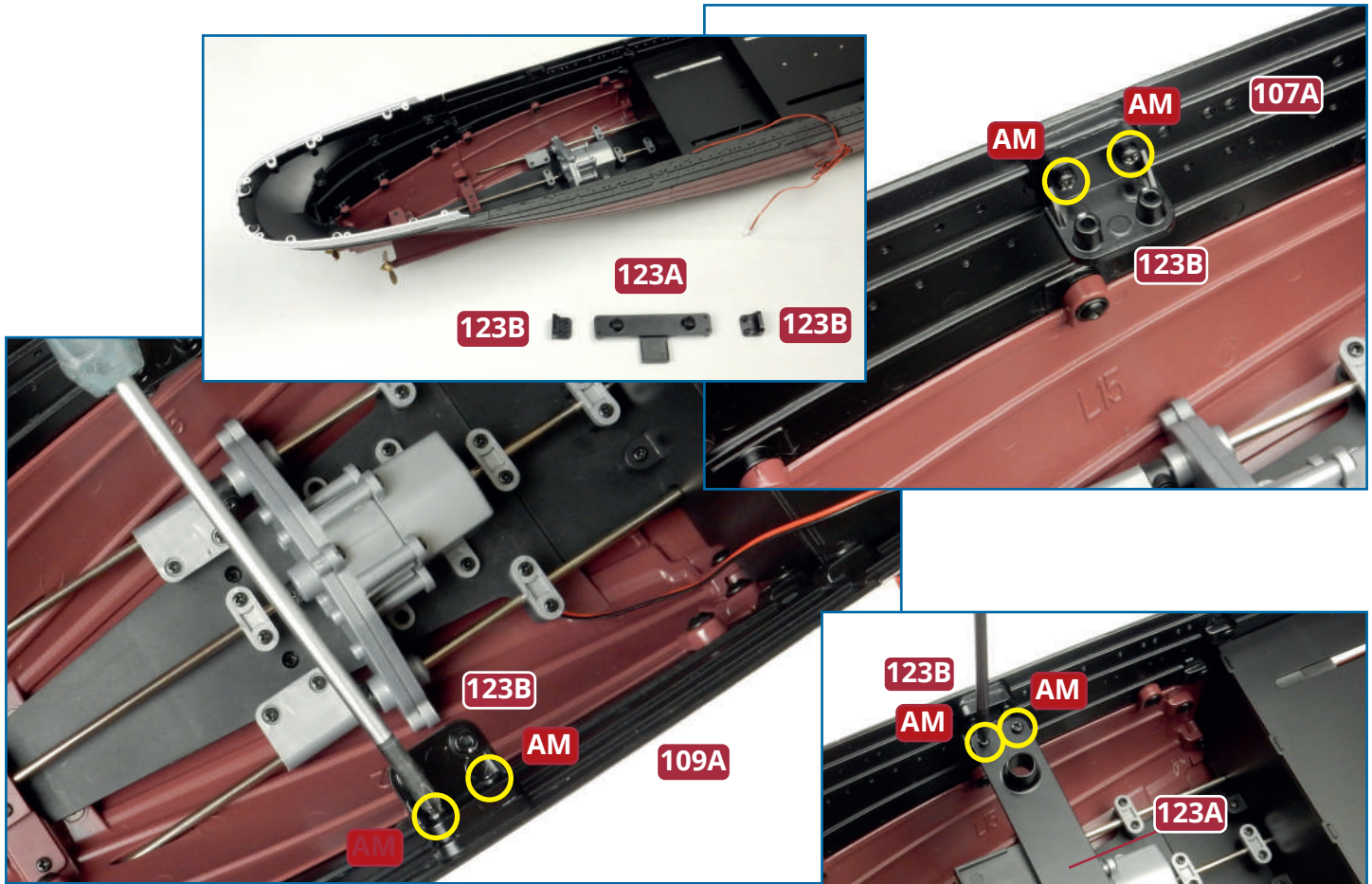

**2** Take the hull assembly and the two brackets **123B**. Identify the fixing points for the brackets on the upper hull sections **107A** (port side) and **109A** (starboard side). Fix the brackets in place with two **AM** screws. Fit the cross support **123A** across the hull so that it sits on the brackets, with the plate **123C** to the aft side. Fix in place with four **AM** screws.

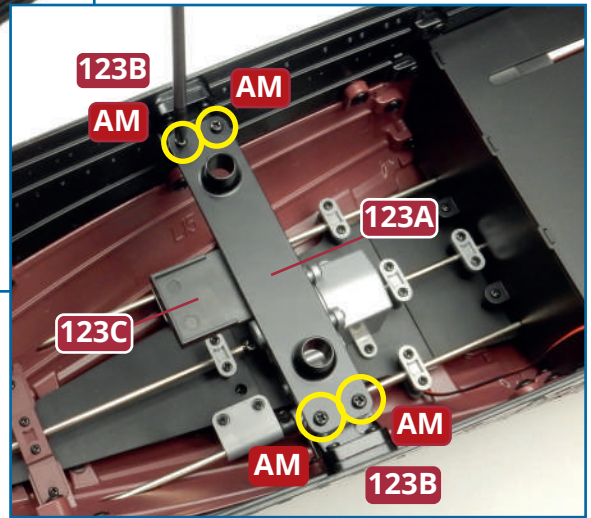

### Completed work

A cross support beam has been fitted across the aft of the hull.

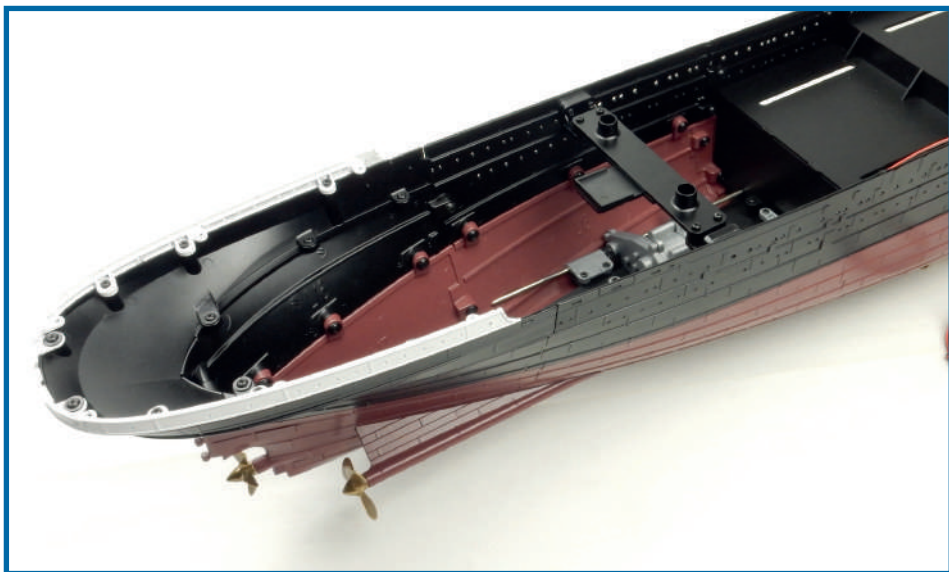



# THE POOP DECK

## PARTS IN THIS ISSUE

**124A** Decking

**124B** Poop deck

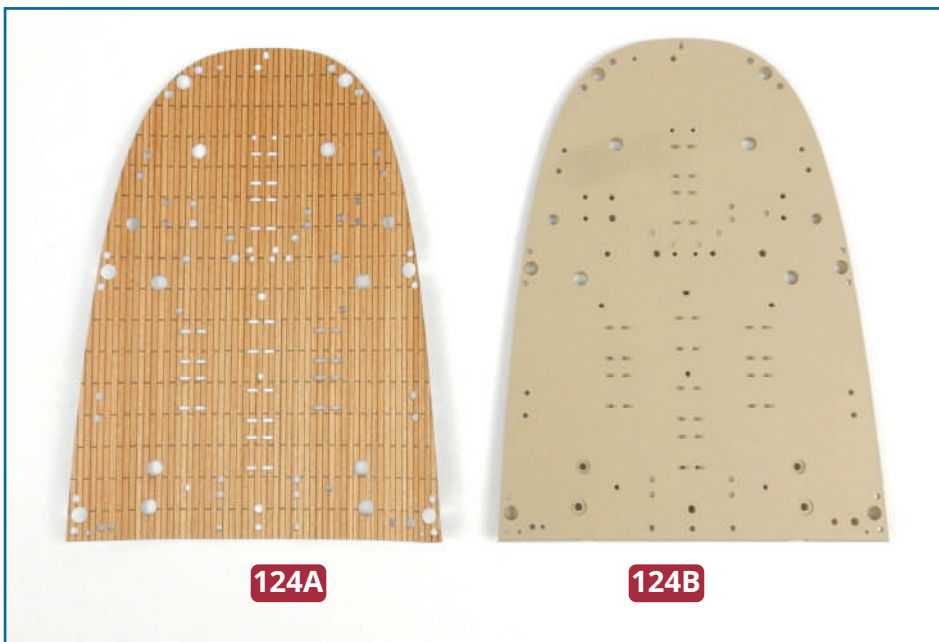

**124A**

**124B**

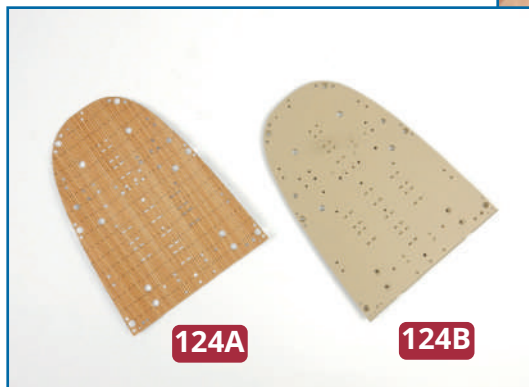

**124A**

**124B**

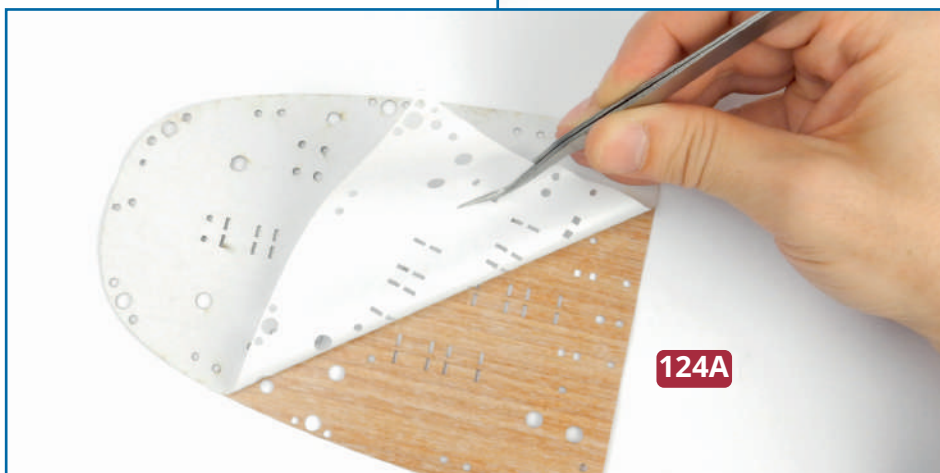
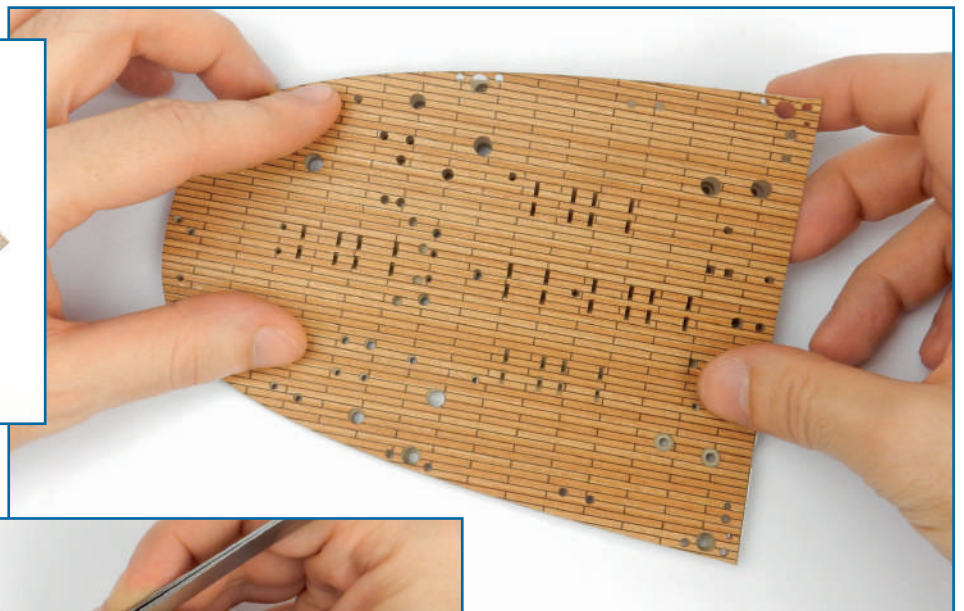

**124A**

**1** Take the decking **124A** and the poop deck **124B**. Carefully check how the decking should be positioned on the deck, then remove the protective backing from the decking using tweezers (left).



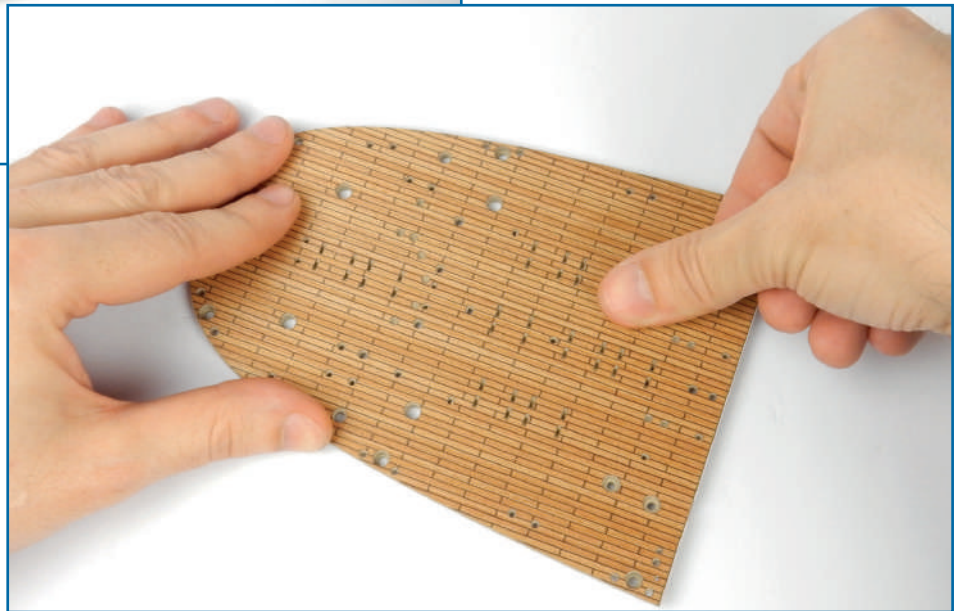
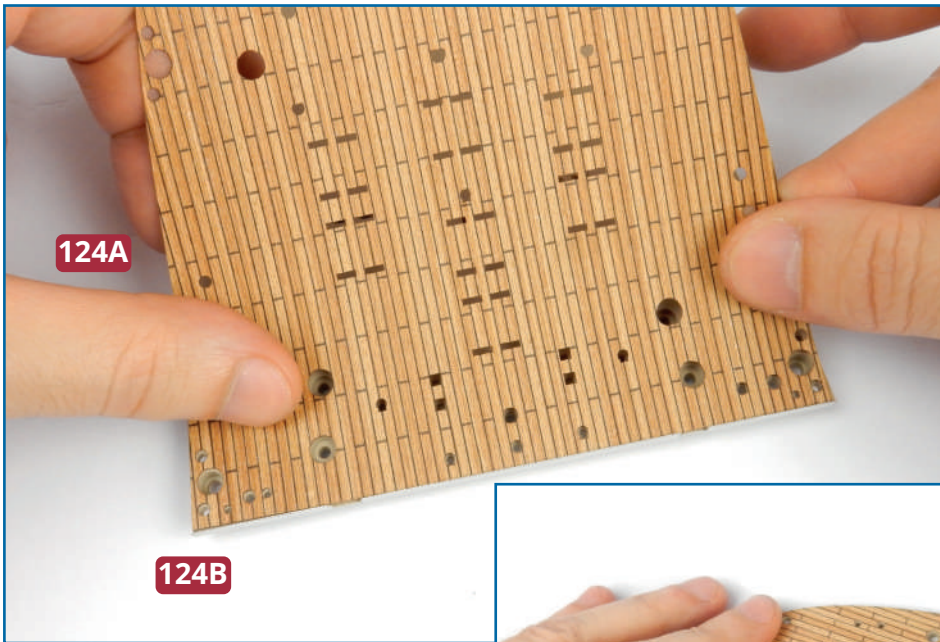

**2** Working from the straight edge at the forward end of the deck **124B**, stick the decking **124A** in place, smoothing it down with a soft cloth.

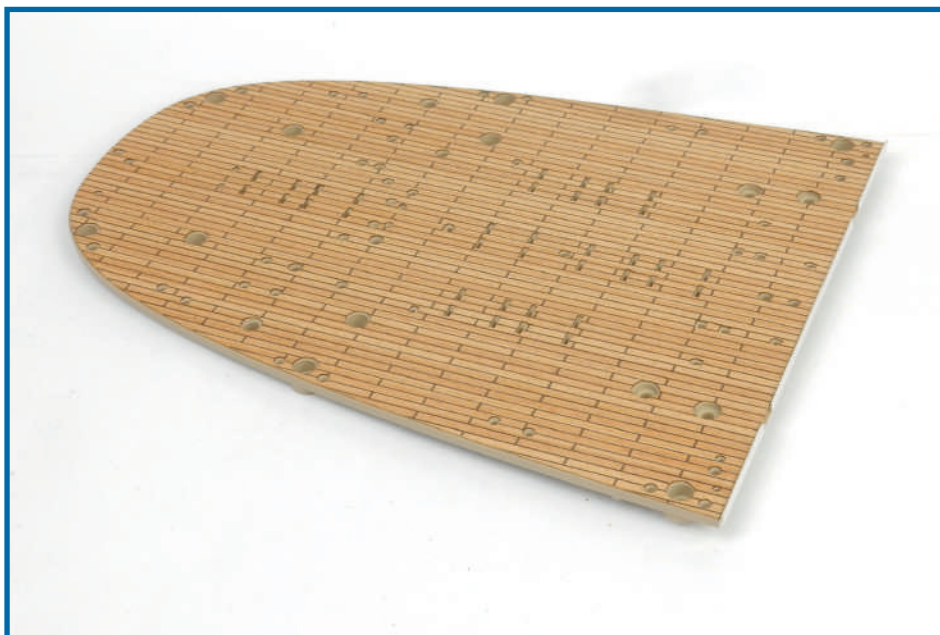

### Completed work

The decking has been fitted to the poop deck.

# THE FIRST AFT CRANE



## PARTS IN THIS ISSUE

- 125A** Crane motor
- 125B** Crane upright
- 125C** Hook
- 125D** Plastic peg
- 125E** Crane base
- 125F** Stairwell access
- 125G** Long pin
- 125H** Short pin
- 125J** Plastic washer
- 125K** Crane cable
- 125L** Right tie rod
- 125M** Left tie rod
- 125N** Crane boom
- AP** Three 2.3 x 5mm PB screws (1 spare)
- HP** Two 1.7 x 4mm PWB screws (1 spare)

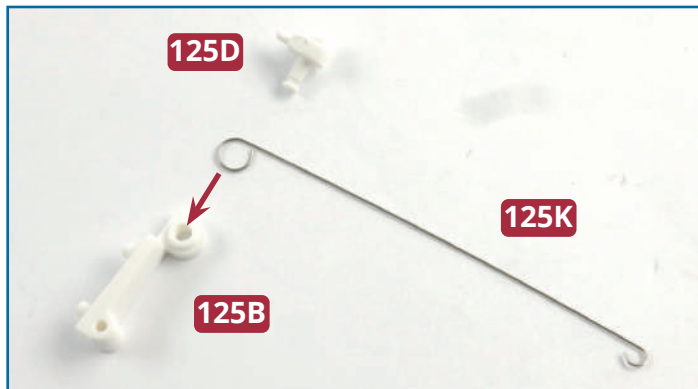

**1** Take the crane parts **125B**, **125D** and **125K**. Fit the large loop of the cable **125K** over the raised socket on part **125B**. Fit the peg **125D** into the socket to hold the cable in place as shown (right). Fit the motor **125A** to the back of the crane upright **125B** (below).

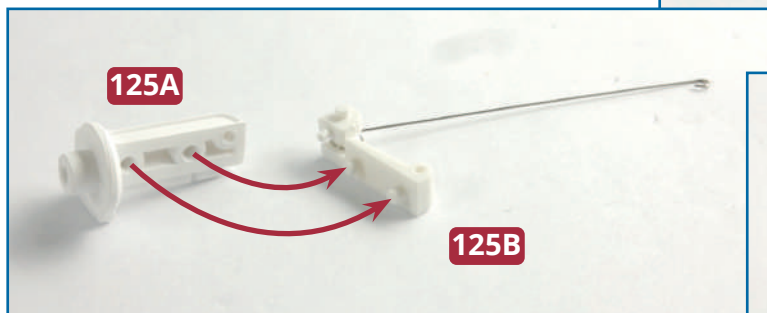
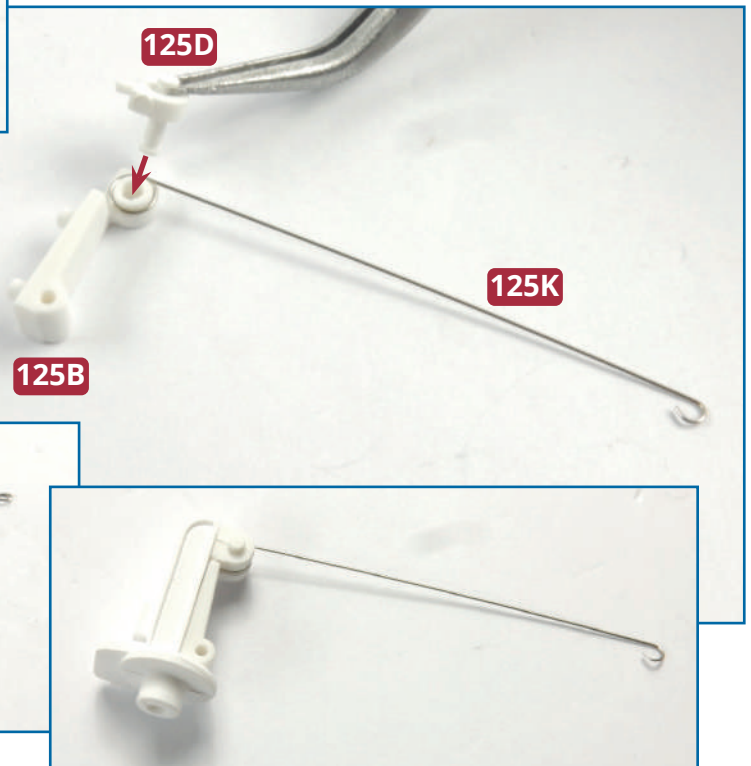



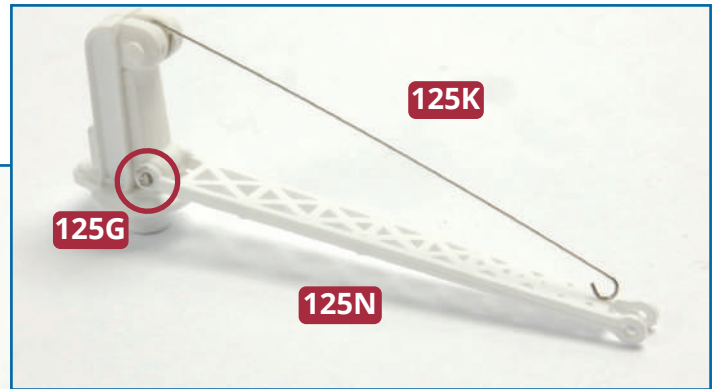
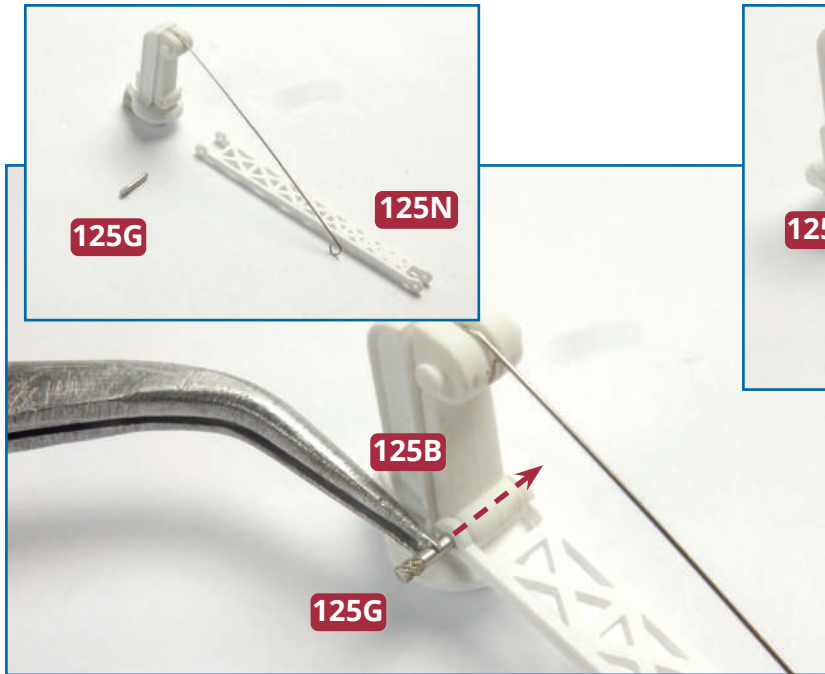

**2** Take the crane boom **125N** and the long pin **125G**. Fit the eyelets on the wide end of part **125N** on either side of the cylindrical structure at the base of part **125B**. Fit the pin **125G** through the structure, fitting the smooth end first. The crimped end will hold the pin in place. Use a pair of small pliers to squeeze the pin in place.

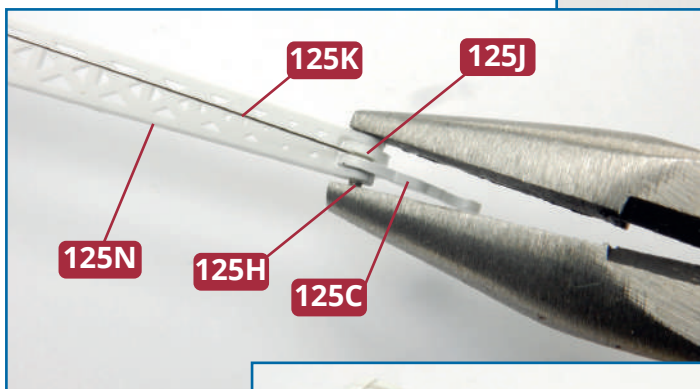
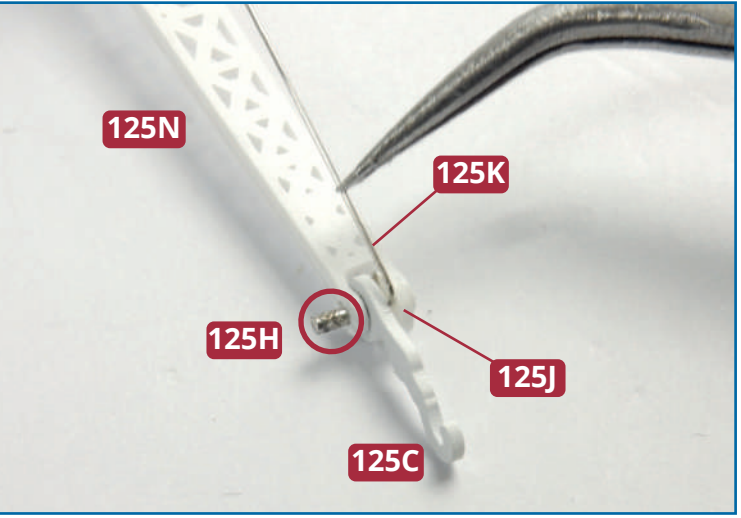

**3** Fit the eyelet on the hook **125C** and the washer **125J** between the eyelets at the narrow end of the boom **125N** so that all the holes are aligned. Fit the smaller loop on the cable **125K** between the hook and the washer. Fix the hook, cable and washer in place with the short pin **125H**. Fit the smooth end first and squeeze the pin in place with pliers.

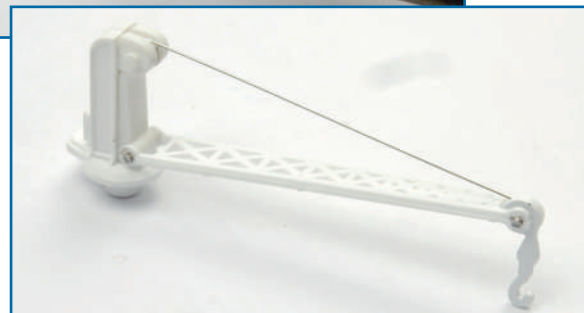

## ★ STEP-BY-STEP INSTRUCTIONS ★

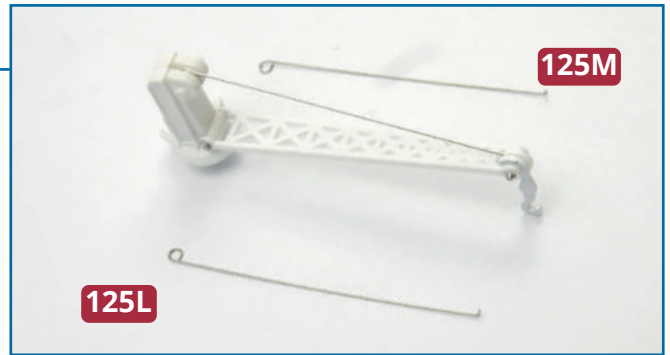
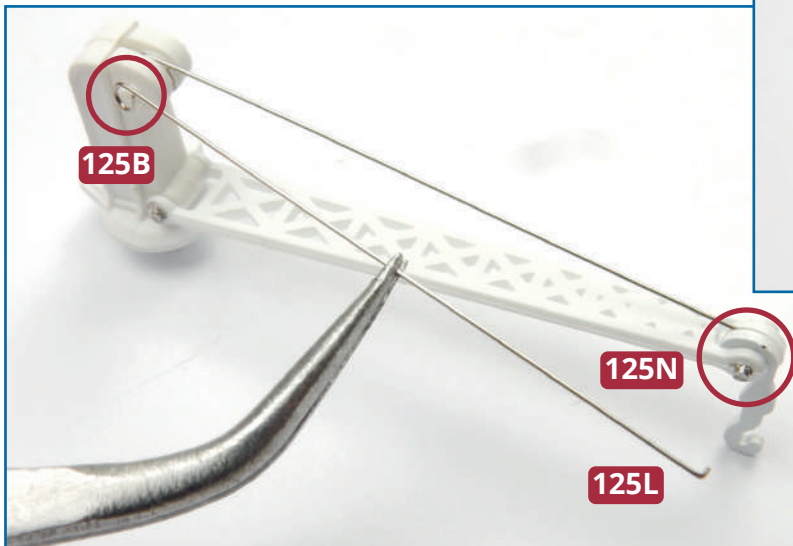

**4** Fit the right and left tie rods, **125L** and **125M** to the crane so that they run between the upright **125B** and the end of the boom **125N**, as shown. Fix the ends of the wires in place on either side of the hook with a drop of glue.

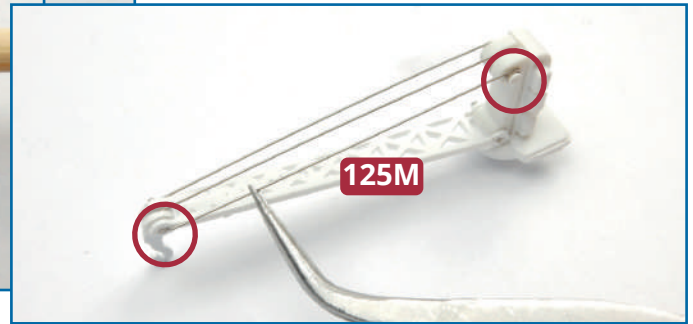
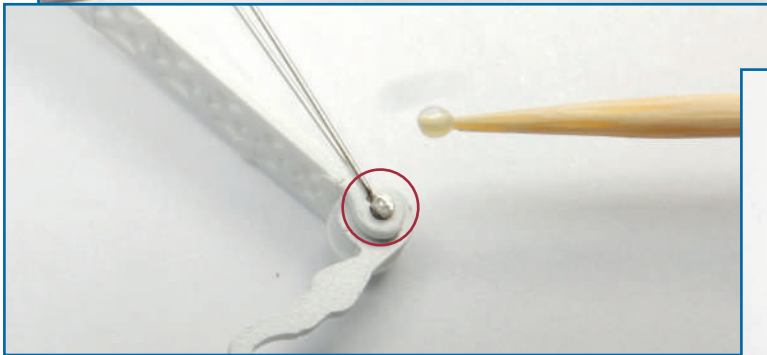

**5** Fit the crane assembly on the base **125E**. Fix in place with an **HP** screw. Do not overtighten the screw as the crane must be free to rotate.

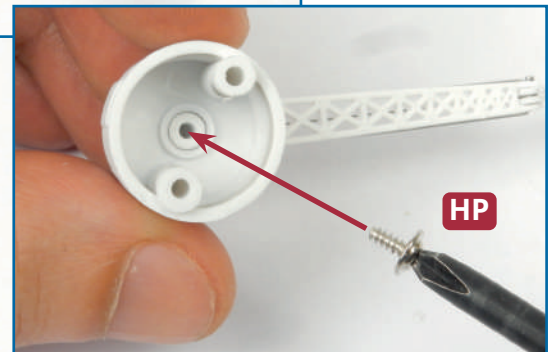



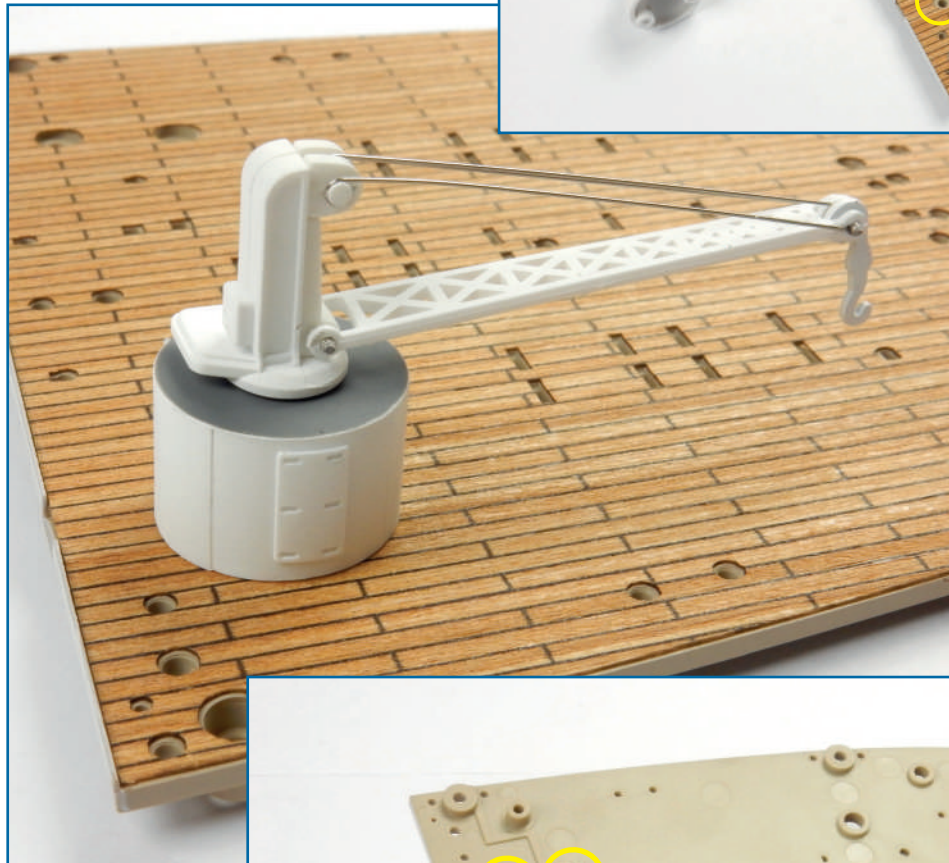
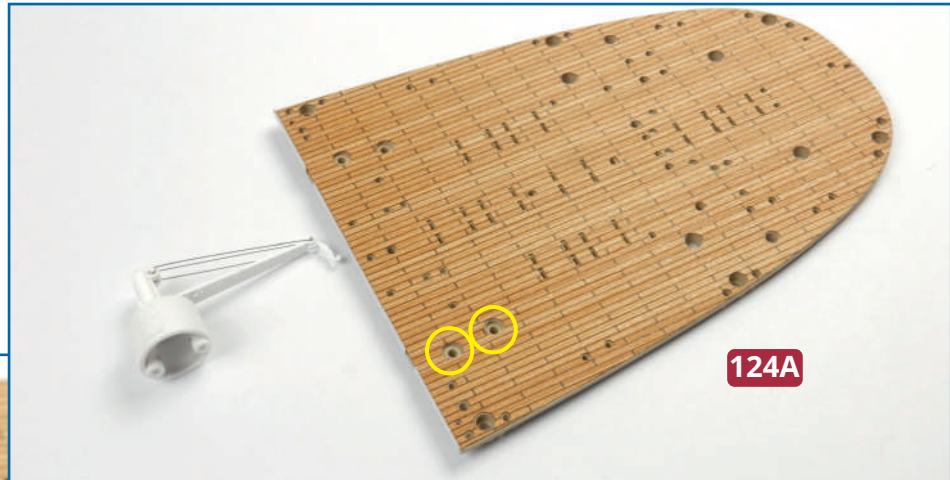

**6** Take the poop deck assembly from the previous issue and identify the fixing point for the crane (circled above). Position the crane as shown (left) and fix it to the deck from beneath with two **AP** screws (below).

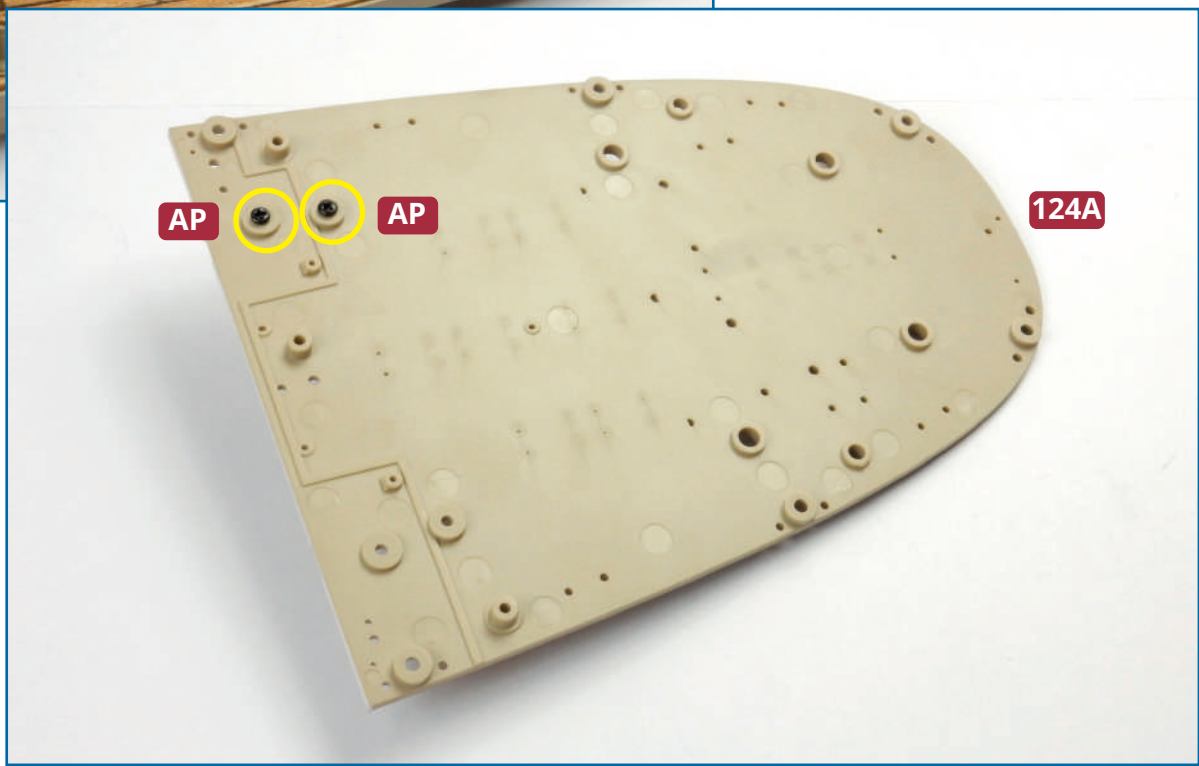



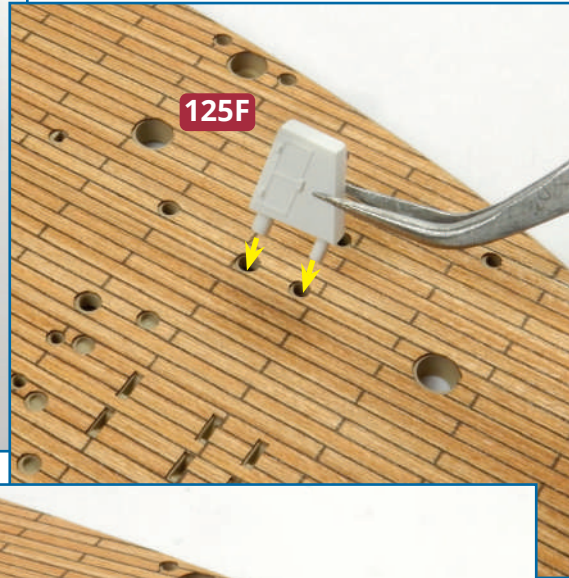
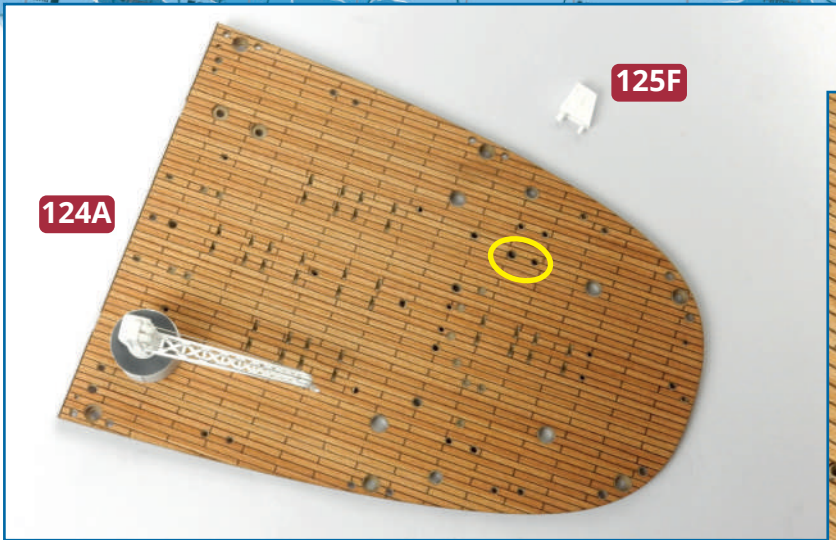

**7** Position the stairwell access **125F** on the poop deck, as shown. Note that the pegs are different sizes to help fit the stairwell access the right way round. Use a little glue to hold it in place.

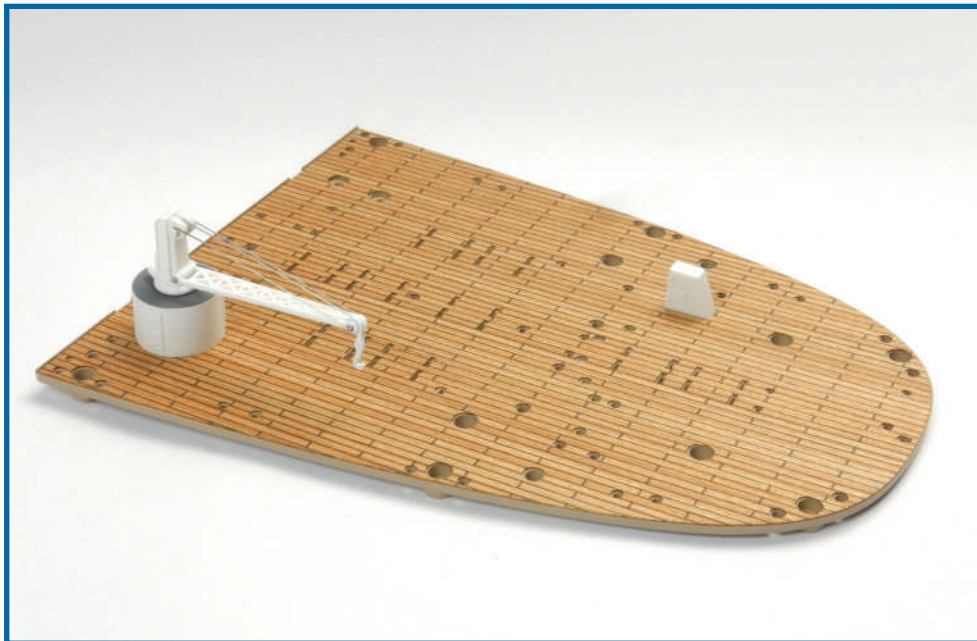
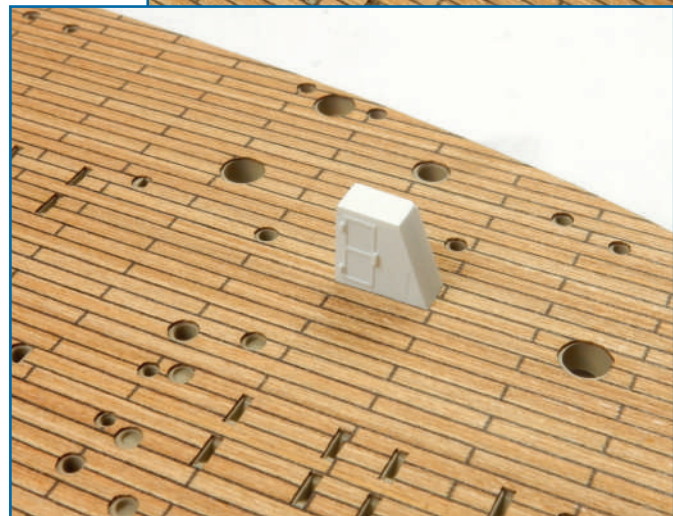

### Completed work

The first of the aft cranes has been assembled and fitted to the poop deck, along with a door to access a stairwell.





# THE SECOND AFT CRANE

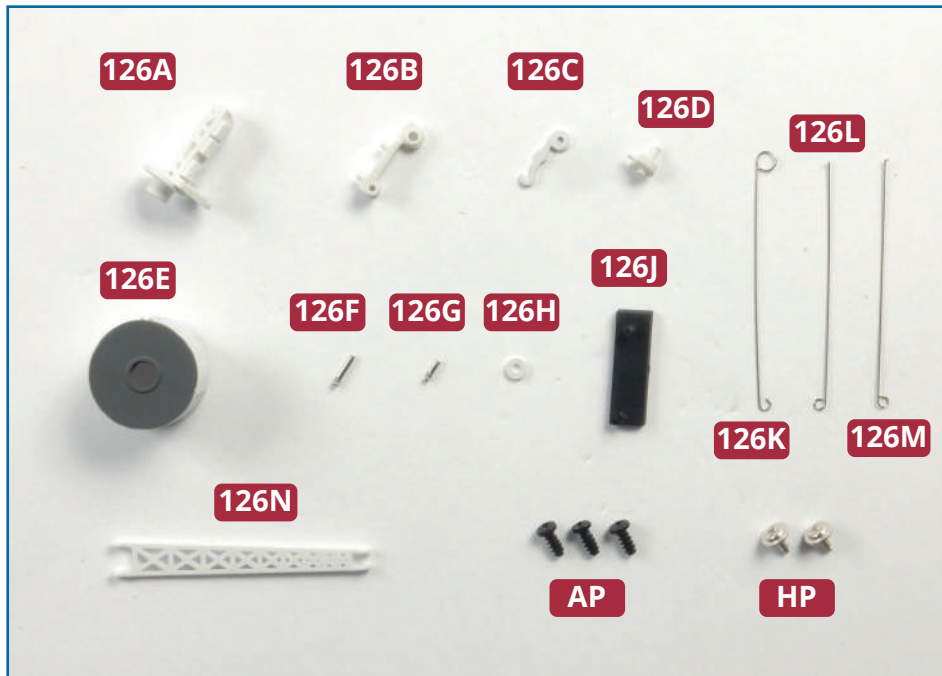

## PARTS IN THIS ISSUE

- 126A** Crane motor
- 126B** Crane upright
- 126C** Hook
- 126D** Plastic peg
- 126E** Crane base
- 126F** Long pin
- 126G** Short pin
- 126H** Plastic washer
- 126J** Hull plate
- 126K** Crane Cable
- 126L** Right tie rod
- 126M** Left tie rod
- 126N** Crane boom
- AP** Three PB screws (1 spare)
- HP** Two PWB screws (1 spare)

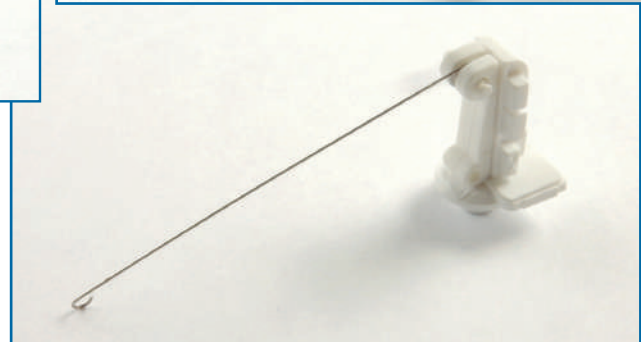
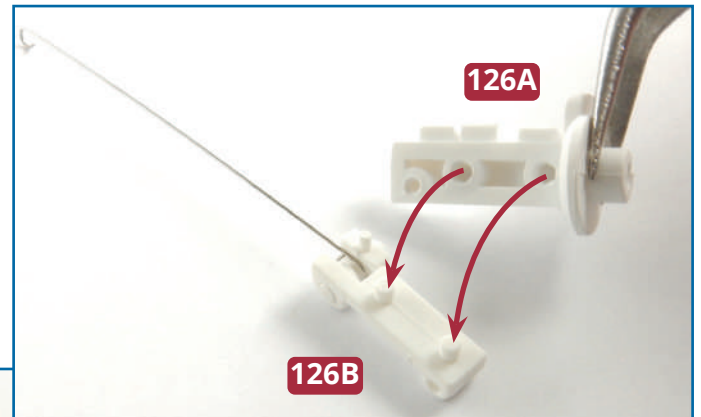
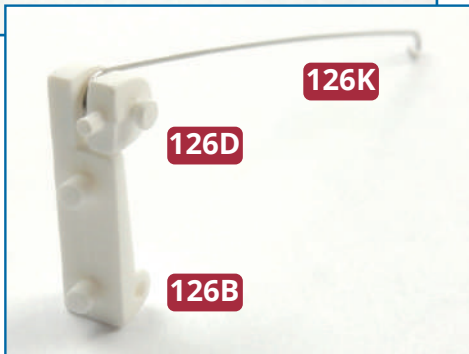
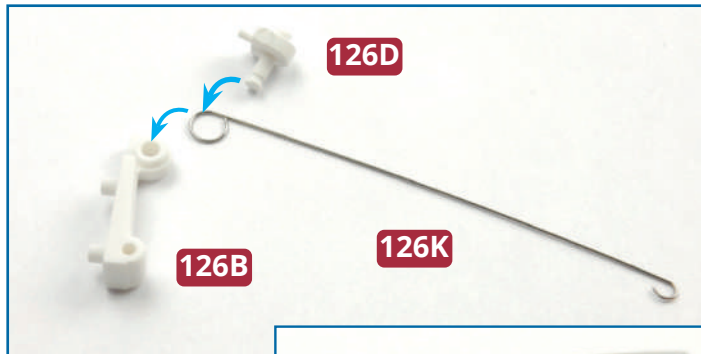

**1** Take the crane parts **126B**, **126D** and **126K**. Fit the large loop of the cable **126K** over the raised socket on part **126B**. Fit the peg **126D** into the socket, to hold the cable in place, as shown above. Fit the motor **126A** to the back of the crane upright **126B**, as indicated above right.

## ★ STEP-BY-STEP INSTRUCTIONS ★

**2** Take the crane boom **126N** and the long pin **126F**. Fit the eyelets on the wide end of part **126N** on either side of the cylindrical structure at the base of part **126B**. Fit the pin **126F** through the structure, fitting the smooth end first. Use a pair of small pliers to squeeze the pin in place.

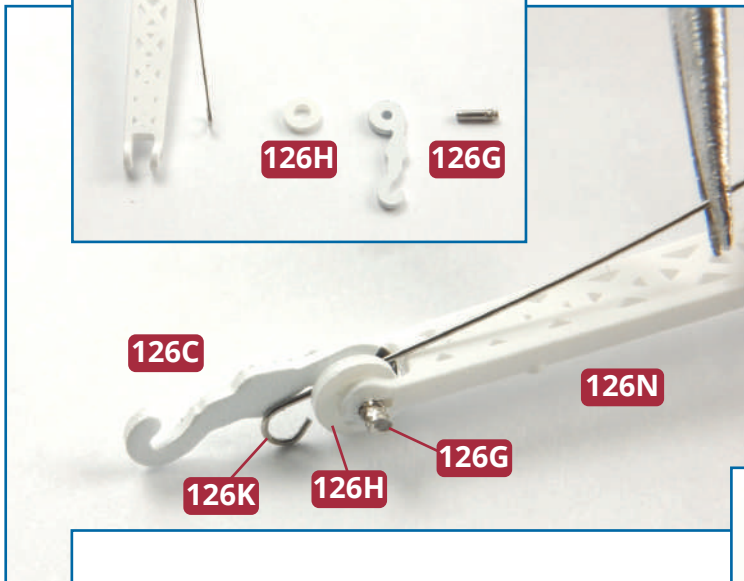
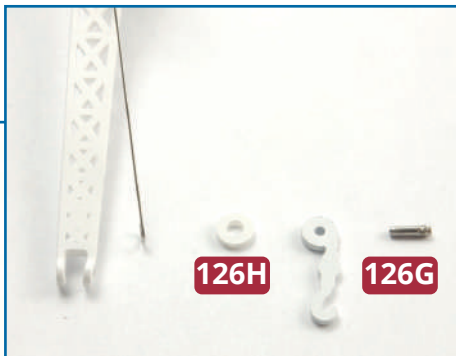
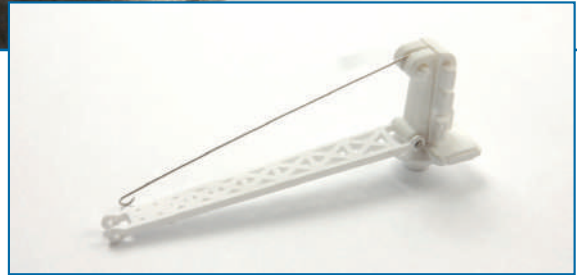
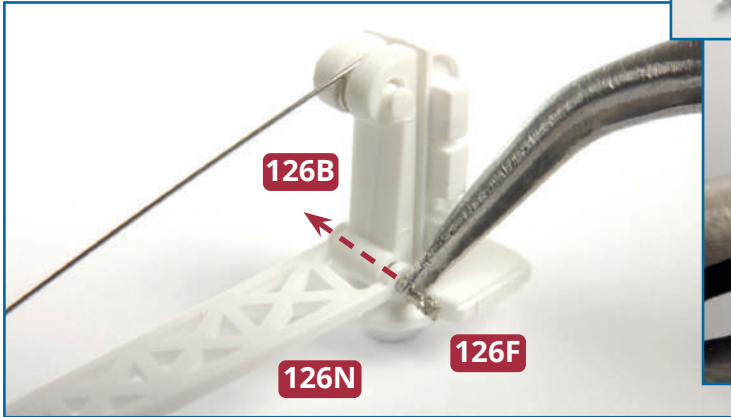
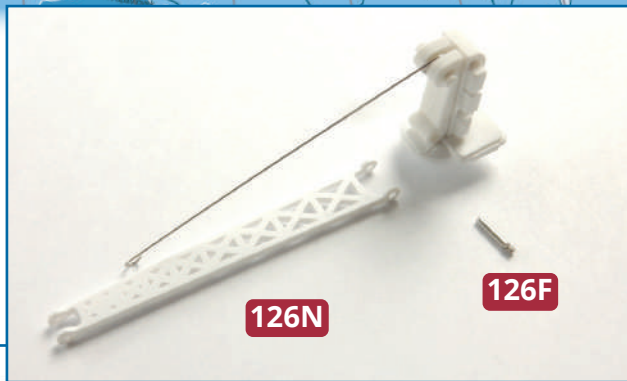

**3** Fit the eyelet on the hook **126C** and the washer **126H** between the eyelets at the narrow end of the boom **126N** so that all the holes are aligned. Fit the smaller loop on the cable **126K** between the hook and the washer. Fix the hook, cable and washer in place with the short pin **126G**. Fit the smooth end first and squeeze the pin in place with pliers.

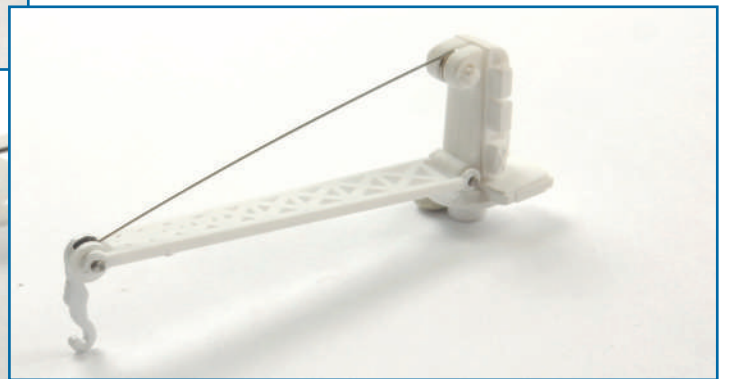



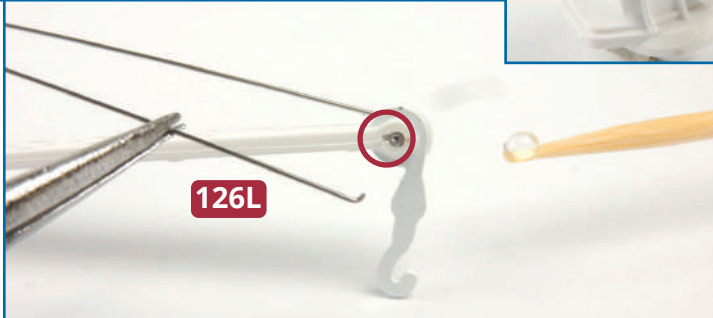
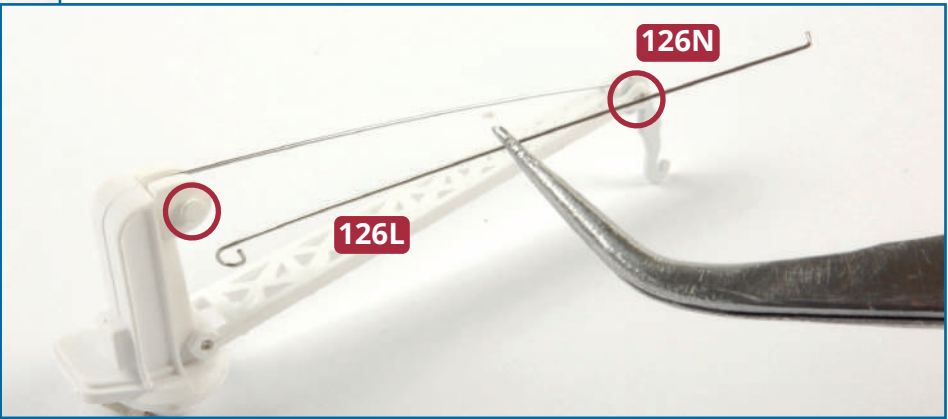
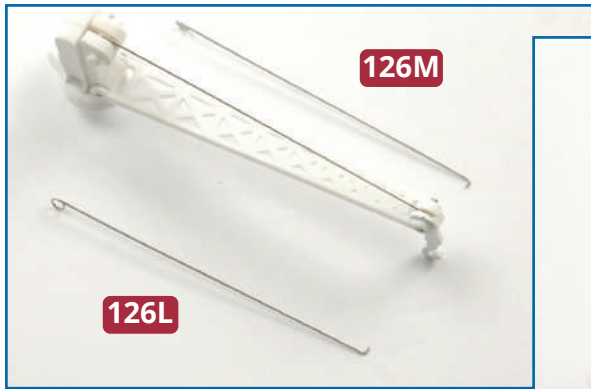

**4** Fit the right and left tie rods, **126L** and **126M** to the crane so that they run between the upright **126B** and the end of the boom **126N**, as shown. Fix the ends of the wires in place beside the hook with a drop of glue.

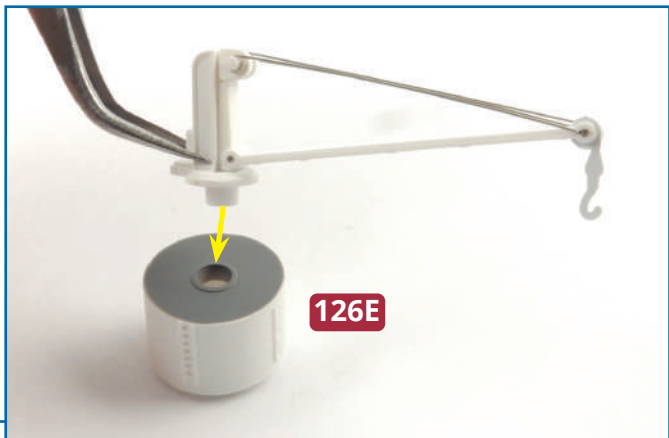

**5** Fit the crane assembly on the base **126E**. Fix in place with an **HP** screw. Do not overtighten the screw as the crane must be free to rotate.



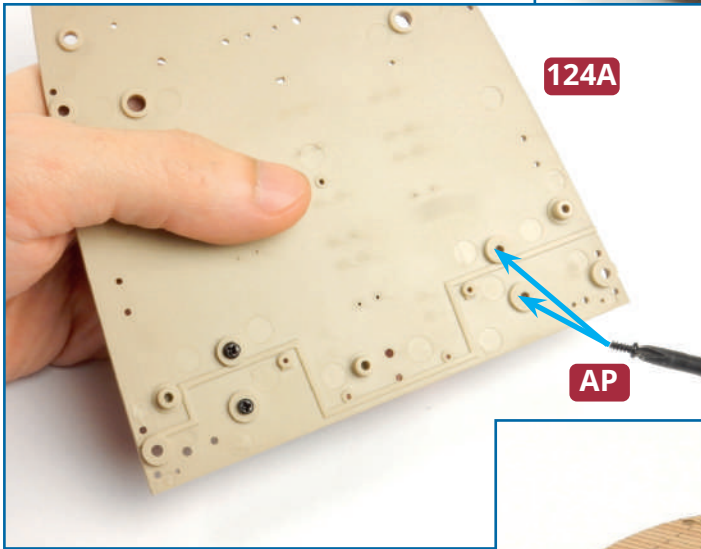
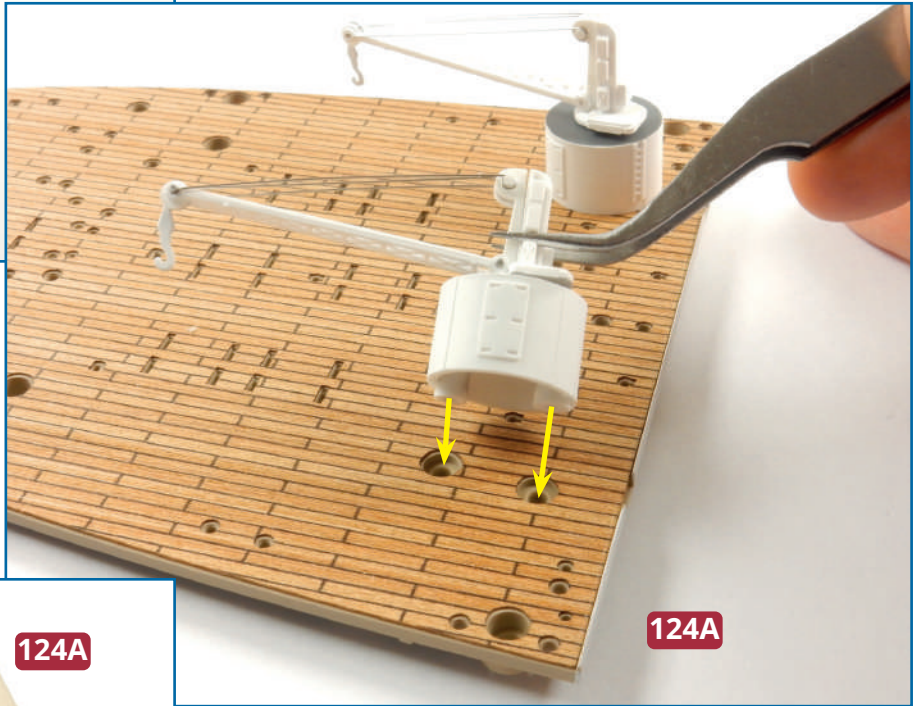
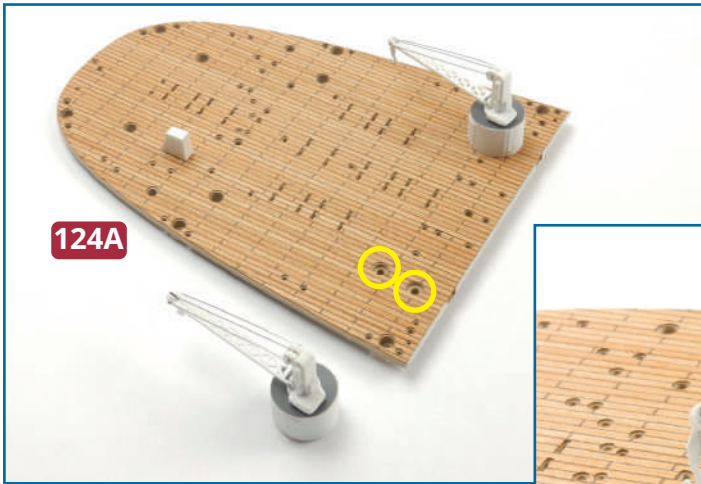

**6** Take the poop deck assembly from the previous issue and identify the fixing point for the crane. Position the crane as shown and fix it to the deck with two **AP** screws.

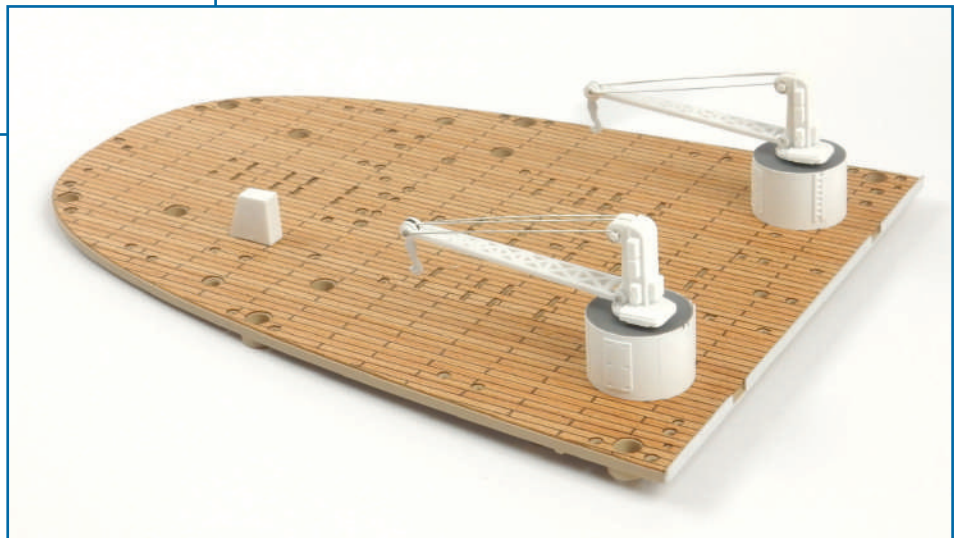



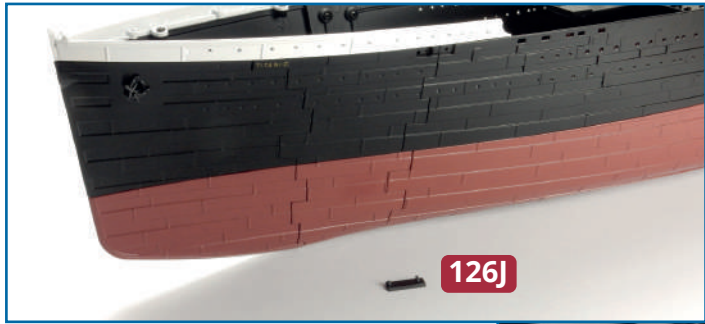

**7** Take the hull assembly and identify the fixing point for the plate **126J** (circled). Check the fit of the plate, then apply a little glue to the pegs on the back of the plate to fix it in place.

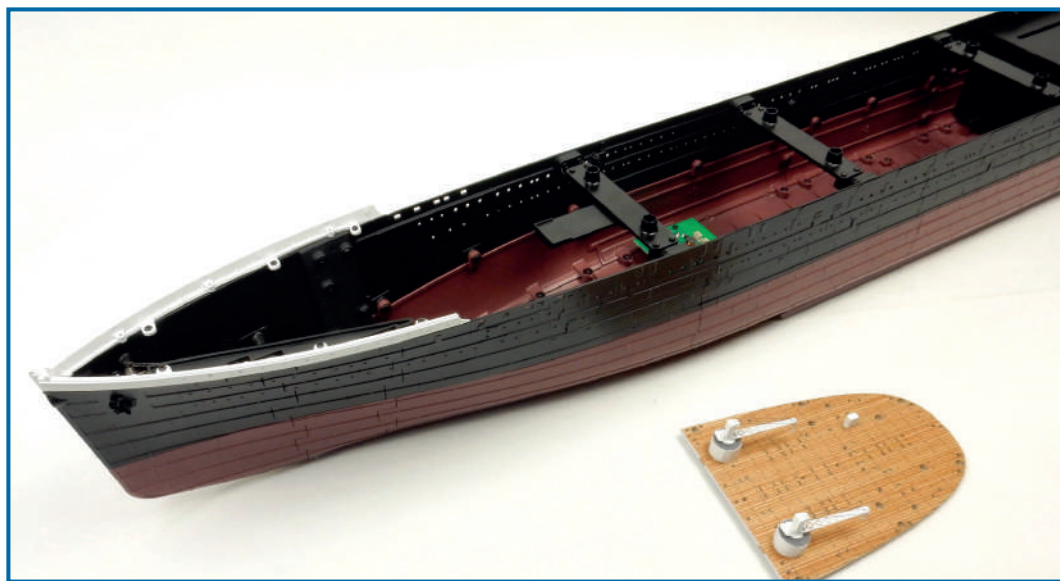
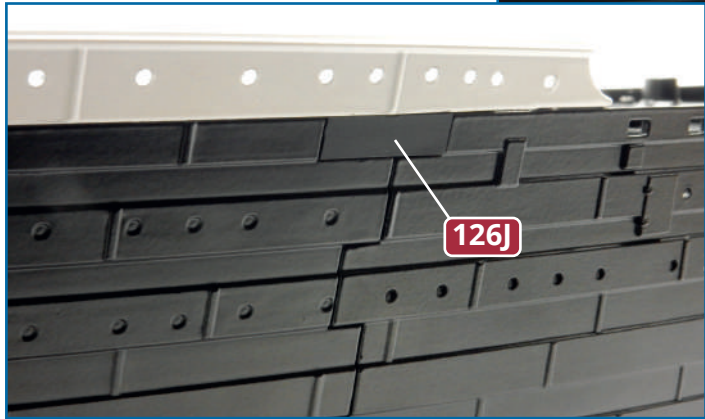
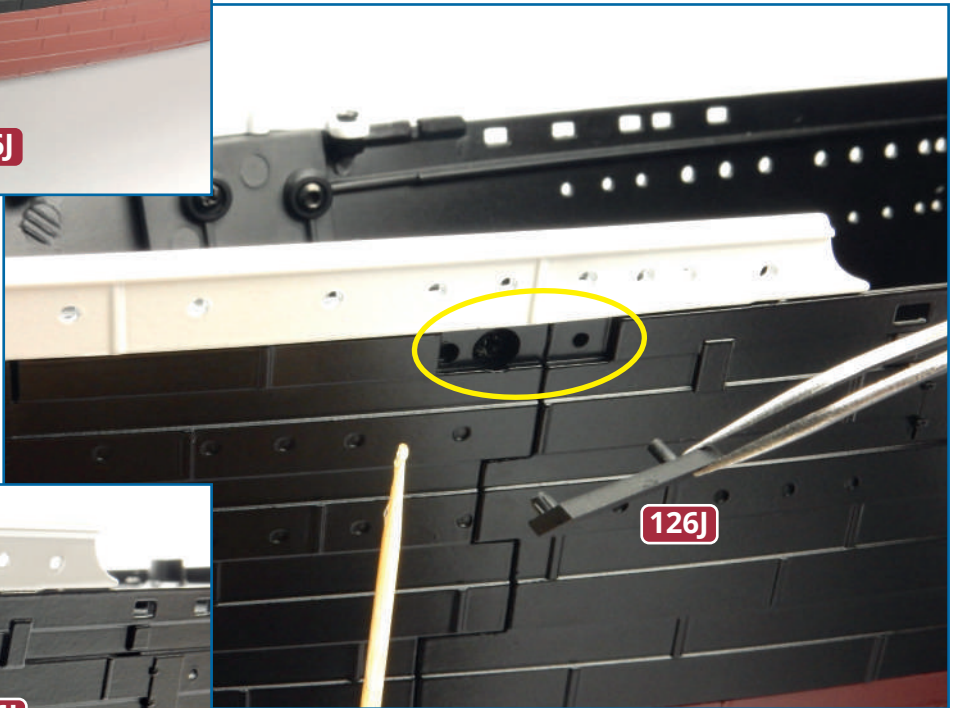

## **Completed work**

The second crane has been fitted to the poop deck and a panel has been fixed to the hull.

# DETAILS FOR THE POOP DECK

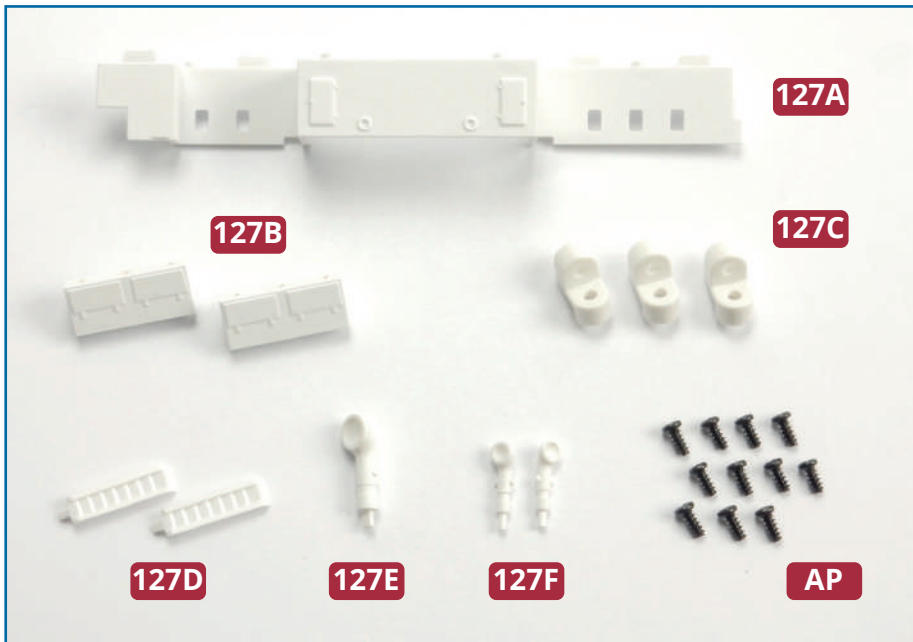

## PARTS IN THIS ISSUE

- 127A** Bulkhead

---

- 127B** Storage box (x 2)

---

- 127C** Connectors (x 3)

---

- 127D** Stairway (x 2)

---

- 127E** Vent A

---

- 127F** Vent B (x 2)

---

- AP** Eleven PB screws (1 spare)

**1** Take the bulkhead **127A** and the three connectors **127C**. Position the connectors on the bulkhead as indicated and fix in place with three **AP** screws.

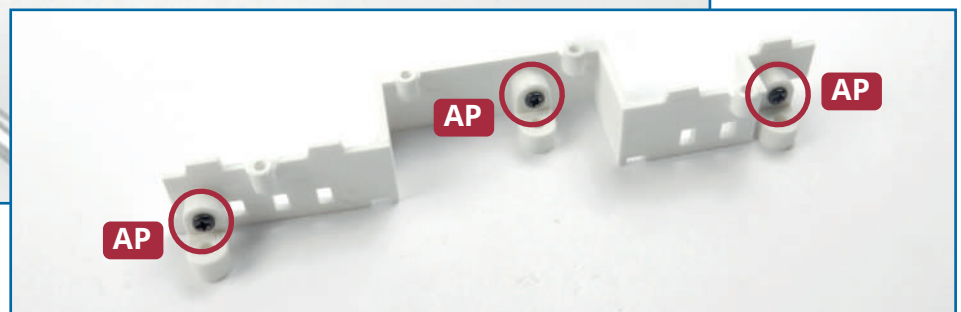
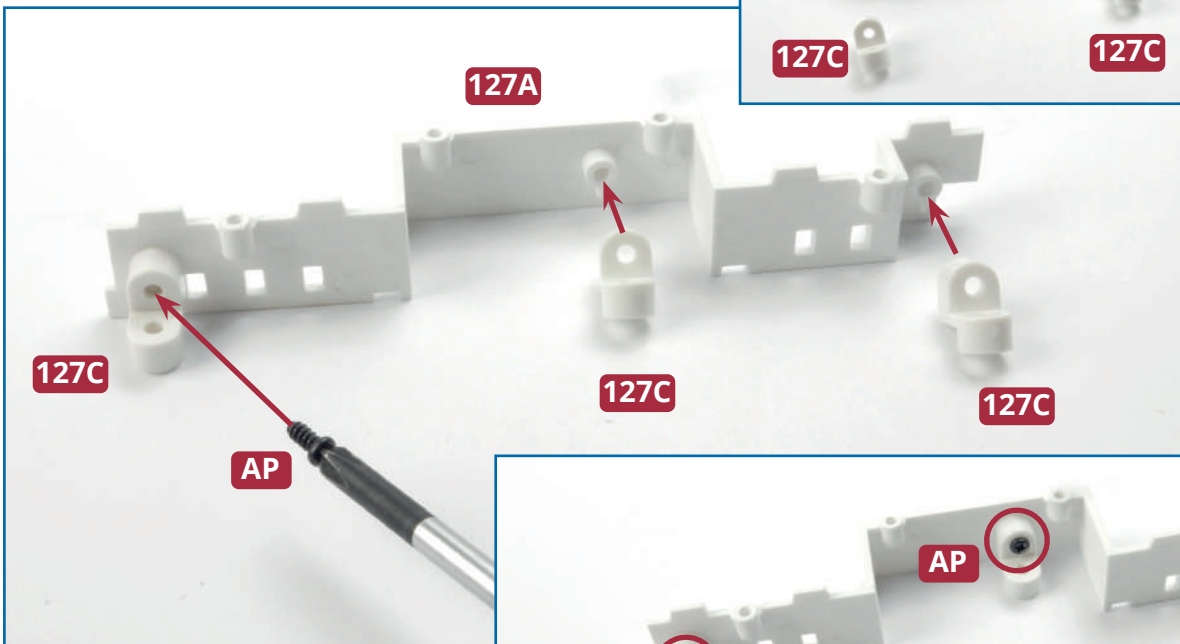
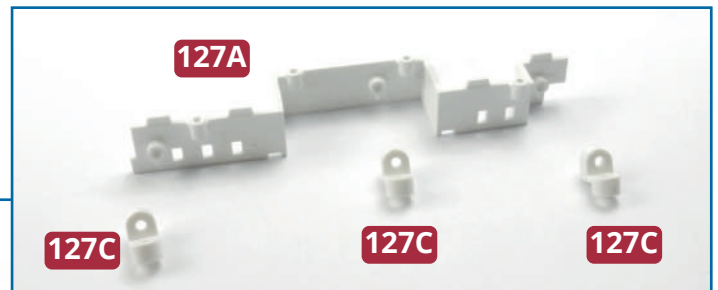



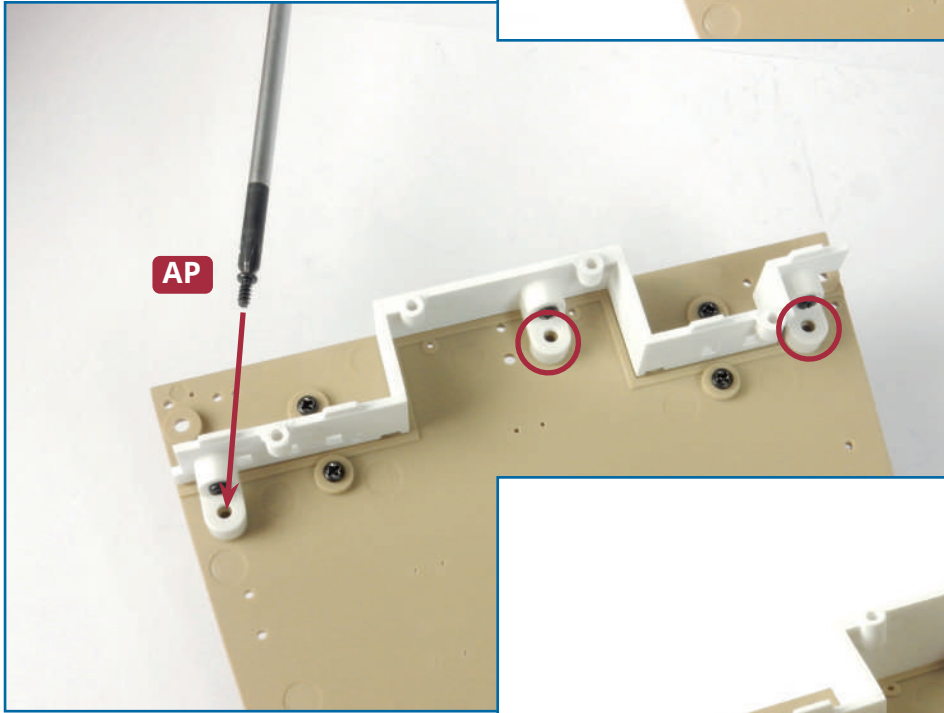
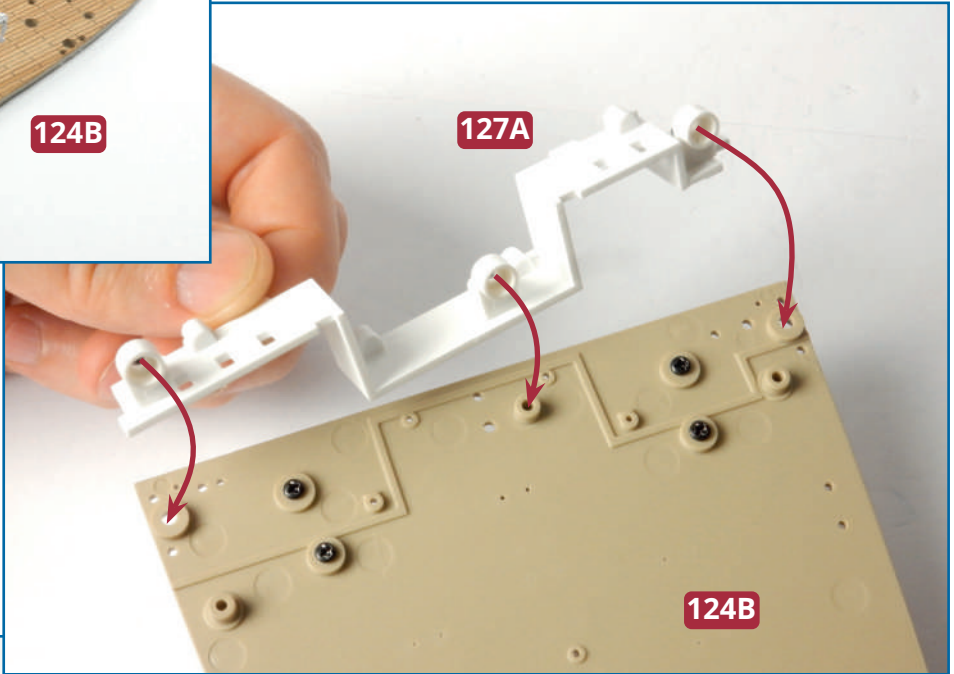
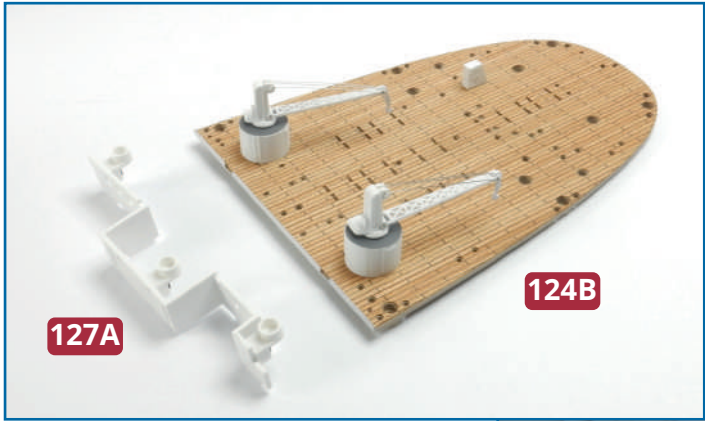

**2** Take the poop deck **124B** and turn it upside down. Fit the bulkhead **127A** along the straight edge of the aft deck, outside the raised rib, and fix it in place with three **AP** screws.

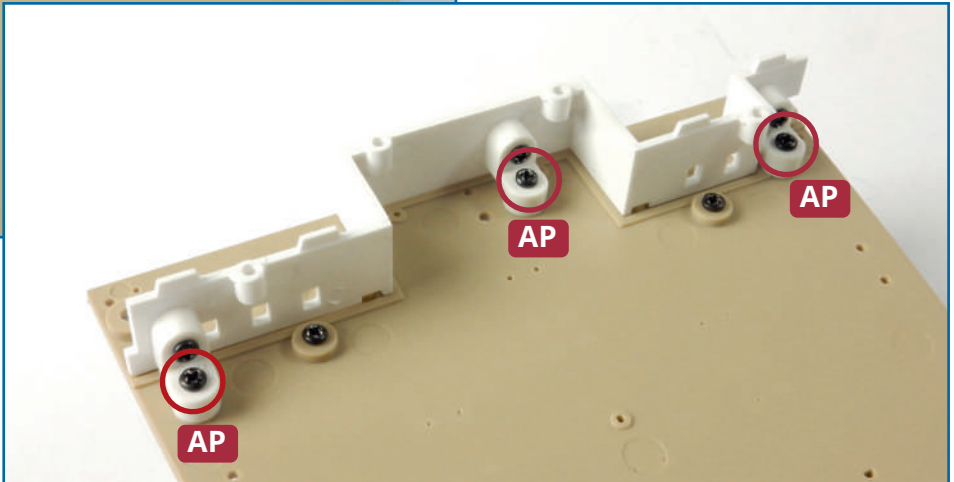



★ STEP-BY-STEP INSTRUCTIONS ★

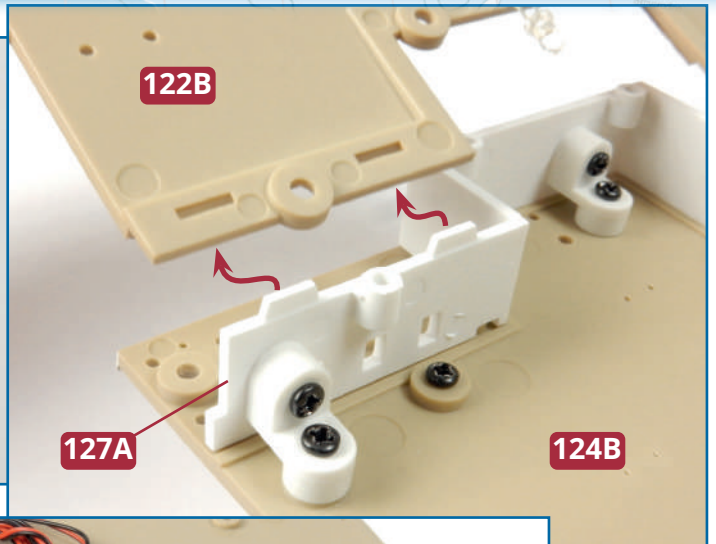
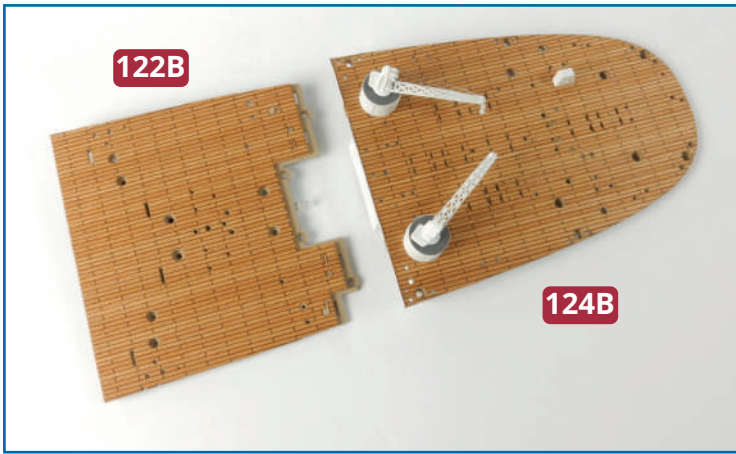

**3** Take the poop deck **124B** and the aft well deck **122B**. With the decks upside down, fit the tabs on the bulkhead **127A** into the slots in the well deck **122B** (circled in yellow, right). Fix the decks together with four **AP** screws (circled in red).

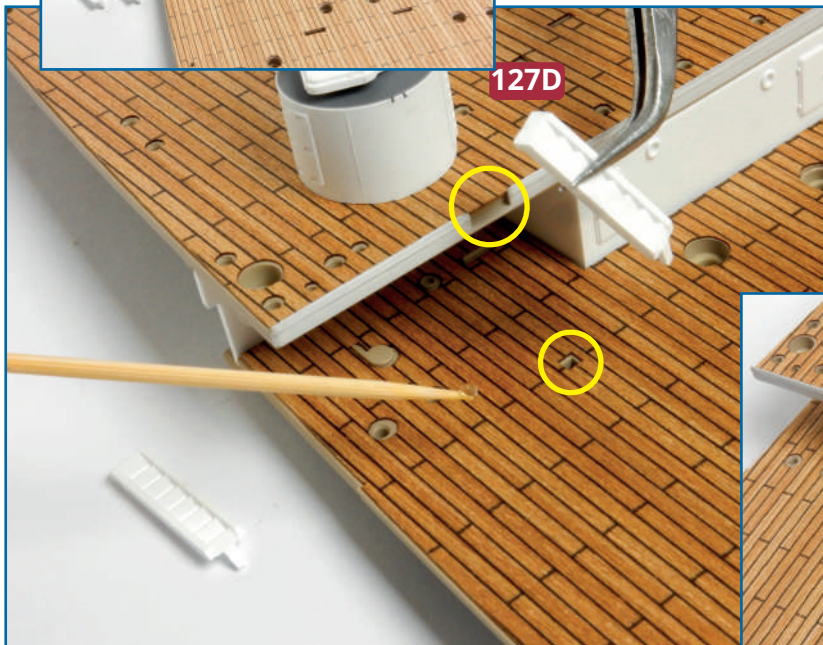
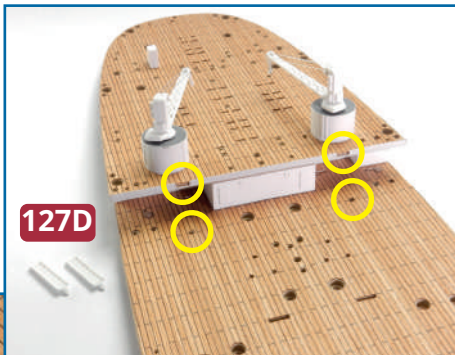
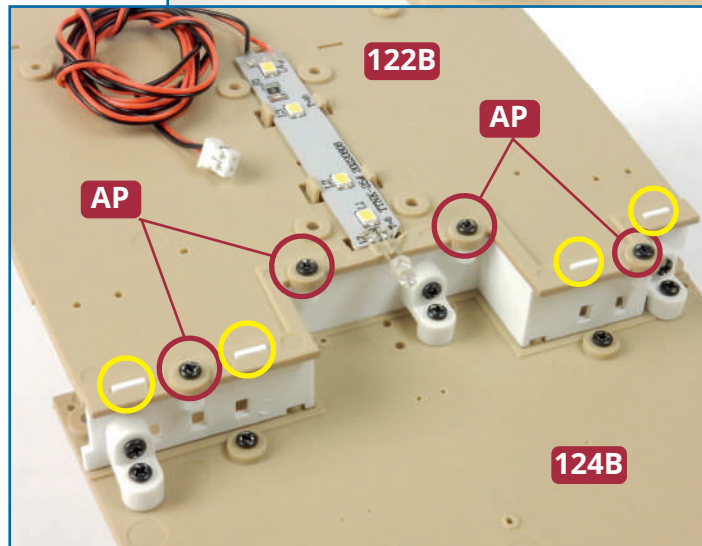

**4** Check the fit of the stairways **127D** near the cranes on the poop deck. Fix the stairs in place with a small amount of glue.

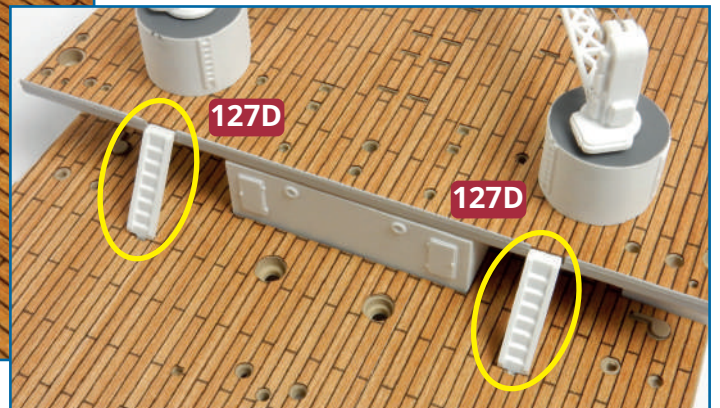



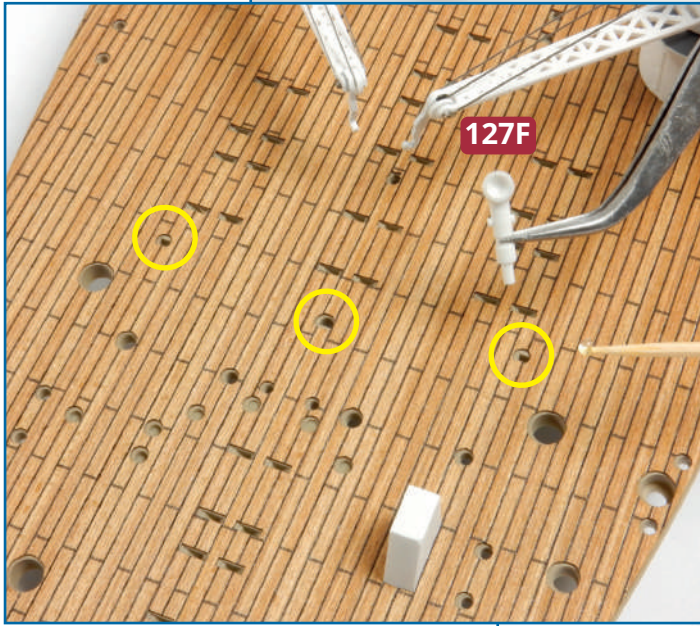
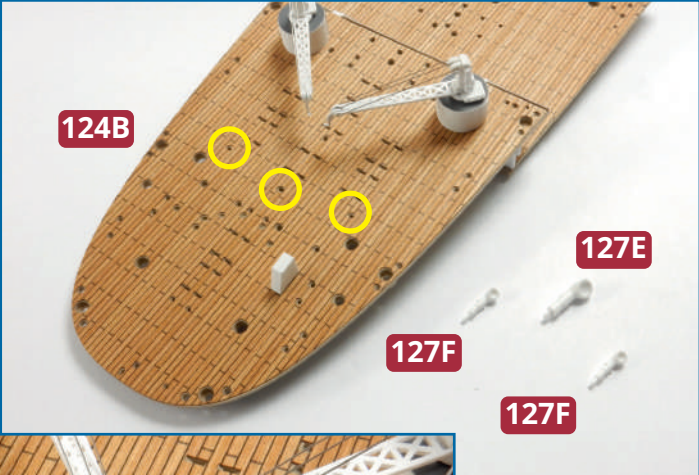

**5** Take the three vents **127E** and **127F**. Identify the fixing points and orientation on the poop deck **124B**, then glue them into the holes in the deck.

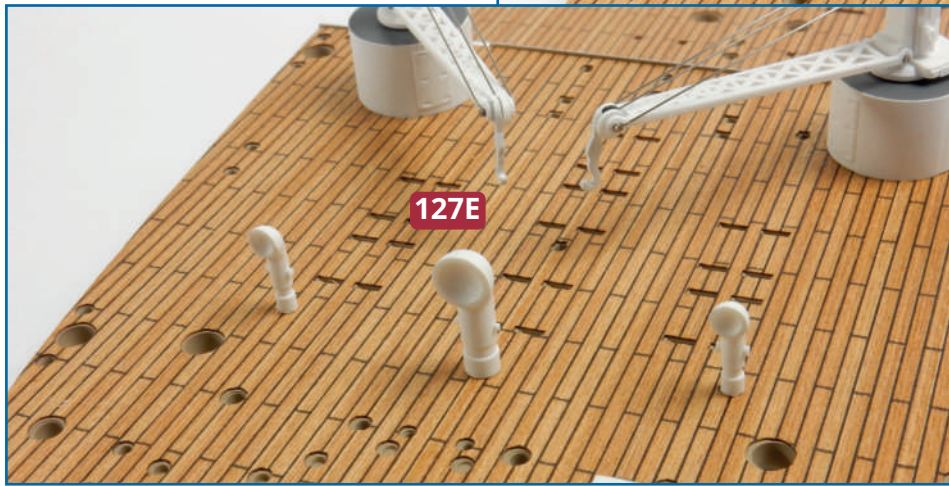



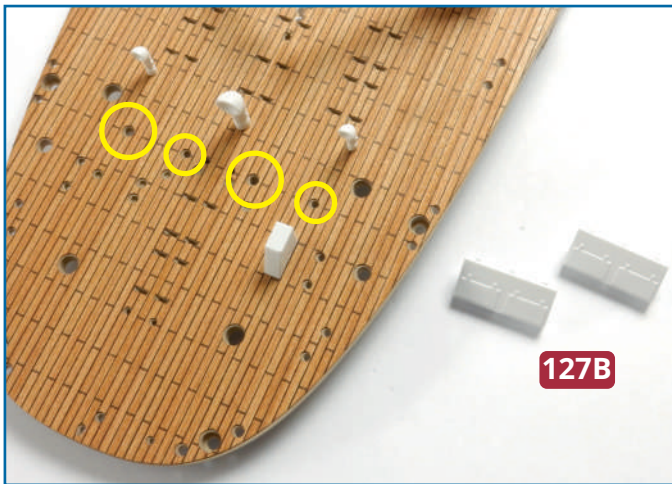

**6** Check the fit of the storage boxes **127B** on the poop deck, and fix in place with a drop of glue.

### Completed work

The poop deck has been joined to the aft well deck and details have been fitted to the poop deck.

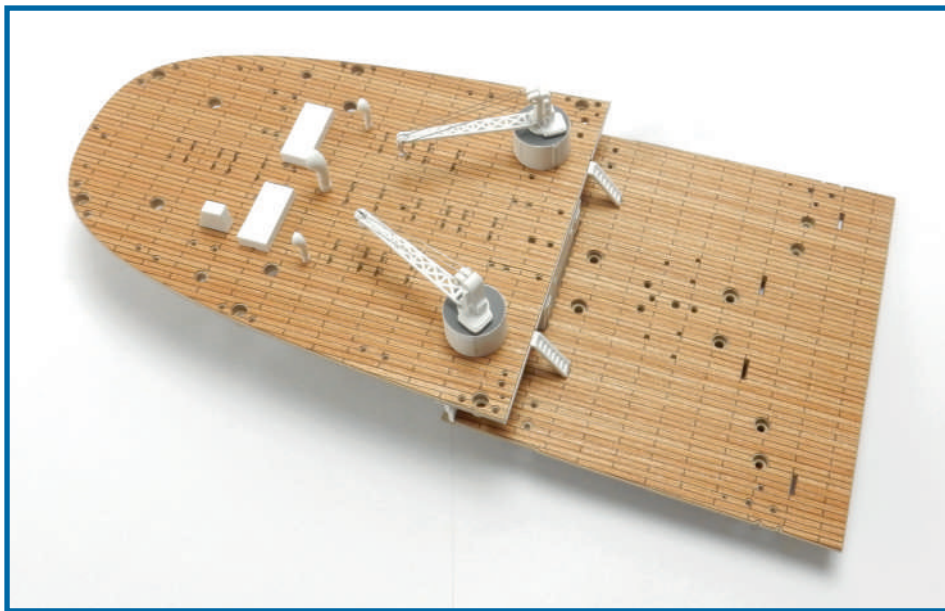





# CRANE FOR THE AFT WELL DECK



## PARTS IN THIS ISSUE

- 128A** Crane boom
- 128B** Crane motor
- 128C** Hook
- 128D** Washer
- 128E** Left tie rod
- 128F** Right tie rod
- 128G** Crane cable
- 128H** Crane upright
- 128J** Plastic pin
- 128K** Long pin
- 128L** Short pin
- 128M** Crane Base
- 128N** Bracket x 2
- AP** Three AP screws (1 spare)
- AM** Five PM screws (1 spare)
- HP** Two PWB screws (1 spare)

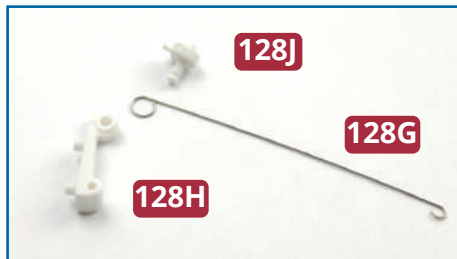

**1** Take parts **128H**, **128J** and **128G**. Fit the large eyelet at one end of the crane cable **128G** on to the peg on the upright **128H**. Fit the plastic pin **128J** to hold it in place. Fix the motor **128B** on the upright **128H**. This is a push-fit connection.

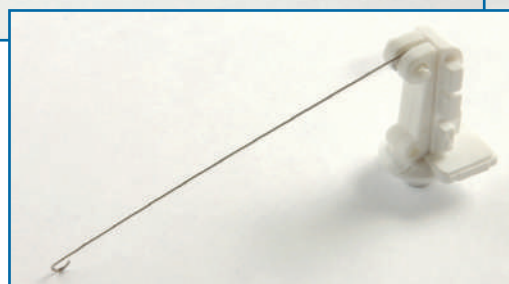
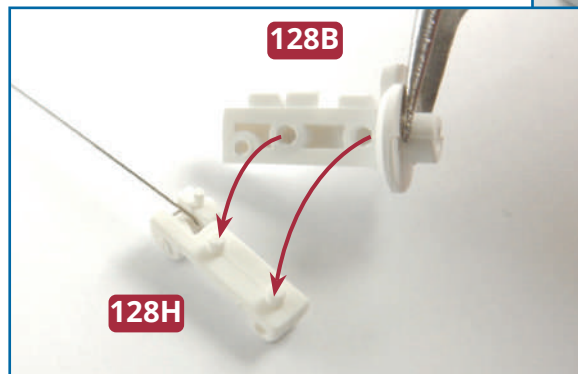
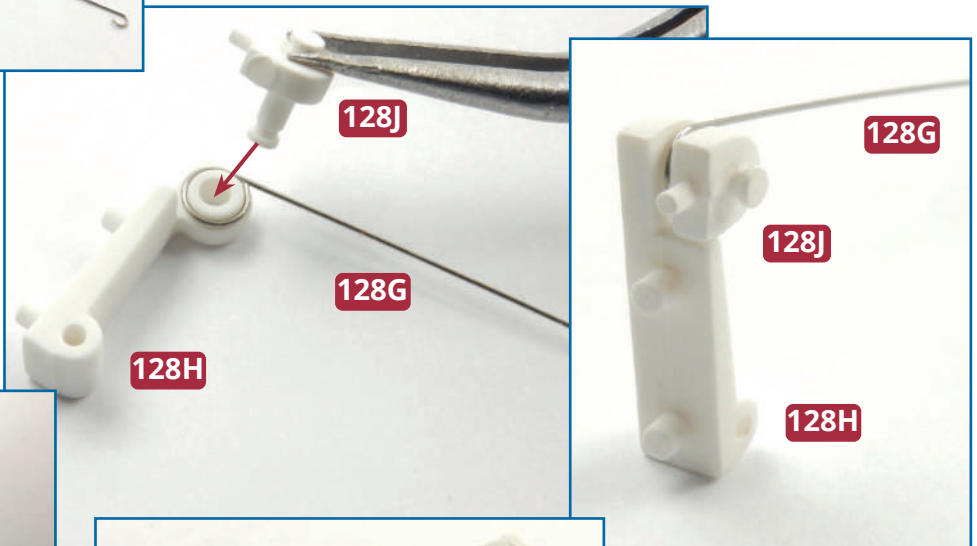

## ★ STEP-BY-STEP INSTRUCTIONS ★

**2** Take the crane boom **128A** and the long pin **128K**. Fit the tabs on the wide end of the boom on either side of the channel at the base of the upright **128H**. Fix in place with the long pin **128K**, fitting the smooth end first. Use a pair of pliers to push the pin in place.

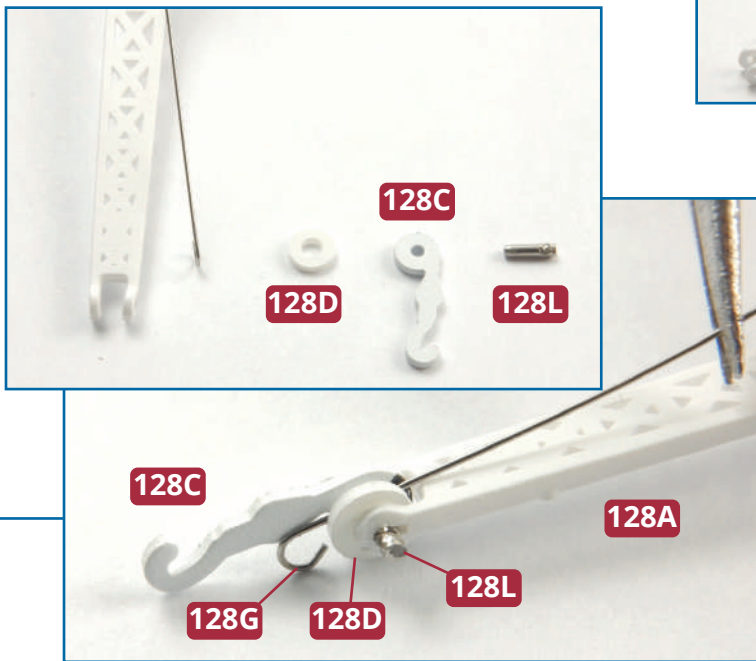
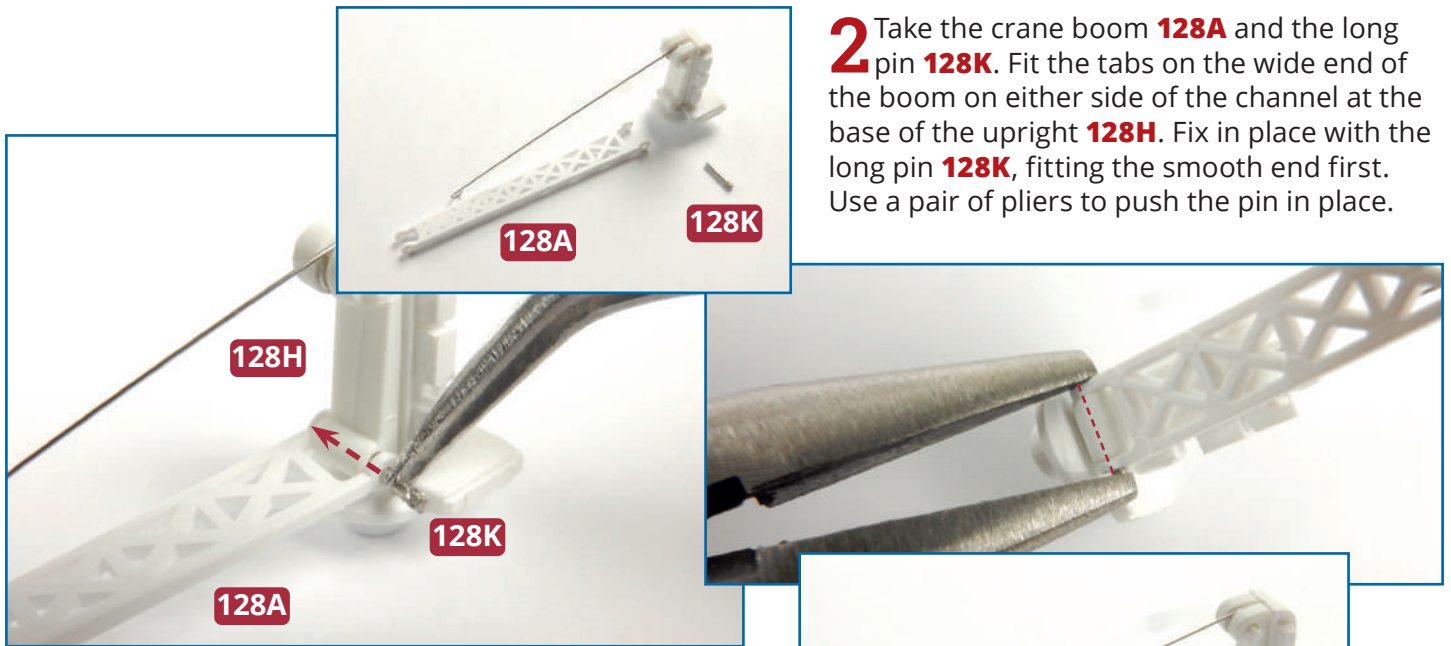

**3** Position the hook **128C** and washer **128D** between the eyelets at the narrow end of the crane boom **128A**. Fit the small eyelet at the end of the cable **128G** between the hook and the washer. Fix in place with the short pin **128L**. Insert the smooth end first and push in place with the pliers.

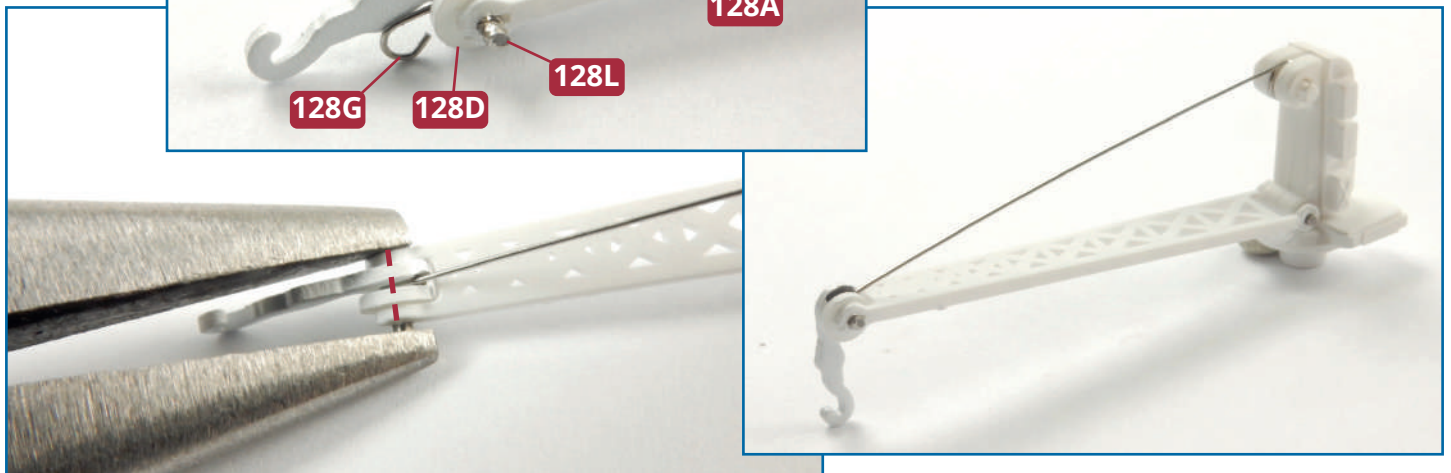



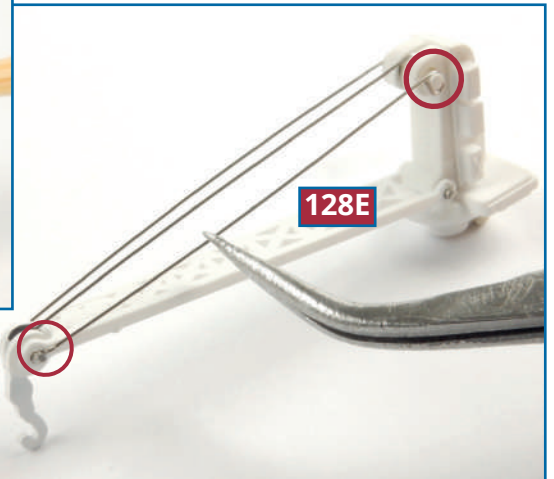
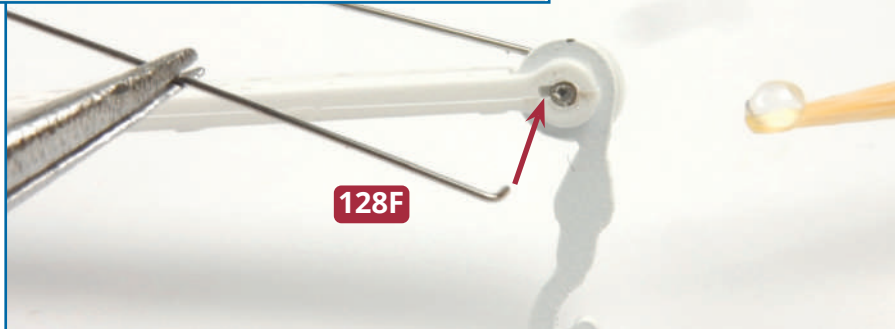
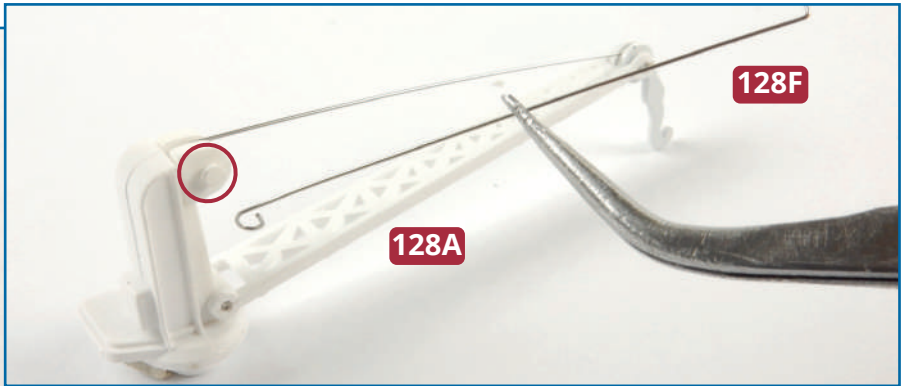
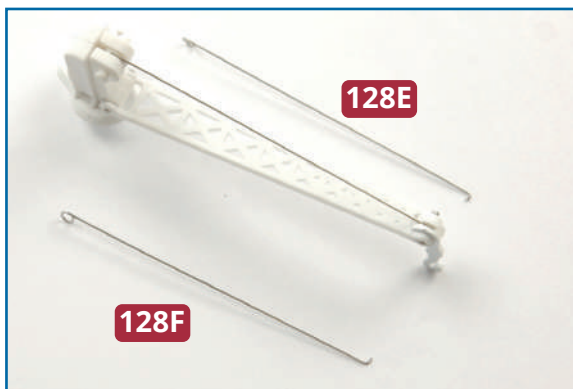

**4** Fit the left and right tie rods **128E** and **128F** so that they run between the upright **128H** and the end of the boom **128A**, as shown. If necessary, fix the ends of the tie rods in place with a drop of glue.

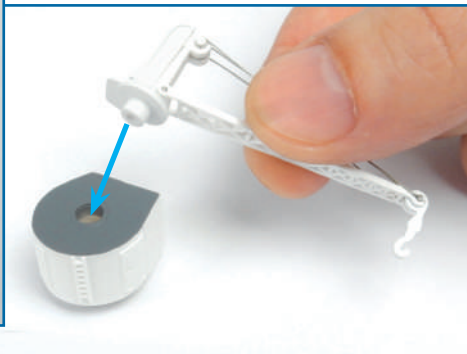

**5** Place the crane assembly on the base **128M** and fix it in place with an **HP** screw. Do not overtighten the screw, the crane must be free to rotate.

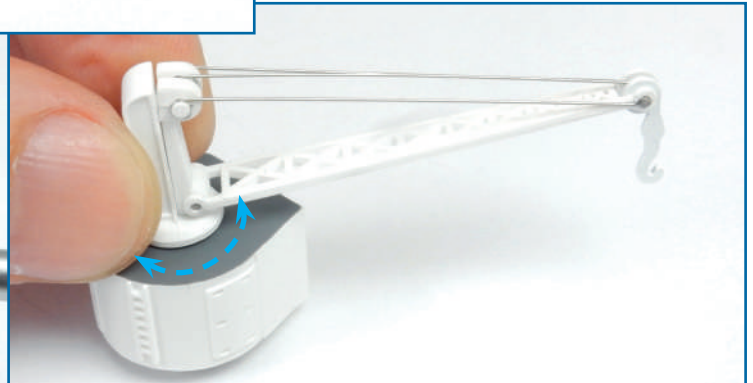
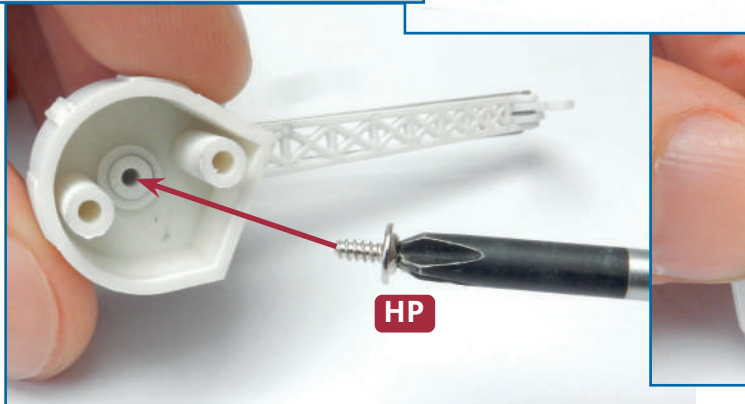

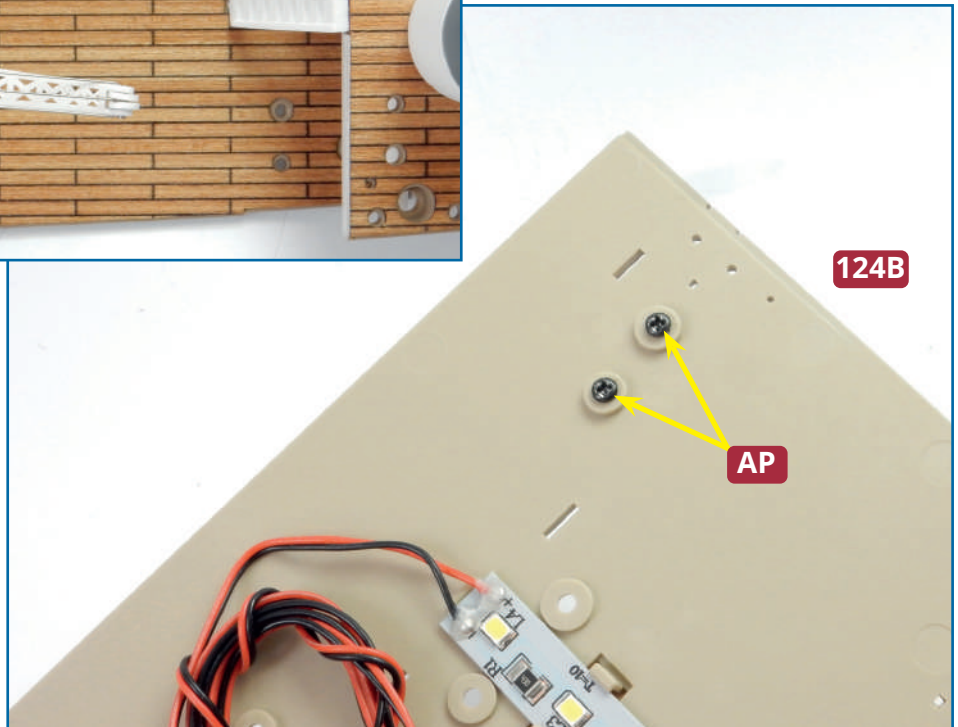
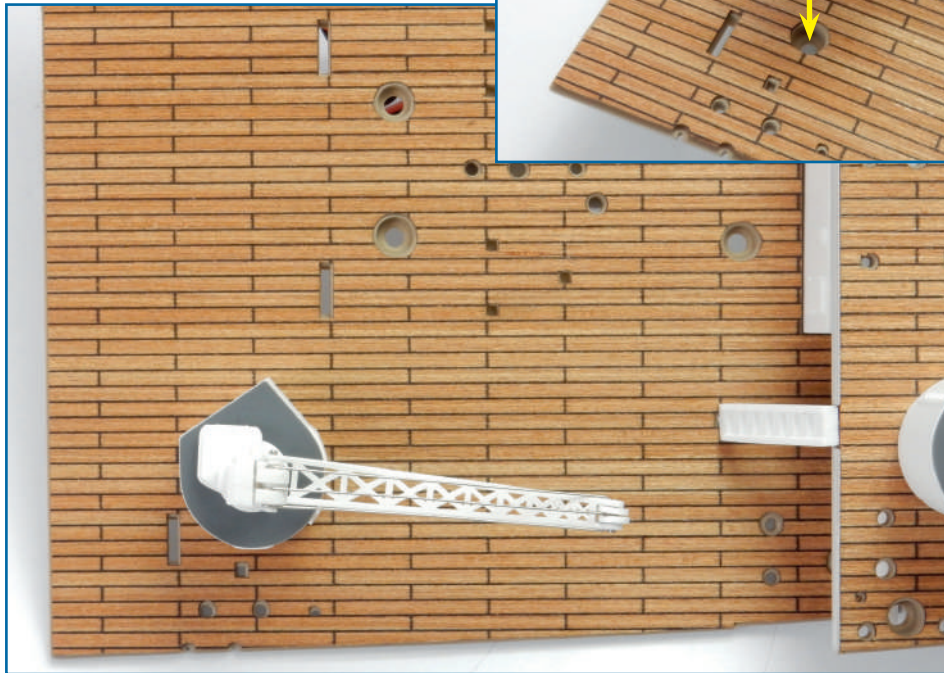
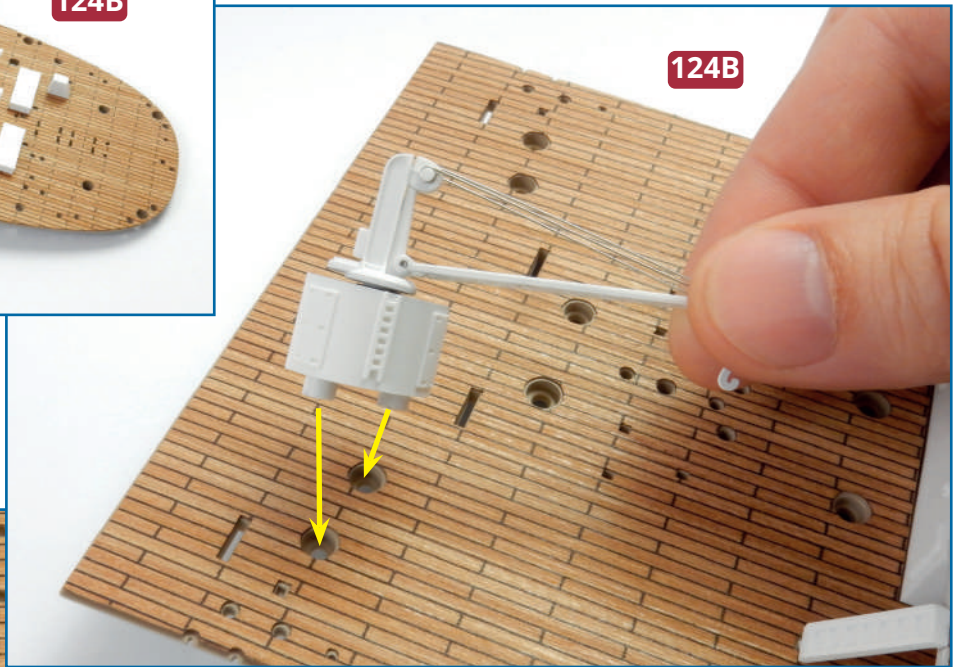
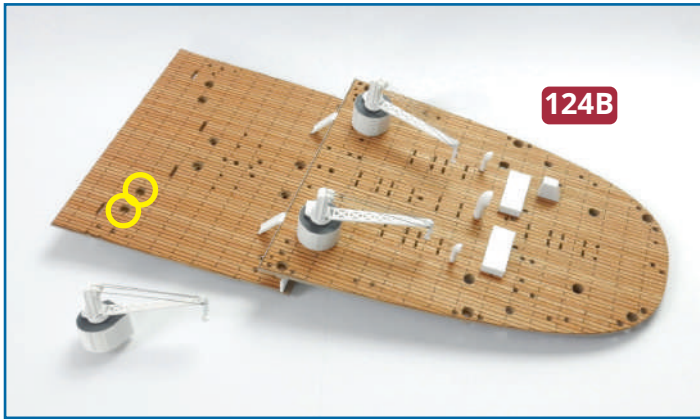

**6** Take the aft deck assembly and identify the holes for the crane on the well deck **124B**. Position the crane as shown and secure it to the bridge from the underside using two **AP** screws.





**7** Take the hull assembly and identify the fixing points for the two **128N** brackets. Position the brackets as shown, then fix each one in place with two **AM** screws.

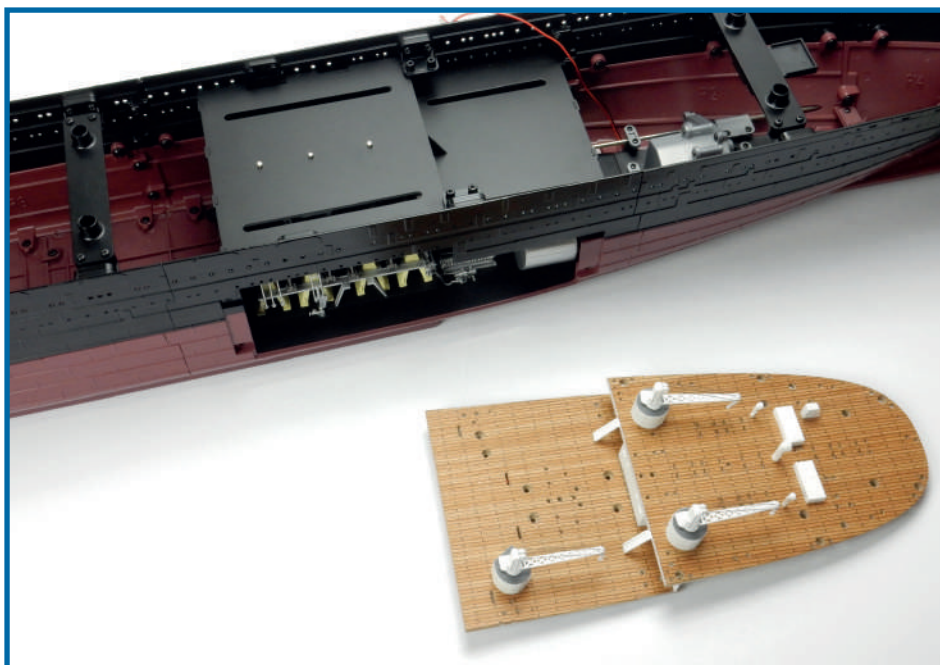
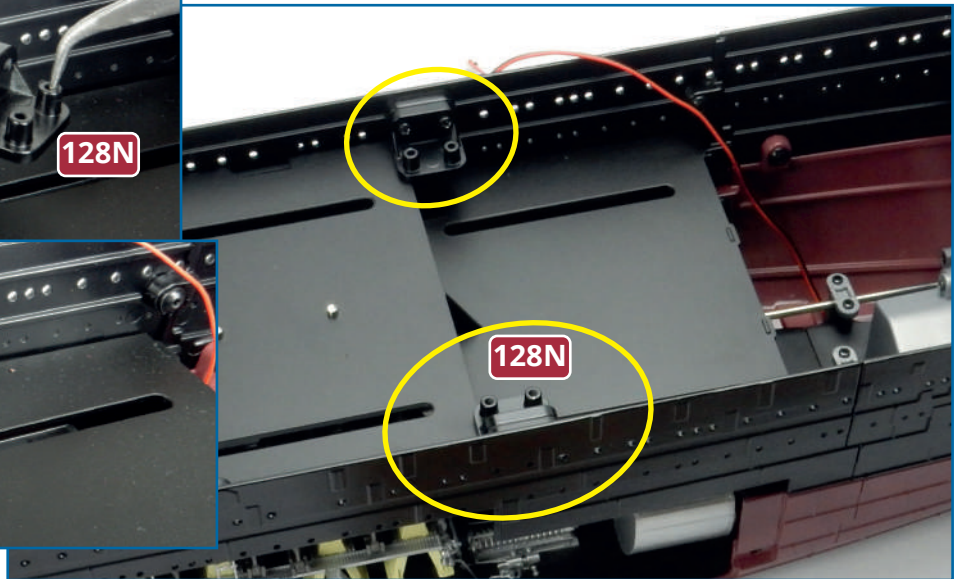
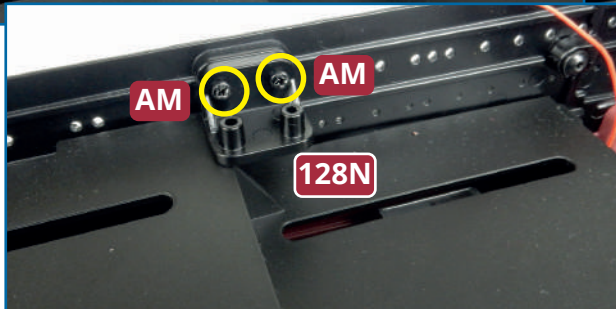
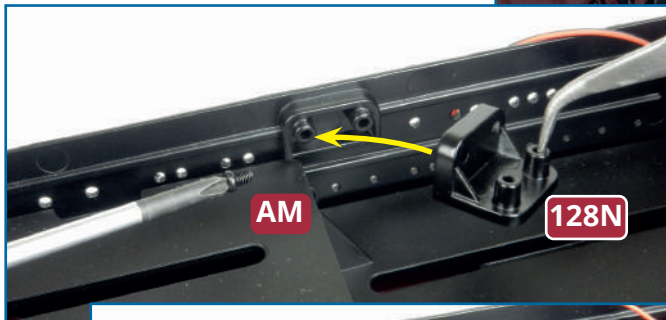
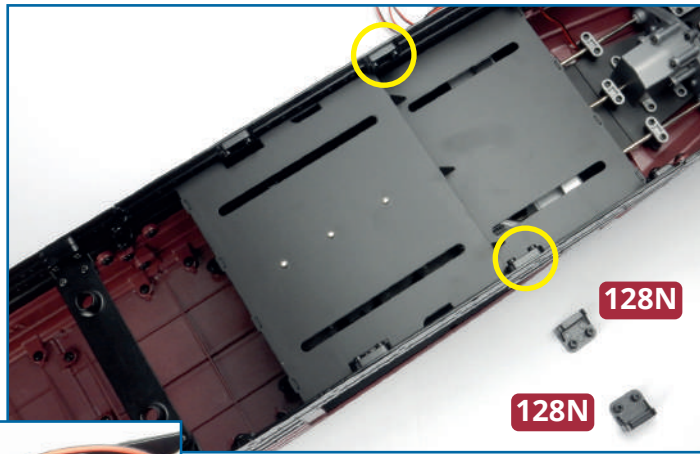

## **Completed work**

A crane has been fitted to the aft well deck and two brackets have been fitted to the hull.