

Ferrari

250 GTO



Pack 09

BUILD INSTRUCTIONS

**STAGE 65: ADDITIONAL
RADIATOR COMPONENTS**

**STAGE 66: THE ANTI-ROLL BAR
AND TWO PEDAL RODS**

STAGE 67: THE CAR HORN SYSTEM

STAGE 68: THE REAR SECTION OF THE BODY

STAGE 69: THE REAR LEFT WHEEL (1)

STAGE 70: THE REAR LEFT WHEEL (2)

STAGE 71: THE REAR LEFT WHEEL (3)

STAGE 72: THE REAR LEFT WHEEL (4)

Advice from the experts

To help you get the best out of building the Ferrari 250 GTO, we've prepared a modellers checklist with hints, tips and advice from our experts. The information below is aimed at making your build as enjoyable and professional as possible right from the start.

Have a soft cloth ready to place on your work surface to prevent scratching the paintwork.

Spare screws are included with each part. Occasionally, you may be instructed to keep spare or unused screws for a later stage. Keep these spares in a safe place and label them correctly.

Please make sure you don't mix up the screws. They look quite similar, but the threads do vary slightly. Using the wrong screws may damage the parts.

When securing parts together using multiple screws, fit each screw loosely to ensure all the parts are correctly aligned before gently tightening them firmly, but not overtight, in the order in which you placed them.

The screwdriver can be magnetized by stroking it with a magnet (fridge magnet, etc.) enabling it to hold the screws and make assembly easier.

If a screw is tight going into a metal part, do not force it as you may shear the head off. Remove it and put a tiny smear of Vaseline, soap or light oil on the thread. That will lubricate it and make it easier to drive home.

Only use the correct size screwdriver that fits the screw head firmly.

Use a magnet to help find screws that have fallen on the floor.

Use masking tape to hold parts temporarily in place.

Cut parts from a sprue (framework) with side cutters or a craft knife. Side cutters tend to be easiest.

During the course of this build, you will receive many pieces that you will assemble immediately – following the instructions in the corresponding stage – and other pieces that you should store safely to one side, for use in future assembly stages.

Left and Right! When building your *Ferrari 250 GTO*, the left- or right-hand side refers to that side as if you are sitting in the car.



WARNING: Some parts are assembled using magnets. These magnets can cause serious injury if they are swallowed. Keep away from children. If you suspect a magnet has been swallowed, seek medical help straight away.

All parts belong to a kit. Collectors item for adults.

Not suitable for children under 14.

Produced under license of Ferrari S.p.A. The name FERRARI, the PRANCING HORSE device, all associated logos and distinctive designs are property of FERRARI S.p.A. The body designs of the Ferrari cars are protected as Ferrari S.p.A. property under design, trademark and trade dress regulations.

Stage 65: Additional Radiator Components

In this stage you'll continue working on your model's radiator.



STAGE 65 PARTS LIST

Name	Name
1 Chassis cross member	6 Curved hose
2 Central panel	7 Rod
3 Front panel	
4 Radiator hose	
5 Flexible hose	5 type B screws

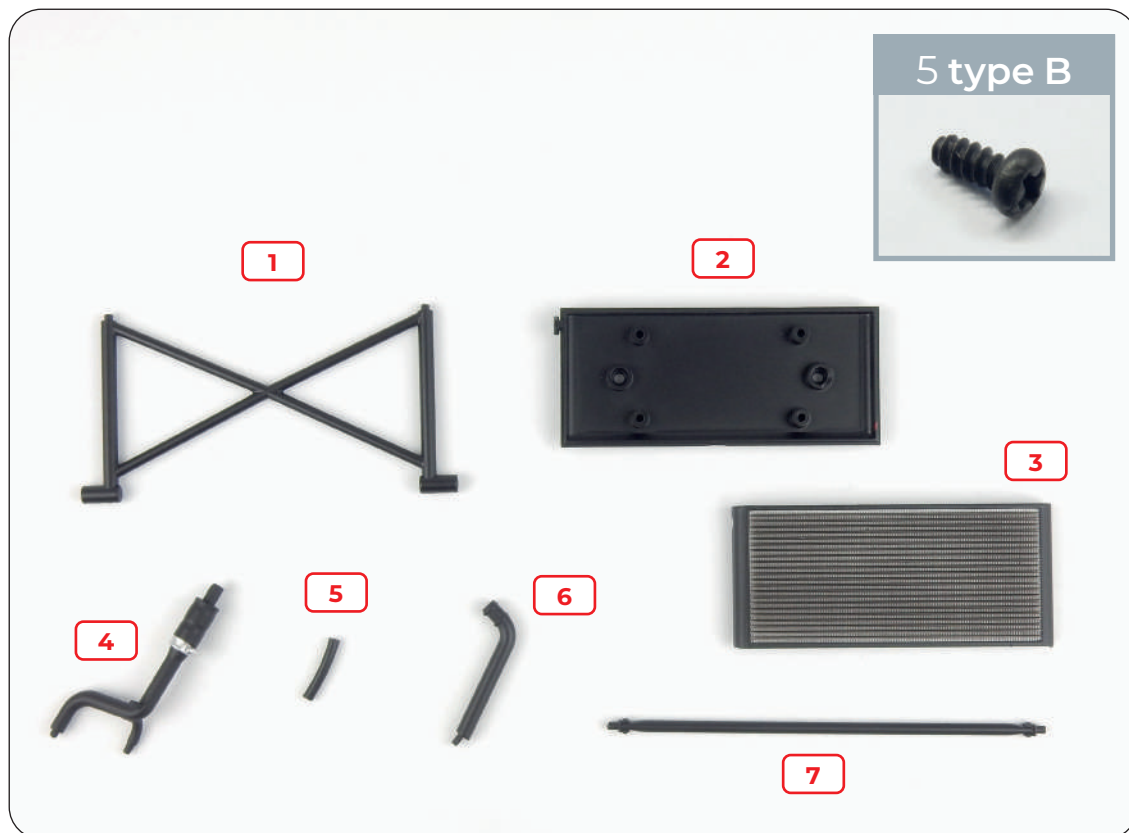

Stage 65: Additional Radiator Components

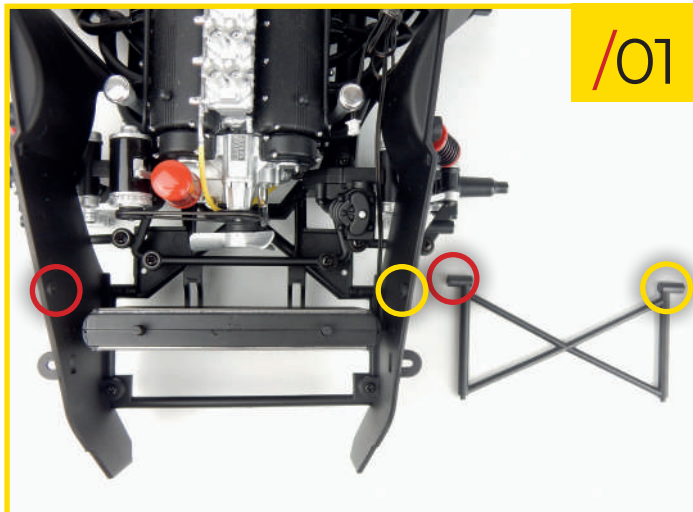

/01

65/01 Fit the chassis cross member by inserting the studs on each side into the holes in the two inner wings (circled) and the two pins on the bottom into the chassis. Look at the photo carefully to orientate the pieces correctly.

65/02 Secure the pieces together by screwing two type B screws into the holes indicated.

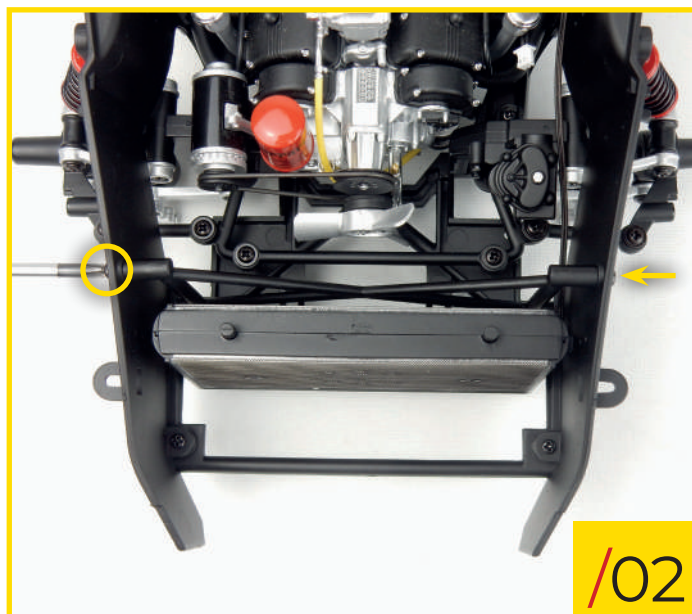

/02

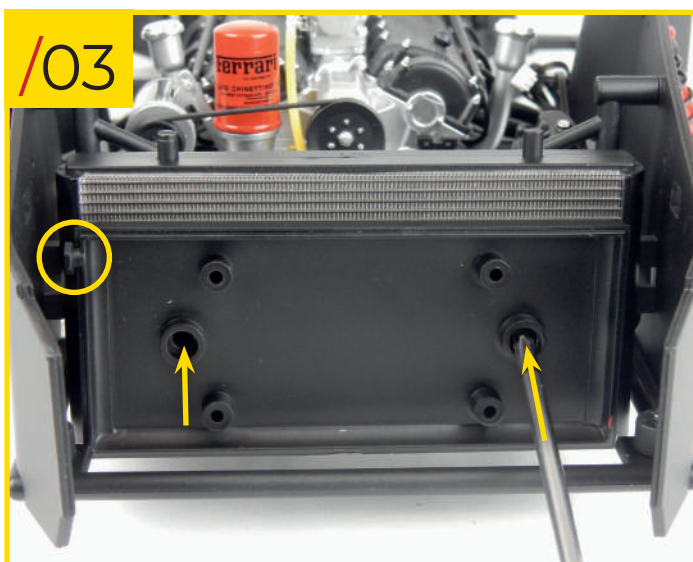

/03

65/03 Fit the central panel to the rest of the radiator, orientating the pieces as shown. Secure everything together by screwing two type B screws into the holes indicated.

65/04 Firmly press the front panel onto the rest of the radiator, orientating the pieces as shown in the photo.



/04

Stage 65: Additional Radiator Components



65/05 Slide the flexible hose onto the stud on the short end of the radiator hose.



65/06 Fit the radiator hose to the radiator header that you received with stage 64.



65/07 Carefully press the header onto the rest of the radiator. Orientate the pieces as shown in the photo.



65/08 Slide the other end of the flexible hose onto the stud on the engine block, as highlighted in the photo.

Stage 65: Additional Radiator Components

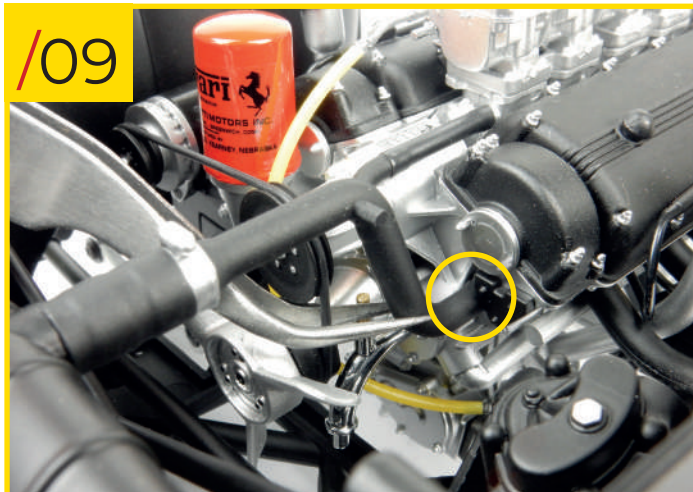

65/09 Insert the stud on the other end of the radiator hose into the hole on the left side of the timing chest.

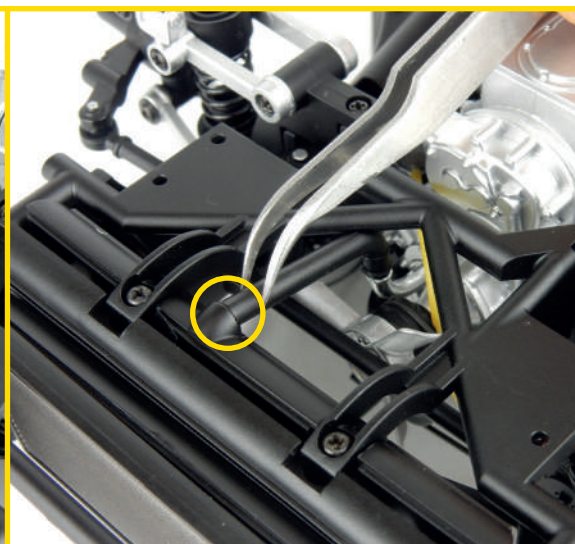
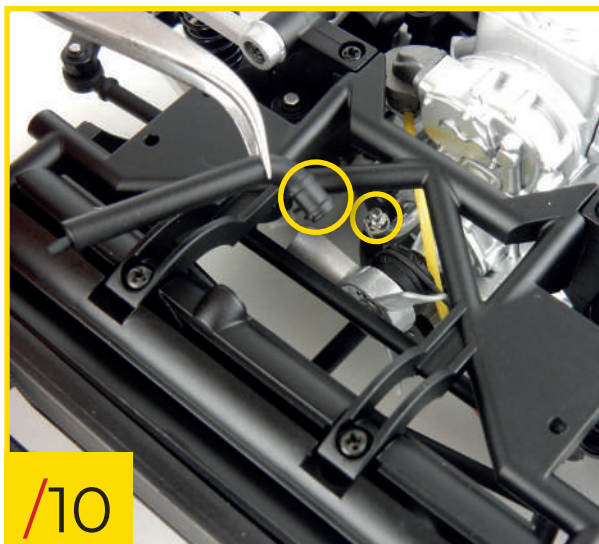

65/10 Turn the chassis over and use the curved hose to connect the water pump to the radiator's back panel.

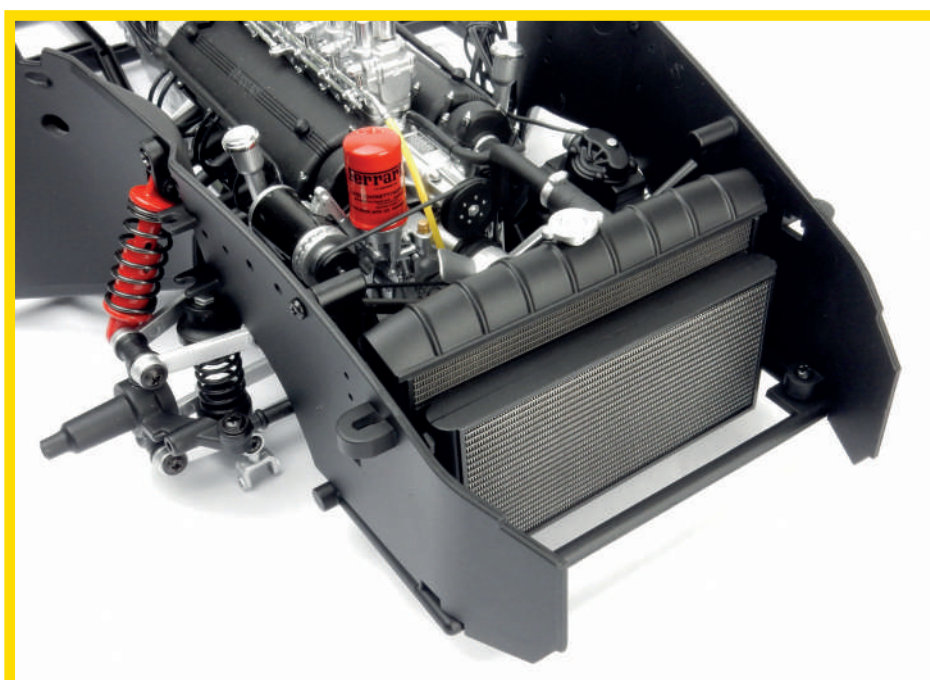

STAGE 65 IS COMPLETE
Here's how your model's radiator looks at the end of this assembly phase. Put the rod somewhere safe, you'll need it for a later stage.

Stage 66: The Anti-Roll Bar and Two Pedal Rods

In this stage you'll continue working on your model's chassis by adding the anti-roll bar and the rods for the clutch and brake pedals.



STAGE 66 PARTS LIST

Name	Name
1 Anti-roll bar	5 Clutch rod (L)
2 Bracket tops	6 Brake rod (R)
3 Bracket bottoms	
4 Pedal rod bracket	2 type B screws

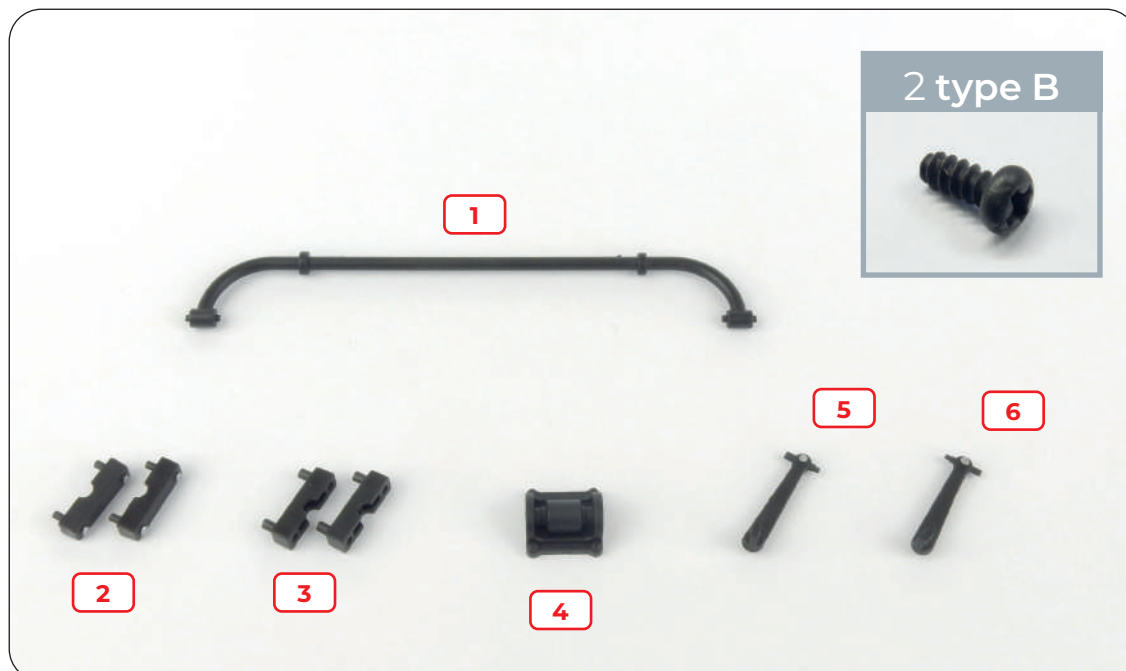

Stage 66: The Anti-Roll Bar and Two Pedal Rods

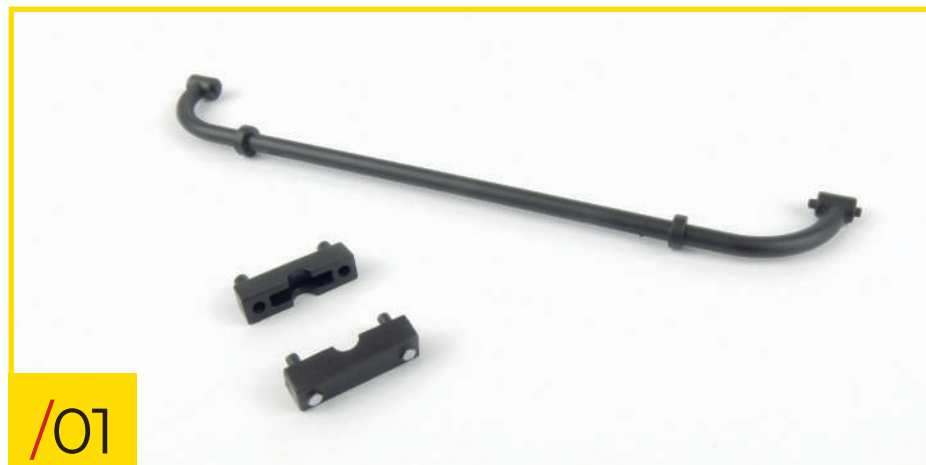

66/01 Place the anti-roll bar, one bracket top and one bracket bottom on your work surface.

66/02 Insert the ring at one end of the bar into the bracket bottom, then add the bracket top to complete the assembly.

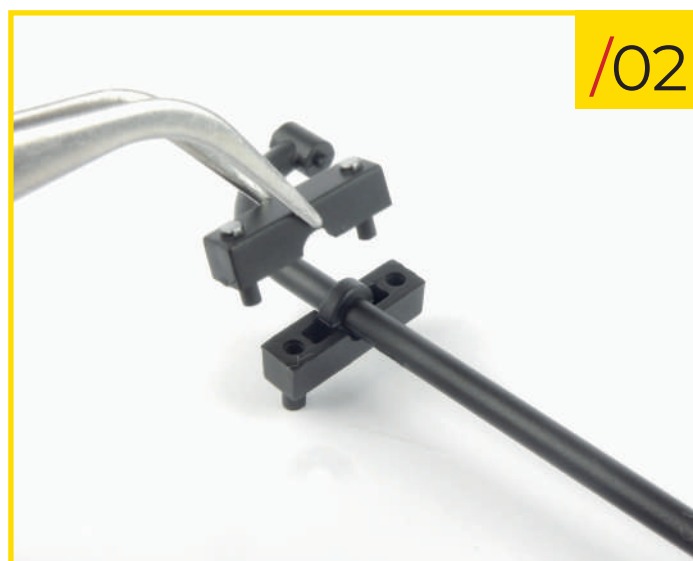

66/03 Fit the two halves of the other bracket onto the ring at the other end of the anti-roll bar.

66/04 Retrieve your model's chassis and place it upside down on your work surface. Look at the photo carefully to orientate the pieces correctly and fit the bar to the chassis by applying some light pressure to the ends of the bar, pushing them into the fork brackets on the suspension.

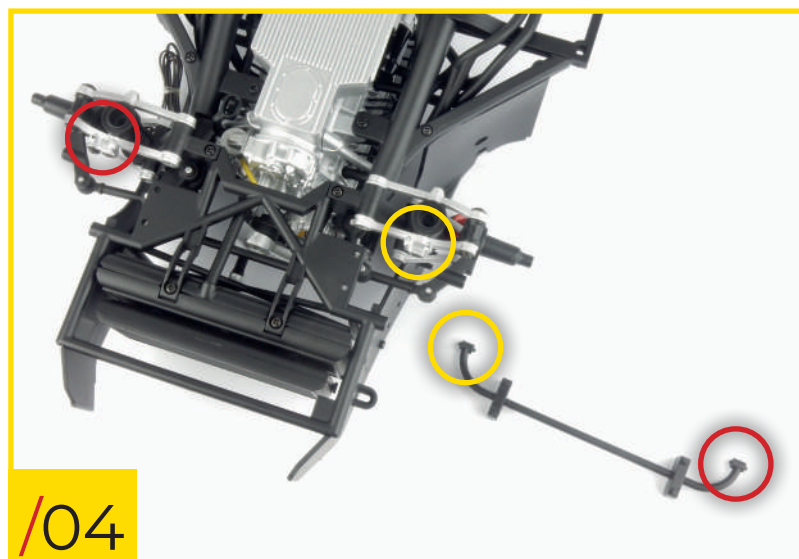

Stage 66: The Anti-Roll Bar and Two Pedal Rods

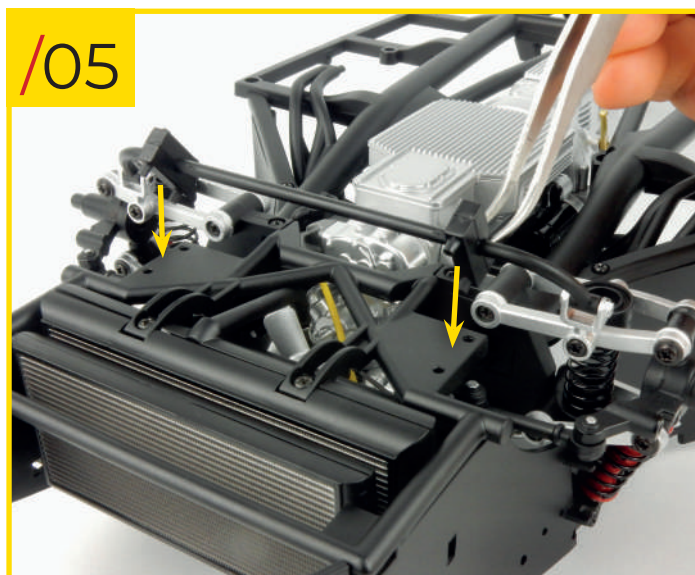

66/05 Insert the studs on the brackets into the respective holes in the chassis, as shown in the photo.

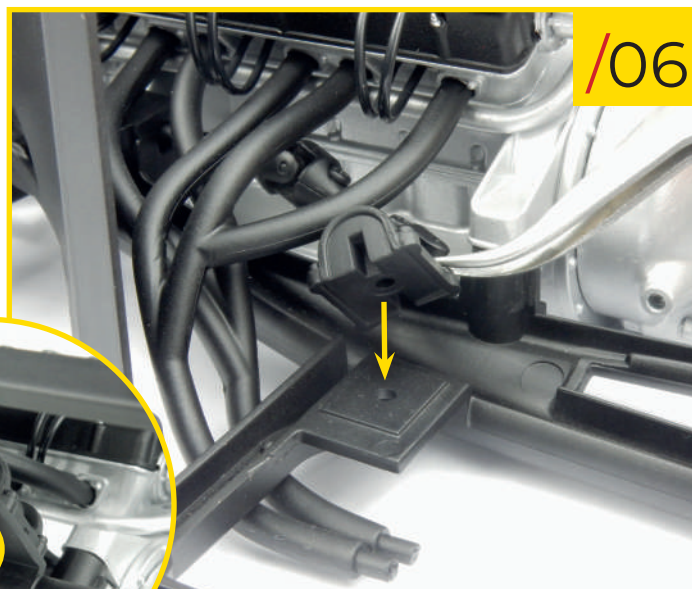

66/06 Now place the pedal rod bracket onto its position on the chassis, as shown. Secure the pieces together using a type B screw.



66/07 Fit the clutch pedal rod (marked with the letter "L") to the pedal rod bracket.

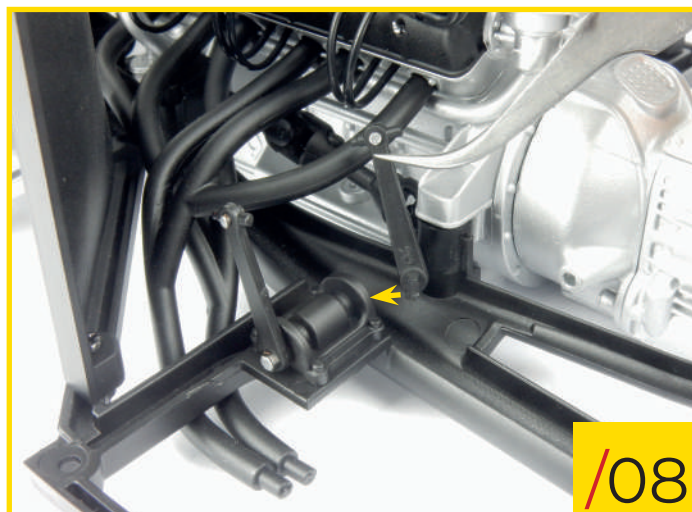

66/08 Fit the brake pedal rod (marked with the letter "R") to the pedal rod bracket.

Stage 66: The Anti-Roll Bar and Two Pedal Rods

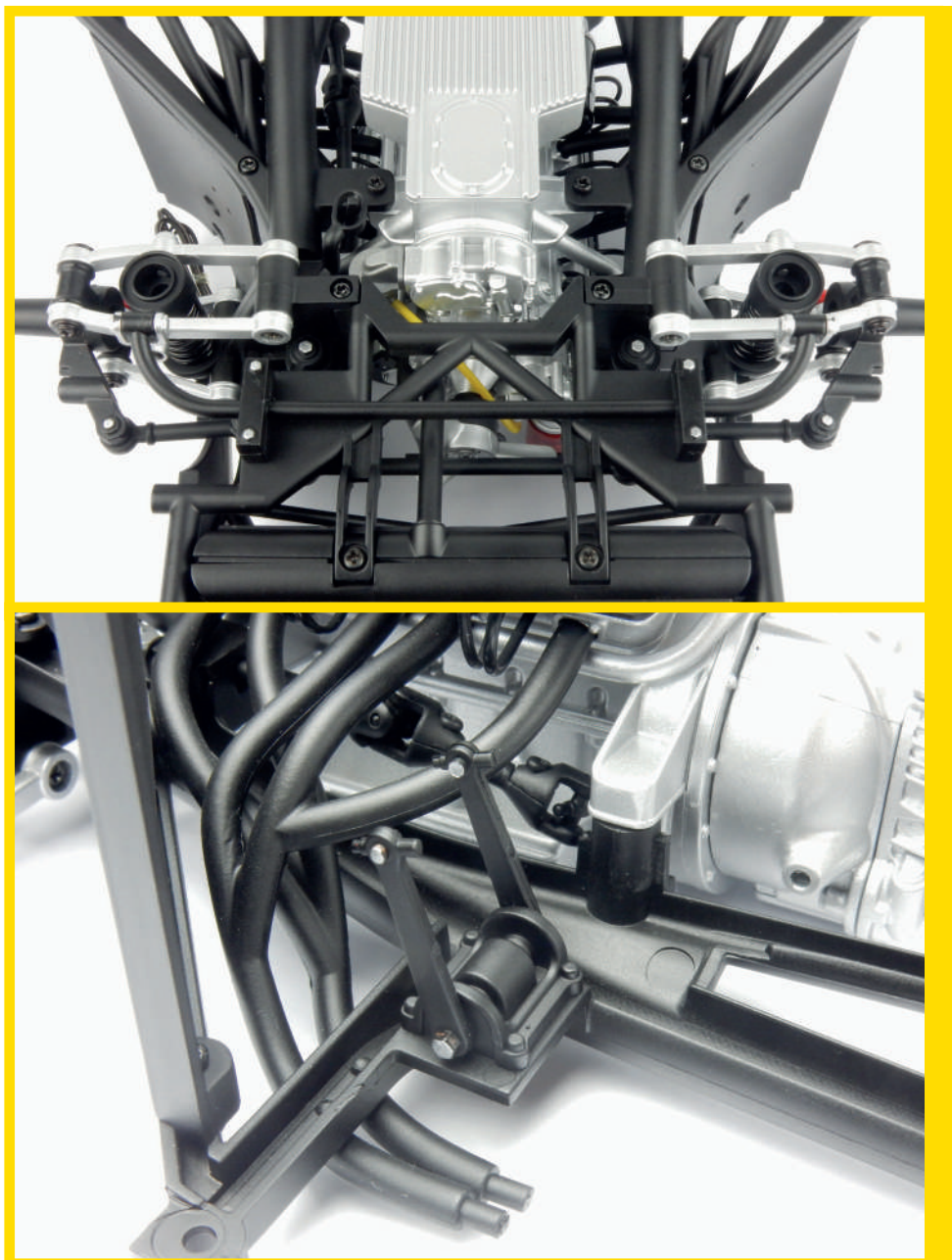

STAGE 66 COMPLETE
Here's how the anti-roll bar and the rods for the clutch and brake pedals look after they've been correctly fitted to the chassis.

Stage 67: The Car Horn System

In this stage you'll start installing some of the components for the engine compartment, such as the car horn system and the windscreen washer fluid reservoir. You'll complete their installation during the following stage.



STAGE 67 PARTS LIST

Name	Name
1 Horns	7 Short tube
2 Horn caps	8 Y connector
3 Compressor bracket	9 Windscreen washer fluid reservoir
4 Compressor body	10 Reservoir cap
5 Compressor cover	
6 Long tubes	2 type B screws

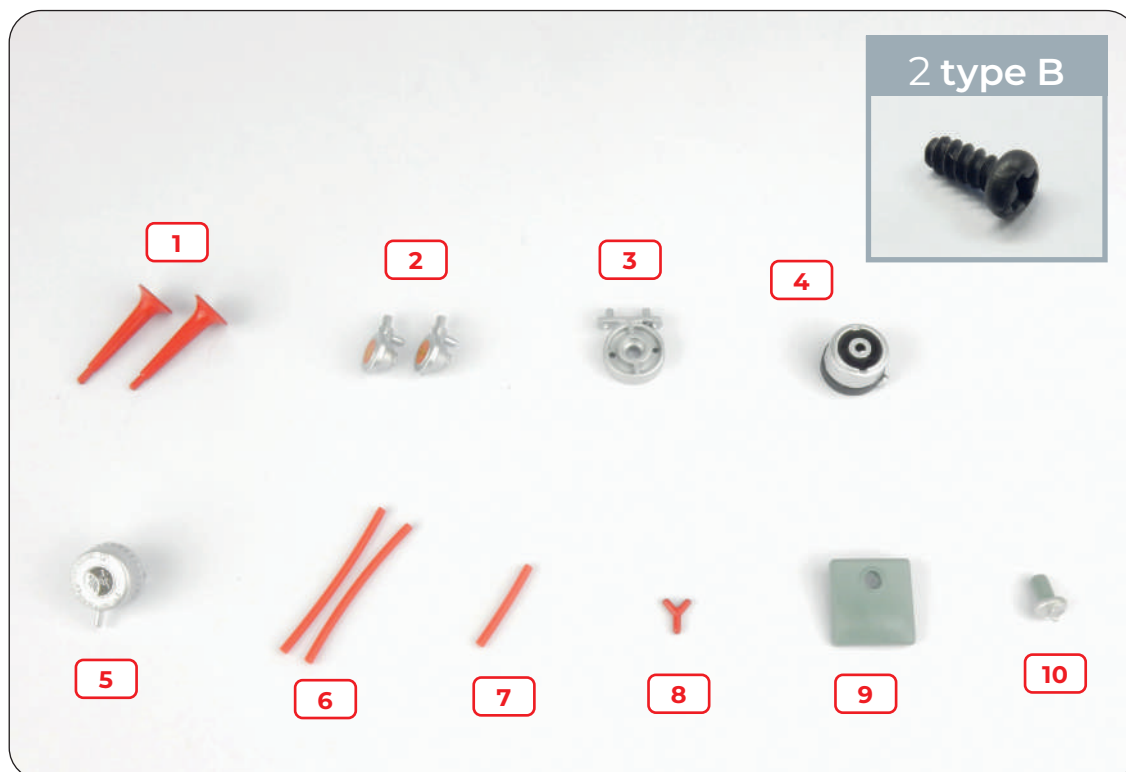

Stage 67: The Car Horn System

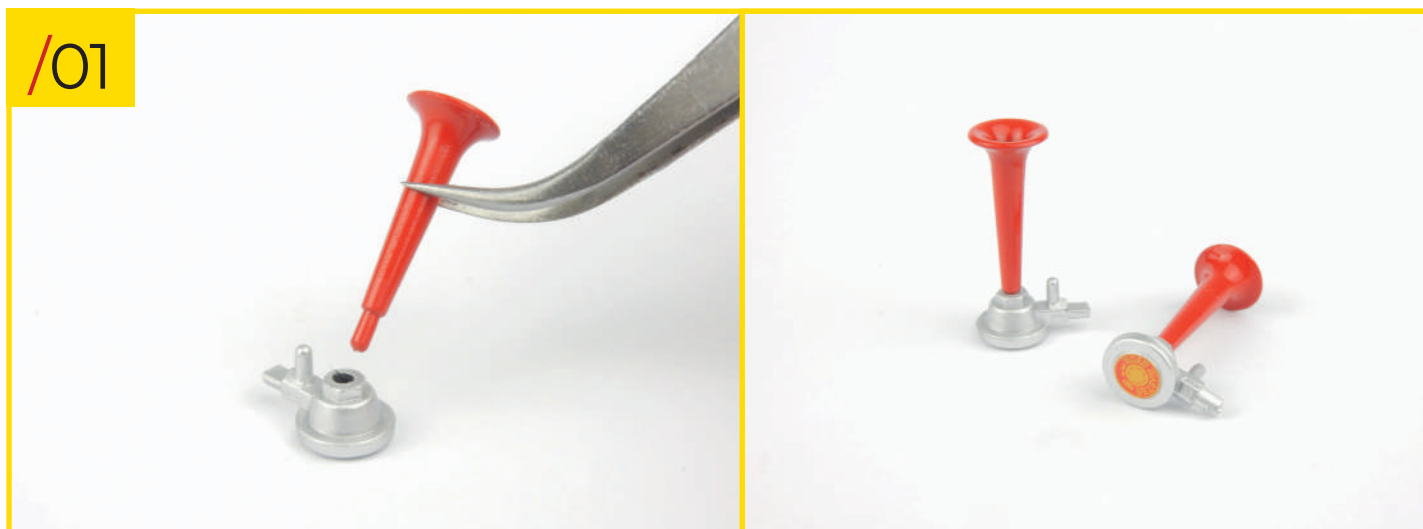

67/01 Fit the two horns to their caps by inserting the stud on the horns into the hole in the caps.



67/02 Slide the long tubes and the short tube onto the Y connector, orientating the pieces as shown.



67/03 Insert the studs on the horn caps into the other ends of the long tubes.

Stage 67: The Car Horn System



67/04 Retrieve your model's chassis and install the two horn assemblies to the internal face of the front right inner wing.

67/05 Fit the bracket to the compressor body, orientating the pieces as shown.



67/06 Secure the pieces together using a type B screw.



67/07 Now fit the compressor cover to the bracket, orientating the pieces as shown.



Stage 67: The Car Horn System

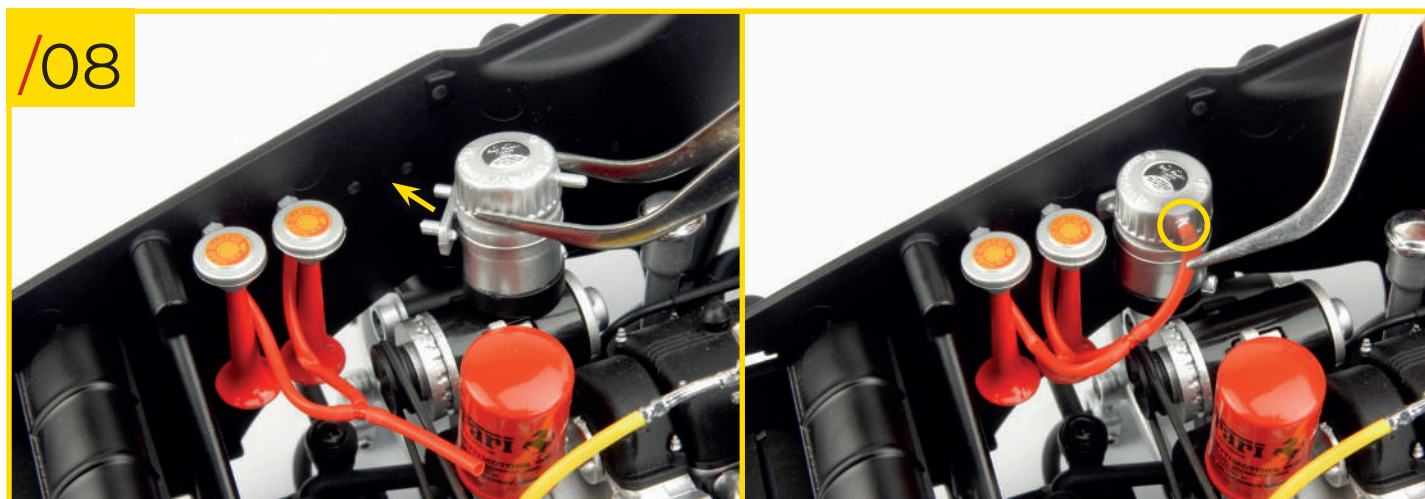

67/08 Fit the compressor to the internal face of the front right splash guard, close to the horns, and slide the free end of the short tube onto the stud on the compressor cover.



STAGE 67 IS COMPLETE
Here's how the car horn system looks after it's been correctly fitted to the chassis. Keep the parts you haven't used in a safe place, you'll need them for a later stage.

Stage 68: The Rear Section of the Body

In this stage you'll finish assembling some of the components you received in previous stages. Put the rear section of the body somewhere safe, you'll need it for a later stage.



STAGE 68 PARTS LIST

Name
1 Rear section of the body



Stage 68: The Rear Section of the Body



68/01 Retrieve the windscreen washer fluid reservoir and its cap that you received with stage 67. Fit the pieces together, orientating them as shown.



68/02 Retrieve your model's chassis and fit the reservoir to the internal face of the front left inner wing, as shown.

Stage 68: The Rear Section of the Body

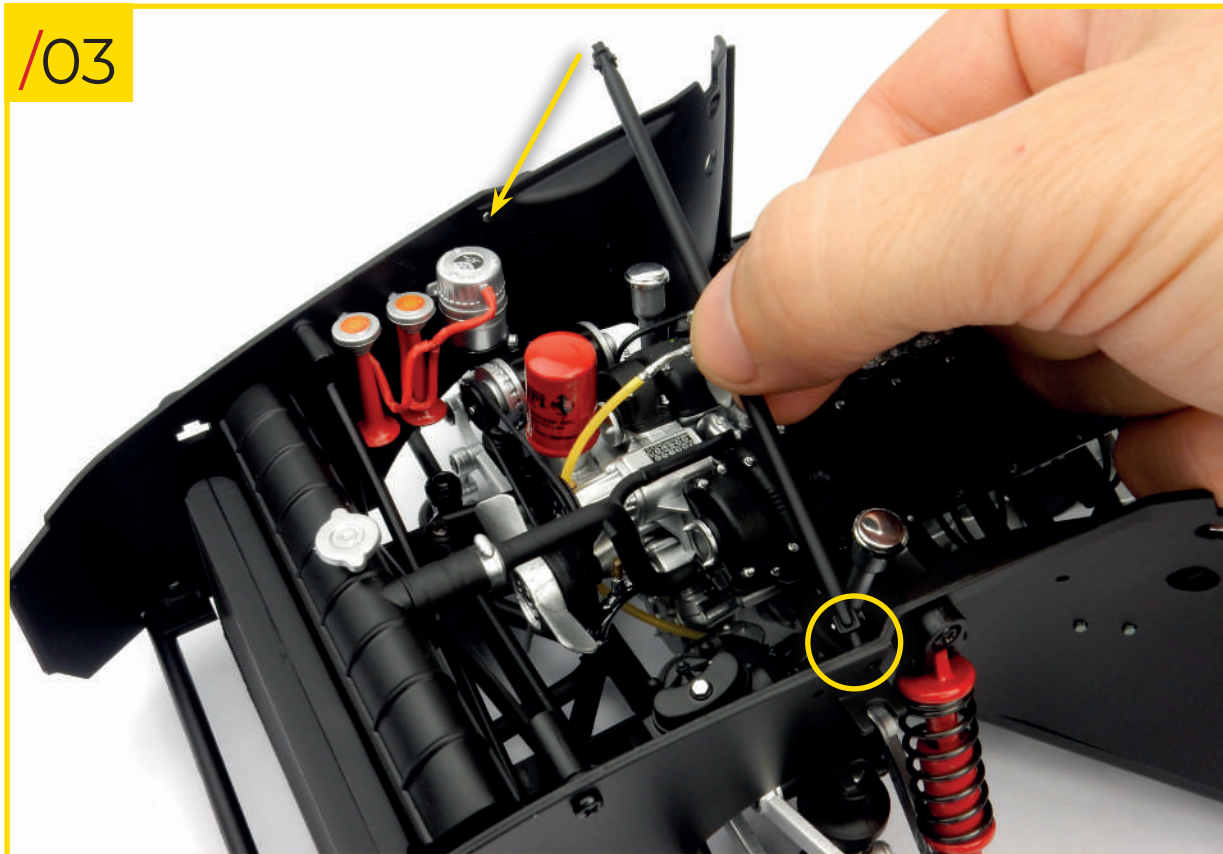

68/03 To finish, insert the two ends of the rod you received with stage 65 into the holes available in the two front inner wings, as shown in the photo.

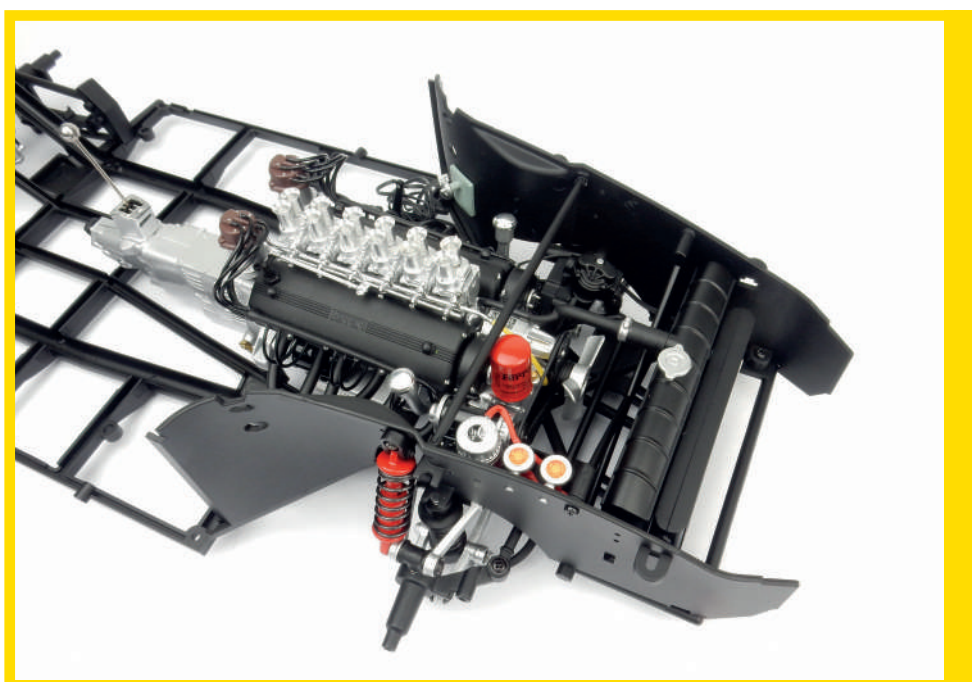

STAGE 68 IS COMPLETE
Here's how the front section of your model's chassis looks at the end of this stage.

Stage 69: The Rear Left Wheel (1)

In this stage you'll start assembling your model's rear left wheel. You'll continue assembling it over the coming stages.



STAGE 69 PARTS LIST

Name	Name
1 Inner wheel rim	5 Type C hub
2 Spoke retainer ring 1	6 Type A spokes
3 Type B hub	7 Type B spokes
4 Type A hub	

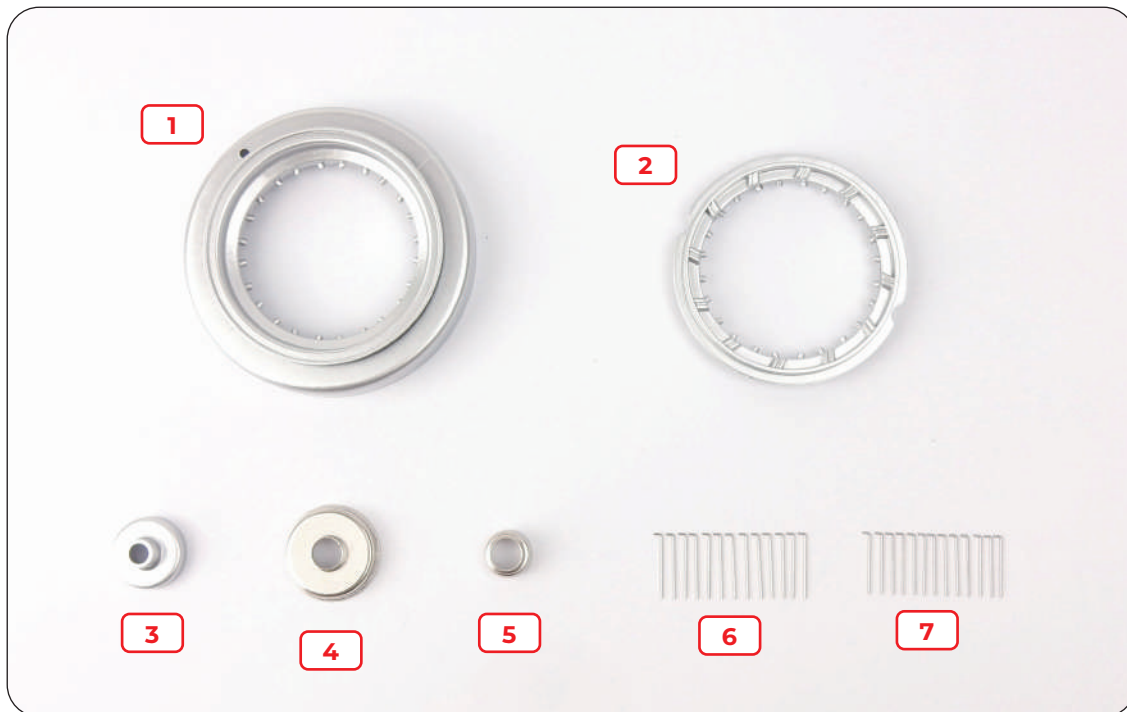

Stage 69: The Rear Left Wheel (1)

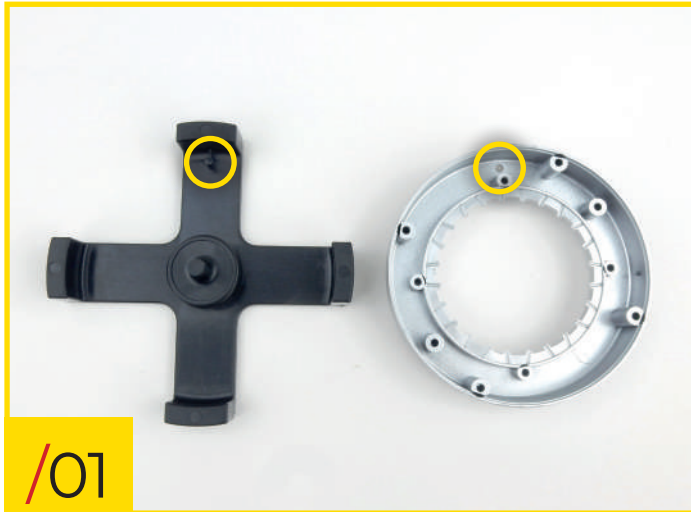

69/01 Place the assembly jig you received in stage 21 on your work surface, together with the wheel rim supplied with this stage. The jig has a small fixing stud on it, this should be inserted into the corresponding hole in the rim.

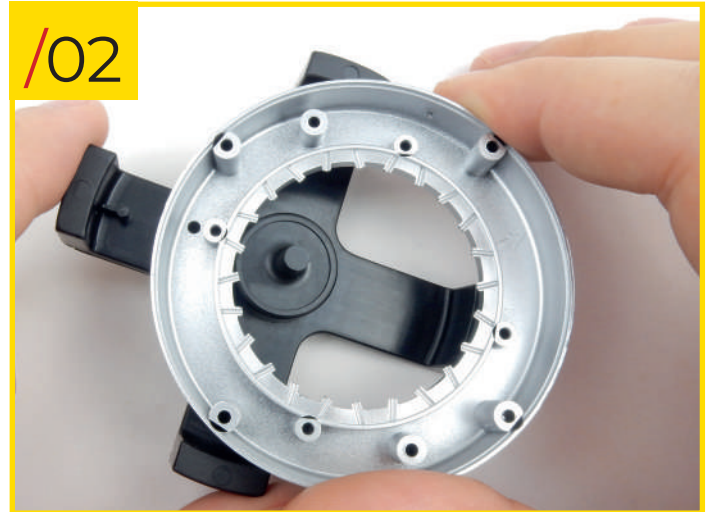

69/02 Insert the stud into the hole to fix the rim onto the assembly jig. Before proceeding with the assembly, we recommend that you stick a small piece of double-sided sticky tape to the jig's central stud - this will help to hold the hubs in place.

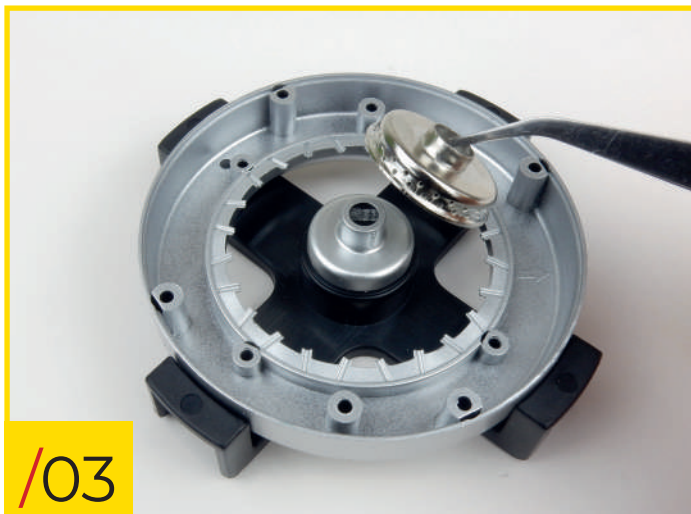

69/03 Place the type B hub onto the jig's central stud; once in place, put the type A hub on top of it, as shown in the photo.



69/04 Before adding the spokes, we recommend that you stick some small strips of double-sided sticky tape to the internal edge of the rim. This will help to hold the spokes in place during the assembly. Alternatively, you can dab a bead of glue onto each spoke once they are in position.

Stage 69: The Rear Left Wheel (1)



/05

69/05 Position the type B spokes (they are shorter than the type A ones) by inserting their hooked end into the lower row of holes in the type A hub. Place the straight end of the spokes onto the corresponding notch on the edge of the rim (on the double-sided sticky tape). Always leave an empty hole between each spoke.

69/06 Look at the photo to check that you've correctly installed the type B spokes.

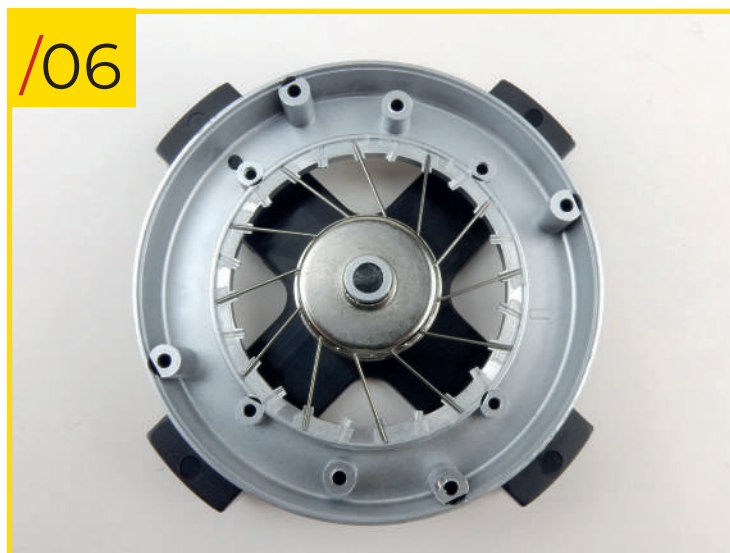

/06



/07

69/07 Now position the type A spokes (they are longer than the type B ones) by inserting their hooked end into the upper row of holes immediately to the left of the type B spokes, making sure they pass over the spokes inserted into the lower row of holes. Use the photo to help identify which notch you should position the other end of the spoke on. Leave an empty hole between each spoke as before.

Stage 69: The Rear Left Wheel (1)

/08

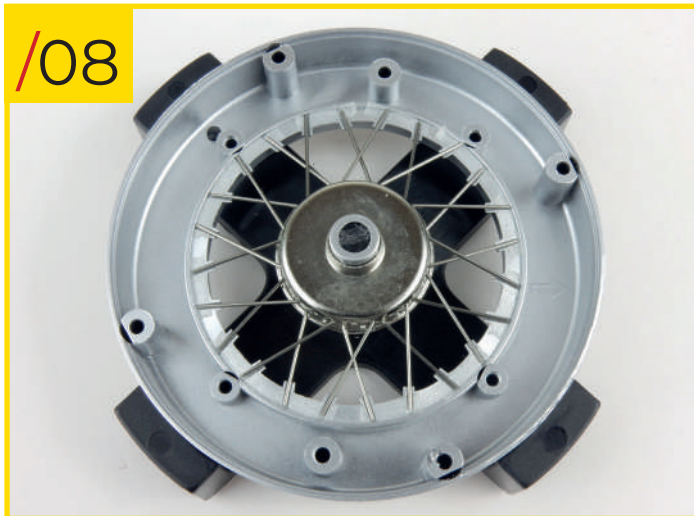

69/08 Look at the photo to check that you've installed all the spokes correctly.

/09

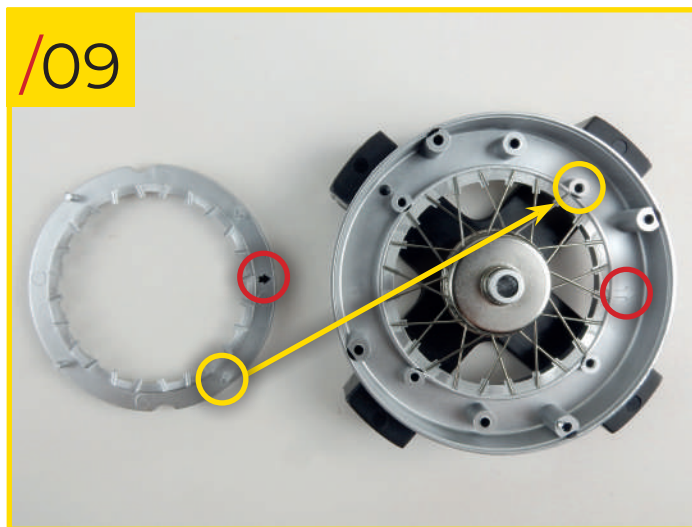

69/09 Finally, fit the spoke retainer ring 1 onto the internal edge of the rim. Use the photo and the arrows printed on the pieces to fit them together correctly.

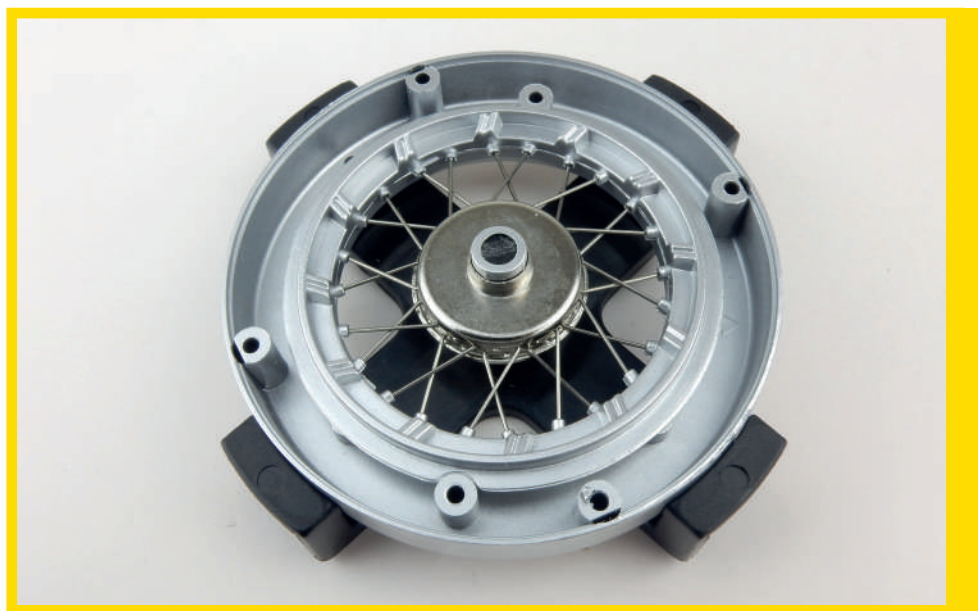

STAGE 69 IS COMPLETE
Here's how the rear left wheel looks at the end of this stage.

Stage 70: The Rear Left Wheel (2)

In this stage you'll continue assembling your model's rear left wheel.



STAGE 70 PARTS LIST

Name	Name
1 Spoke retainer ring 2	3 type B screws
2 Type A spokes	

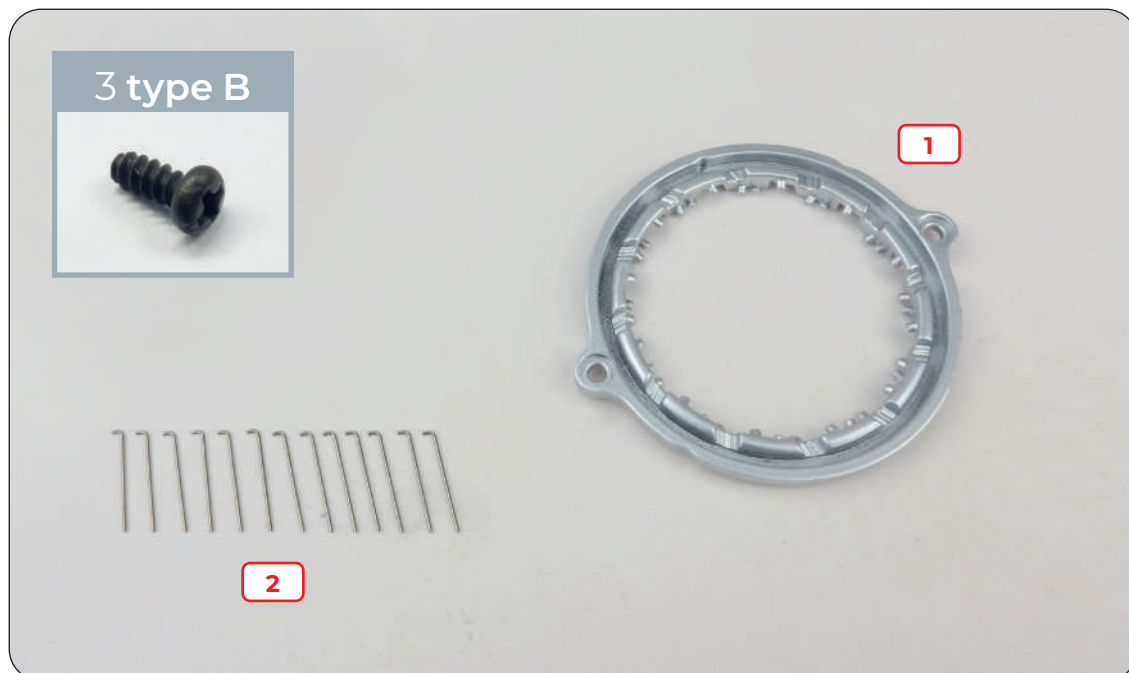

Stage 70: The Rear Left Wheel (2)

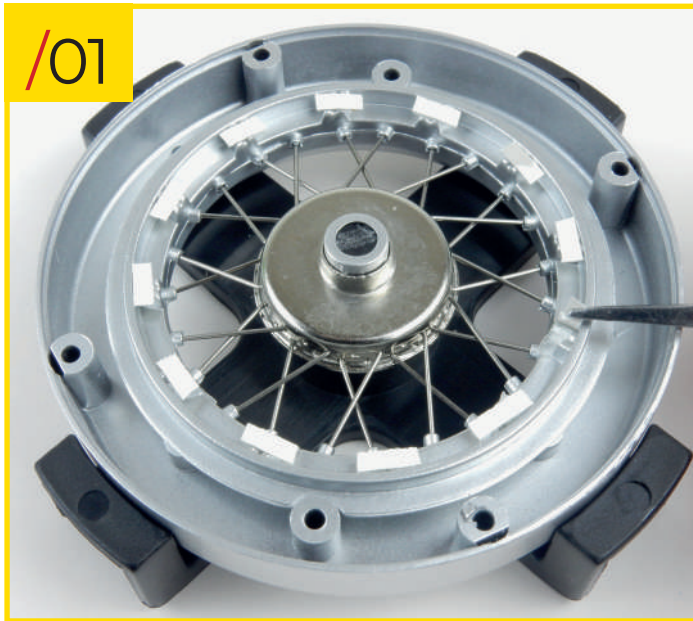

70/01 Place the rear left wheel that you assembled in stage 69 on your work surface. Before proceeding, we recommend that you stick small strips of double-sided sticky tape to the side edge of the spoke retainer ring 1. Alternatively, you can lay all the spokes in position and then dab a bead of glue on each one after stage 70/03.

70/02 Insert the hooked end of the type A spokes you received with this stage into the holes remaining in the lower row on the hub. Place the straight end of the spokes onto the corresponding notch on the edge of the spoke retainer ring 1. Use the photo to help orientate the spokes correctly.

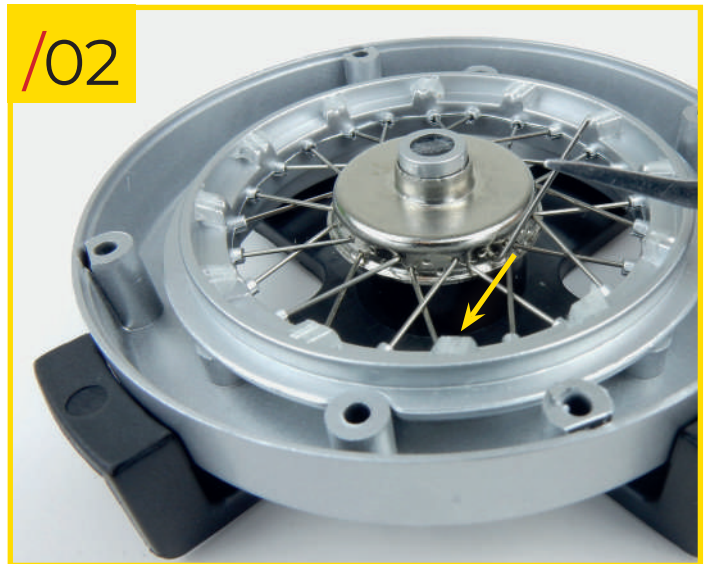

70/03 Look at the photo to check that you've correctly installed the type A spokes.

Stage 70: The Rear Left Wheel (2)

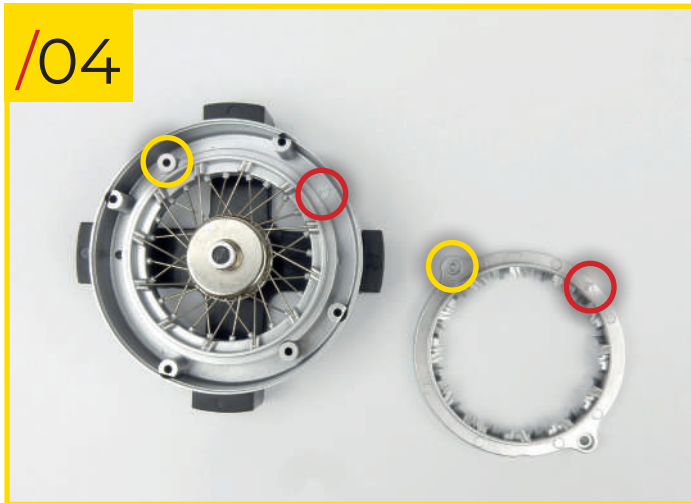

70/04 Add the spoke retainer ring 2 to the rest of the assembly. Use the photo to help fit it correctly.

70/05 Secure the pieces together using two type B screws.

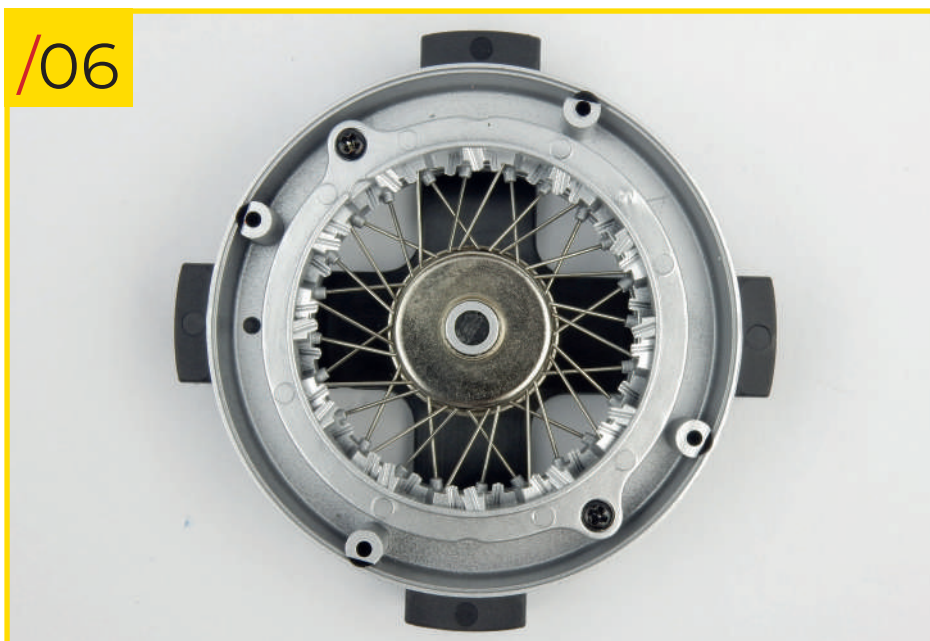

70/06 Look at the photo to check that you've installed all the components correctly.

Stage 70: The Rear Left Wheel (2)



STAGE 70 IS COMPLETE
The rear left wheel is
almost finished.

Stage 71: The Rear Left Wheel (3)

In this stage you'll continue assembling your model's rear left wheel. You will then complete it in the following stage.



STAGE 71 PARTS LIST

Name	Name
1 Outer wheel rim	7 type B screws
2 Sealing ring	
3 Washer	
4 Type A spokes	
5 Type C spokes	

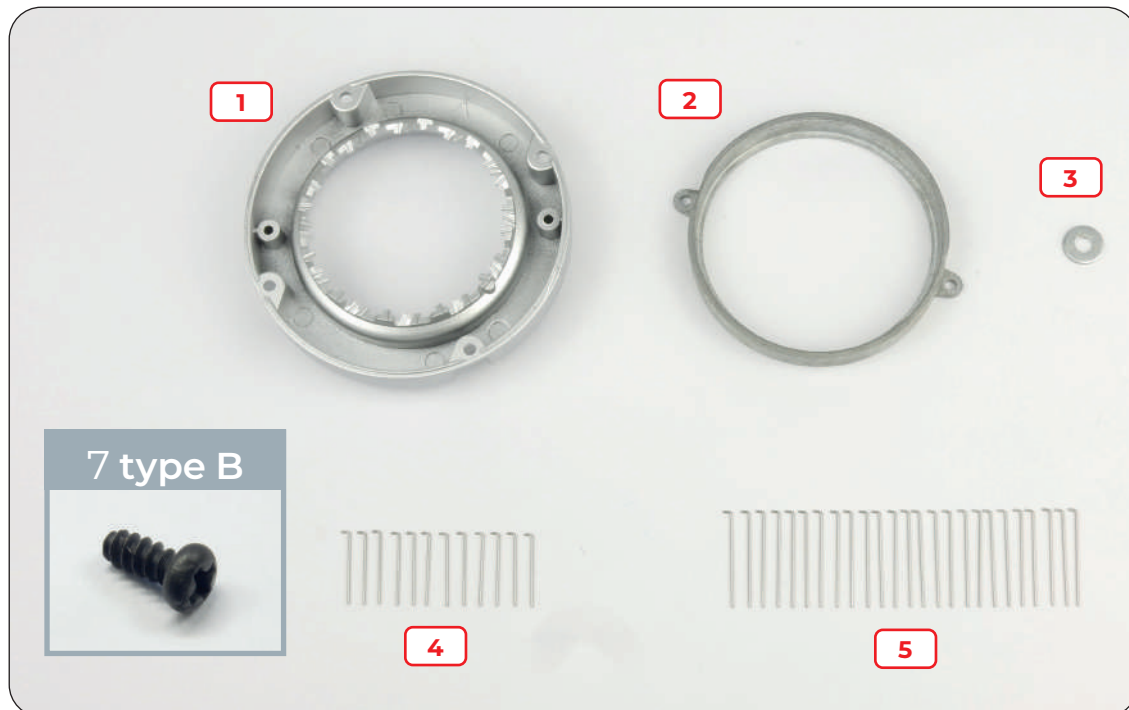

Stage 71: The Rear Left Wheel (3)

/01



71/01 Place the rear left wheel that you assembled in the previous stages on your work surface. Before proceeding with the assembly, we recommend that you stick small strips of double-sided sticky tape to the side edge of the spoke retainer ring 2. Alternatively, you can add a bead of glue to the spokes once they are in position.

/02



71/02 Insert the hooked end of the type A spokes you received with this stage into the remaining holes in the type A hub. Use the photo to help orientate the spokes correctly and to put their straight end on the corresponding notch on the top level of the retainer ring.



/03

71/03 Once all the type A spokes have been added, position the type C hub that you received with stage 69 as shown in the photo.

/04



71/04 Insert the hooked end of one type C spoke into one of the holes in the lower row on the type C hub.

Stage 71: The Rear Left Wheel (3)



71/05 Place the straight end of the spoke on the notch on the lower level of the retainer ring as shown in the photo. Repeat these steps for the other eleven type C spokes, until all the holes in the lower row on the hub have been filled.



71/06 Now insert the hooked end of one type C spoke into one of the holes in the top row on the type C hub.



71/07 Place the straight end of the spoke onto the corresponding notch on the top level of the housing. Repeat these steps for the other eleven type C spokes, until all the holes in the top row on the hub have been filled.

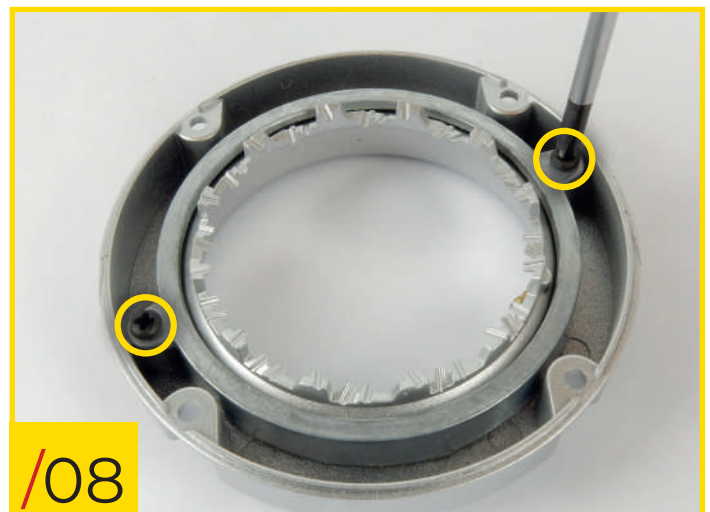

71/08 Fix the sealing ring to the inner edge of the outer wheel rim. Orientate the pieces as shown and secure them together using two type B screws.

Stage 71: The Rear Left Wheel (3)

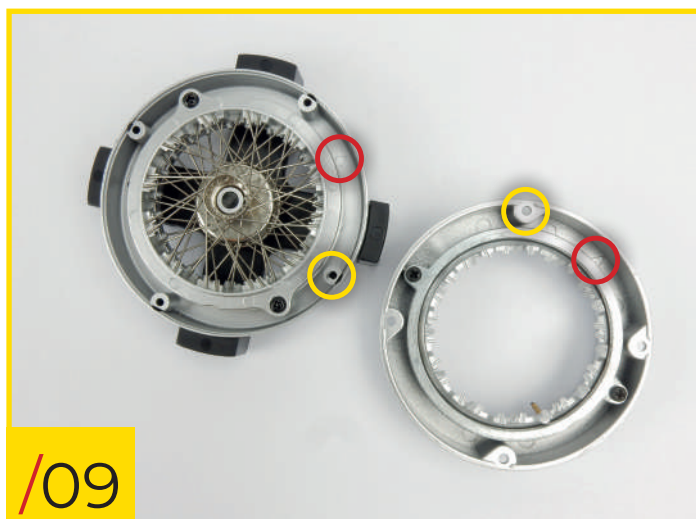

71/09 Fit the outer wheel rim to the rest of the wheel. To line up the fixing holes, match up the arrows circled in red.

71/10 Secure the rim to the rest of the wheel using four type B screws.



STAGE 71 IS COMPLETE
Here's how your model's rear left wheel looks at the end of this assembly stage. As always, keep it somewhere safe together with the other pieces.

Stage 72: The Rear Left Wheel (4)

In this stage you'll finish assembling the rear left wheel by adding the tyre.



STAGE 72 PARTS LIST

Name
1 Tyre



Stage 72: The Rear Left Wheel (4)

/01



72/01 Place the rear left wheel assembly and the washer you received with stage 71 on your work surface. Remove the protective film from one of the sides of the washer, as shown in the round photo.

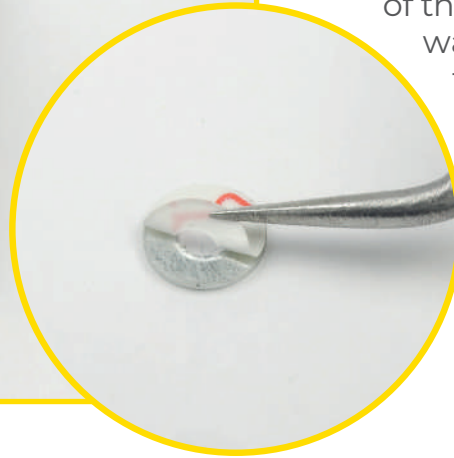

72/02 With the side of the washer that had the film removed facing downwards, insert it into the type C hub, as shown in the photo.

/02



/03



72/03 Look at the photo to check that you've positioned the washer correctly.

Stage 72: The Rear Left Wheel (4)



72/04 Before adding the tyre to the rest of the wheel, we recommend that you warm it up slightly (using a hair dryer, for example) to make it more malleable.

72/05 Check to make sure that the tyre is malleable enough.



72/06 Slip the tyre onto the rim of the rear left wheel.

Stage 72: The Rear Left Wheel (4)



STAGE 72 IS COMPLETE
You have now finished
assembling your model's
rear left wheel. Keep it
somewhere safe together
with the other pieces.